

STEP 1

1. PREPARE THE FOUNDATION AND PLACE THE FOUNDATION MAT.
2. INSTALL THE FOUNDATION BACKING MAT AND FILTER FABRIC.
3. PLACE AND COMPACT BACKFILL TO 24" DEPTH AS SHOWN.
4. HOOK CAP MAT ON TRANSVERSE WIRE OF FOUNDATION MAT AND LAY IT DOWN ONTO THE BACKFILL.

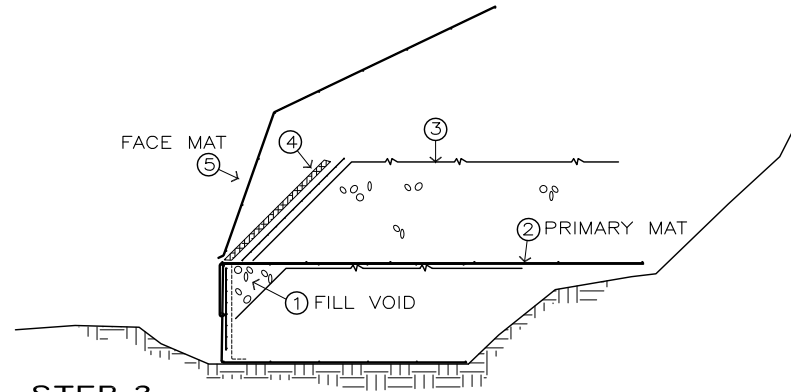

STEP 2

1. FILL THE VOID BELOW THE FRONT OF THE CAP AND ROD TO FULLY COMPACT.
2. PLACE FIRST PRIMARY MAT ON FOUNDATION CAP MAT.
3. PLACE BACKFILL AND COMPACT TO 25.75" DEPTH.
4. PLACE BACKING MAT AND EROSION MAT OR SOD.
5. HOOK FACE MAT ON TRANSVERSE WIRES OF PRIMARY MAT AND THE FOUNDATION MAT AND LAY IT DOWN ONTO THE BACKFILL.

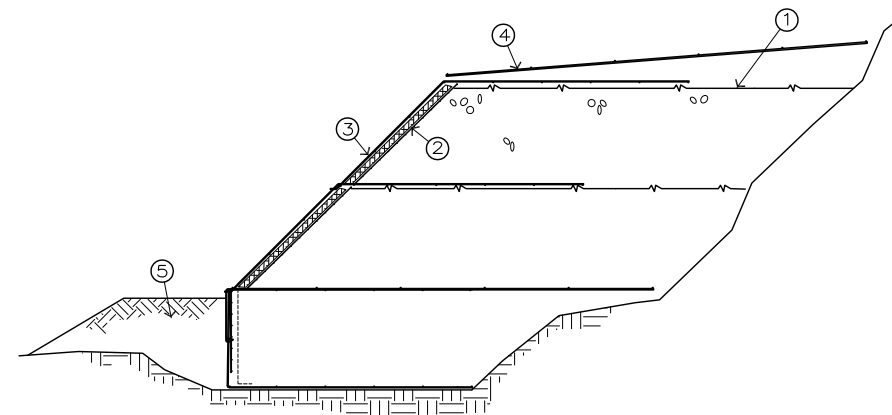

STEP 3

1. PLACE AND COMPACT SECOND 25.75" LIFT OF BACKFILL.
2. PLACE BACKING MAT AND EROSION MAT OR SOD.
3. ROTATE AND INSTALL FACE MAT AS IN STEP 4 ABOVE.
4. PLACE PRIMARY MAT WITH TRANSVERSE WIRE ALIGNED WITH THE TRANSVERSE WIRE OF THE LOWER FACE MAT THAT WILL BE HOOKED WITH THE NEXT FACE MAT.
5. BACKFILL AND COMPACT SOIL AT TOE OF WALL.

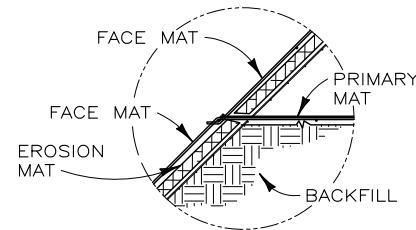

STEP 4

1. PLACE THE NEXT LIFT OF BACKFILL, BACKING MAT AND EROSION MAT OR SOD.
2. INSTALL THE FACE MAT SO IT ENGAGES BOTH THE PRIMARY MAT AND THE LOWER FACE MAT.
3. CONTINUE LIFTS TO THE TOP OF THE WALL.
4. AFTER PLACING THE TOP LIFT OF BACKFILL AND FACE MAT, BACKING MAT AND EROSION MAT, PLACE THE PRIMARY MAT AND HOOK IT TO THE FACE MAT WITH HOG RINGS. BACKFILL AND COMPACT THE REQUIRED COVER OVER THE PRIMARY MAT.

CONSTRUCTION SEQUENCE
NOT TO SCALE

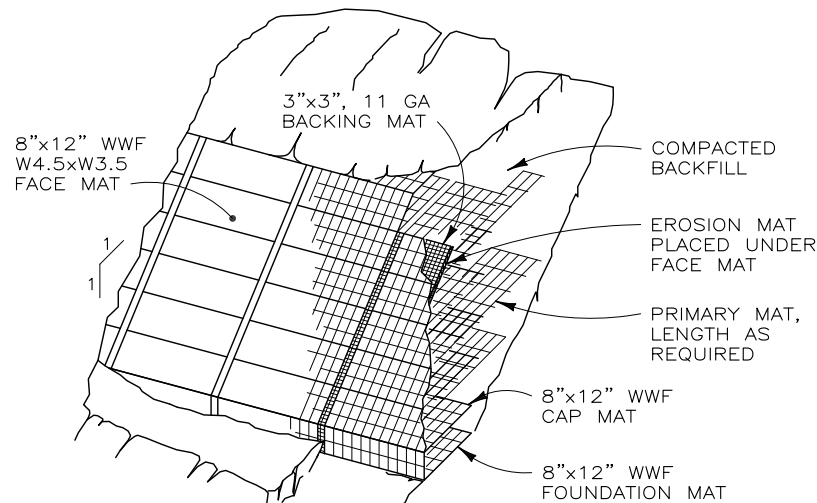

PICTORIAL ELEVATION
NOT TO SCALE

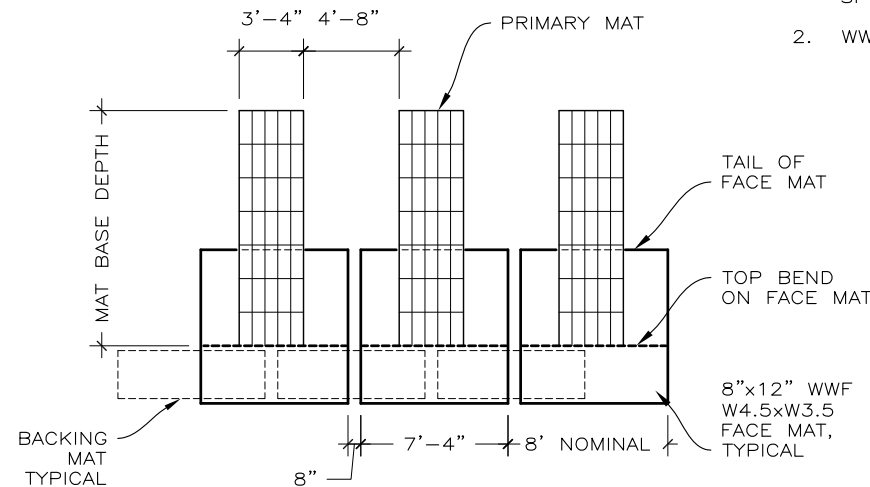

ASSEMBLED MATS
NOT TO SCALE

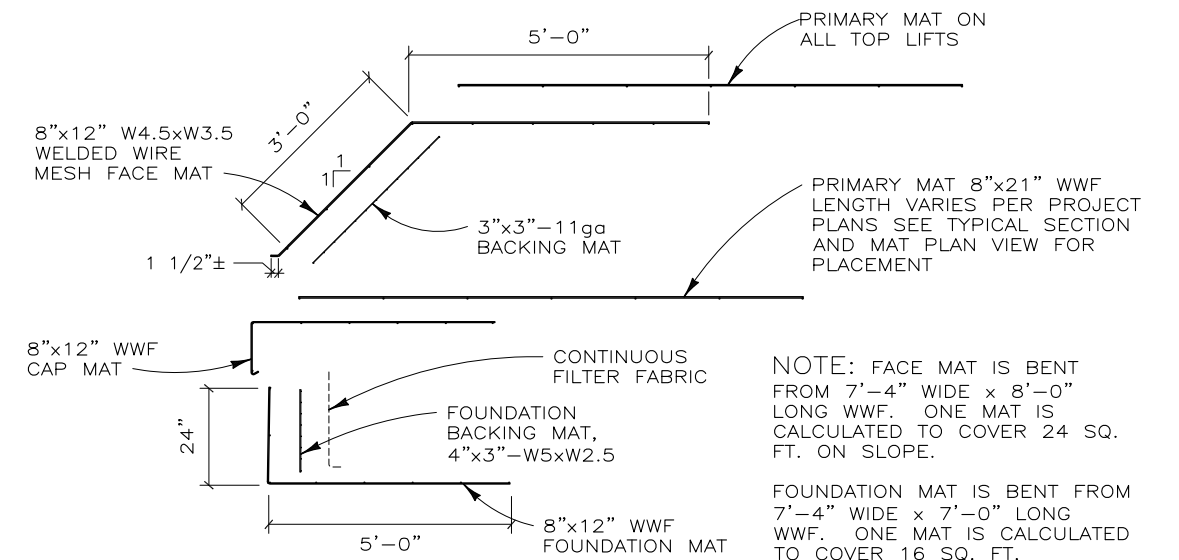

WALL COMPONENTS
NOT TO SCALE

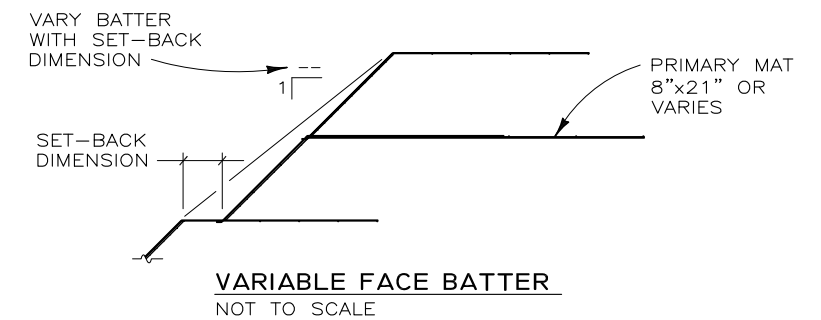

NOTES:

1. THESE DETAILS ARE INTENDED FOR INFORMATION ONLY. THEY MAY OR MAY NOT APPLY TO SPECIFIC PROJECTS.
2. WWF = WELDED WIRE FABRIC

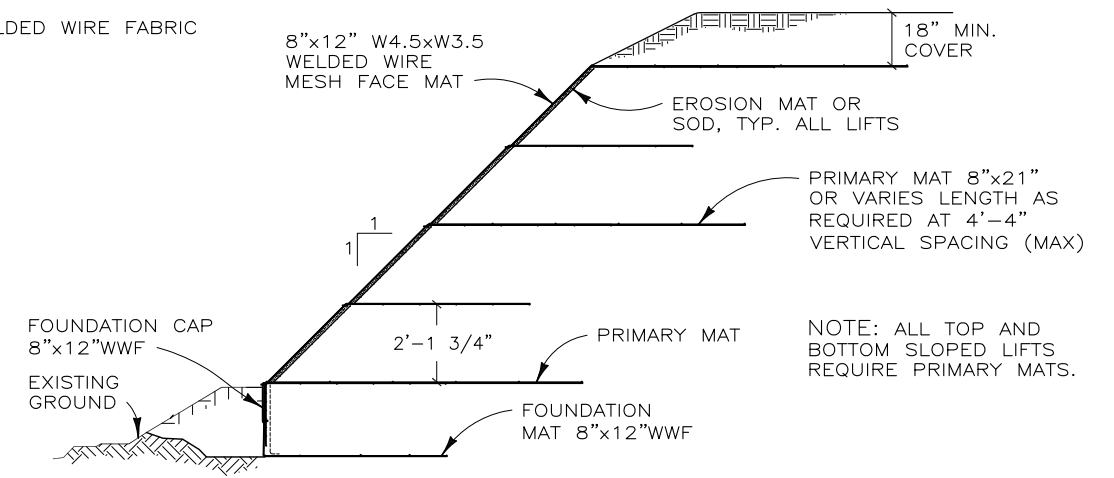

TYPICAL SECTION
NOT TO SCALE

STANDARD DRAWINGS\STEEPENED SLOPE

THIS DRAWING IS FURNISHED SOLELY FOR THE USE OF OR IN CONNECTION WITH THIS PROJECT AND THE PROPRIETARY INFORMATION SHOWN HEREON IS NOT TO BE TRANSMITTED TO ANY OTHER ORGANIZATION WITHOUT SPECIFIC AUTHORIZATION BY THE HILFIKER COMPANY. HILFIKER RETAINING WALLS ARE PROTECTED BY ONE OR MORE OF THE FOLLOWING PATENTS: 243,613; 243,697; 288,616; 4,117,686; 4,329,089; 4,324,508; 4,391,557; 4,505,621; 4,343,318; 4,661,023; 4,856,939; 4,929,125; 5,076,735; 5,647,695; 5,722,799; 5,733,072; 6,357,970B1; 6,874,975B2; 7,033,118B2; AND OTHERS. OTHER PATENTS PENDING (2008)

REV. NO.	DATE	BY	DESCRIPTION
6	11 SEP 07	AMJ	MINOR REVISIONS, UPDATED BORDER
7	24 APR 09	AMJ	MINOR REVISIONS, ADDED DETAIL
8	8 FEB 12	AMJ	REVISED CONSTRUCTION SEQUENCE

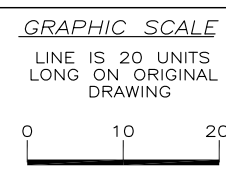

PROJ. MGR.
ENGINEER
CADD BY
HRW

HILFIKER RETAINING WALLS

1902 Hilfiker Lane
Eureka, CA 95503-5711
TOLL-FREE 800.762.8962
PH 707.443.5093 FAX 707.443.2891
WEBSITE www.hilfiker.com E-MAIL info@hilfiker.com

SINCE 1902
QUALITY PRODUCTS

DWG DATE
24 JUL 95

REVISION DATE
8 FEB 12

SCALE
NOTED

STANDARD DRAWING	PROJECT NO. --
STEEPENED SLOPE	SHEET 1
STANDARD DETAILS	OF 1