

CAD: \\EUREKA\PROJECTS\2015\015060-SH-55\DWGS\015060-900-GOOSE-CREEK-R3.DWG
(HRW 150119 BW)

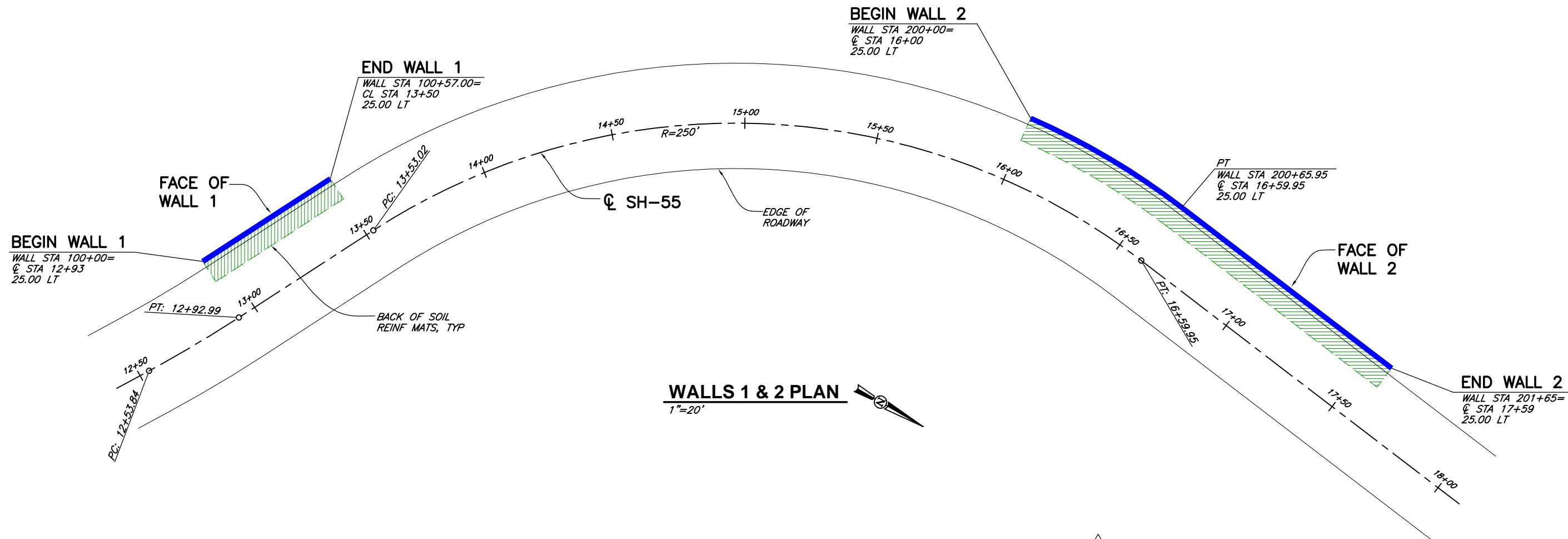

WALLS 1 & 2 PLAN
1"=20'

DESIGN NOTES

- DESIGN IS BASED ON THE ASSUMPTION THAT BACKFILL WITHIN THE REINFORCED SOIL MASS, METHODS OF CONSTRUCTION, AND QUALITY OF MATERIALS CONFORM TO THE REQUIREMENTS OF HILFIKER RETAINING WALLS.
- ASSUMED SOIL CHARACTERISTICS:
 WALL BACKFILL:
 UNIT WEIGHT: 125 PCF
 INTERNAL FRICTION ANGLE: 34°
 COHESION: 0 PSF
 RETAINED SOILS:
 UNIT WEIGHT: 125 PCF
 INTERNAL FRICTION ANGLE: 30°
 COHESION: 0 PSF
 COEFFICIENT OF ACTIVE SOIL PRESSURE: 0.333
 FOUNDATION SOILS:
 FRICTION ANGLE FOR SLIDING: 30°
 COHESION: 0 PSF
 MAXIMUM APPLIED BEARING PRESSURE:
 6.3 KSF (FACTORED, STATIC)
 8.3 KSF (FACTORED, SEISMIC)
 4.4 KSF (UNFACTORED, STATIC)
 7.8 KSF (UNFACTORED, SEISMIC)
 IF ACTUAL CHARACTERISTICS, GRADES, DIMENSIONS, OR SOIL MATERIALS DIFFER FROM THOSE LISTED ABOVE OR SHOWN ON THE PLANS HILFIKER RETAINING WALLS SHALL BE NOTIFIED IN ORDER TO EVALUATE THE NEED TO REDESIGN.
- THE DESIGN REQUIRES A NON-SATURATED BACKFILL SURFACE AND SUB-SURFACE DRAINAGE CONTROL MAY BE REQUIRED TO PREVENT SATURATION OF THE BACKFILL OR TO RELIEVE HYDROSTATIC PRESSURES.
 DRAINAGE CONTROL SHALL BE AS SPECIFIED IN THE PROJECT PLANS AND SPECIFICATIONS OR AS DIRECTED BY THE OWNER'S ENGINEER. PAYMENT FOR DRAINAGE SHALL BE AS SPECIFIED IN THE PROJECT SPECIFICATIONS.
- IF THE WALL BACKFILL CONTAINS MORE THAN 50% BY WEIGHT SANDS AND FINES (PASSING THE NO. 4 SIEVE), GRAVEL OR OTHER METHODS APPROVED BY THE HILFIKER COMPANY SHALL BE USED TO CONTAIN THE BACKFILL AT THE FACE OF THE WALL.
- REFERENCE DOCUMENTS:
 ELECTRONIC FILES IN .DGN & PDF FORMAT, PREPARED BY IDAHO DEPARTMENT OF TRANSPORTATION, DRAWINGS DATED SEPTEMBER, 2014.

WALL QUANTITIES

BASE DEPTH	CAP MAT W4.5xW3.5	PRONGLESS MAT W4.5xW3.5	STANDARD MAT W7xW4
24'-6"	-	-	32
24'-0"	3	3	-
22'-9"	-	-	50
22'-0"	5	5	-
21'-0"	-	-	27
20'-0"	3	3	-
14'-0"	11	11	87
12'-3"	-	-	194
12'-0"	31	31	-
10'-6"	-	-	104
10'-0"	21	21	-
9'-0"	115	115	-
8'-9"	-	-	253
WALL FACE SUPPLIED		14,976 SQ FT	
MSE BACKFILL (BY OTHERS)		*6,757 CU YD	
BACKING MATS 2' HIGH		958 EA	
HARDWARE CLOTH 2'-2" HIGH		77 ROLLS	
HOG RINGS		22,500 EA	
PLIERS		7 EA	

* TOP MAT TO BOTTOM MAT, NEAT.



WELDED WIRE WALLS

HILFIKER RETAINING WALLS



1902 Hilfiker Lane
Eureka, CA 95503-5711
TOLL-FREE 800.762.8962
PH 707.443.5093 FAX 707.443.2891
WEBSITE www.hilfiker.com E-MAIL info@hilfiker.com



THE DESIGN CONTAINED ON THESE DRAWINGS IS BASED ON INFORMATION PROVIDED BY THE OWNER. ON THE BASIS OF THIS INFORMATION, THE HILFIKER COMPANY HAS DESIGNED, AND IS RESPONSIBLE FOR THE INTERNAL STABILITY OF THE STRUCTURE ONLY. EXTERNAL STABILITY, INCLUDING FOUNDATION AND SLOPE STABILITY, IS THE RESPONSIBILITY OF THE OWNER.

VERIFY SCALES
BAR IS ONE INCH ON ORIGINAL DRAWING
IF NOT ONE INCH ON THIS SHEET, ADJUST SCALES ACCORDINGLY

CONSULTING ENGINEERS & GEOLOGISTS, INC.
WWW.SHN-ENGR.COM
812 W. WABASH EUREKA, CA 95501
707-441-8855

SHN

NO.	DATE	BY	REVISION
4	05/13/15	K/JM	PLAN CHECK COMMENTS
3	06/11/15	K/JM	PLAN CHECK COMMENTS
2	07/29/15	K/JM	REVISED WALL 4

IDAHO DEPARTMENT OF TRANSPORTATION
SH-55 GOOSE CREEK GRADE
NEW MEADOWS, ADAMS COUNTY, IDAHO

WALLS 1 & 2 PLAN, QUANTITIES & NOTES

SHEET 1 OF 10
DATE 5/4/15
PROJ. NO. 015060

CAD: \\EUREKA\PROJECTS\2015\015060-SH-55\DWGS\015060-900-GOOSE-CREEK-R3.DWG
(HRW 150119 BW)

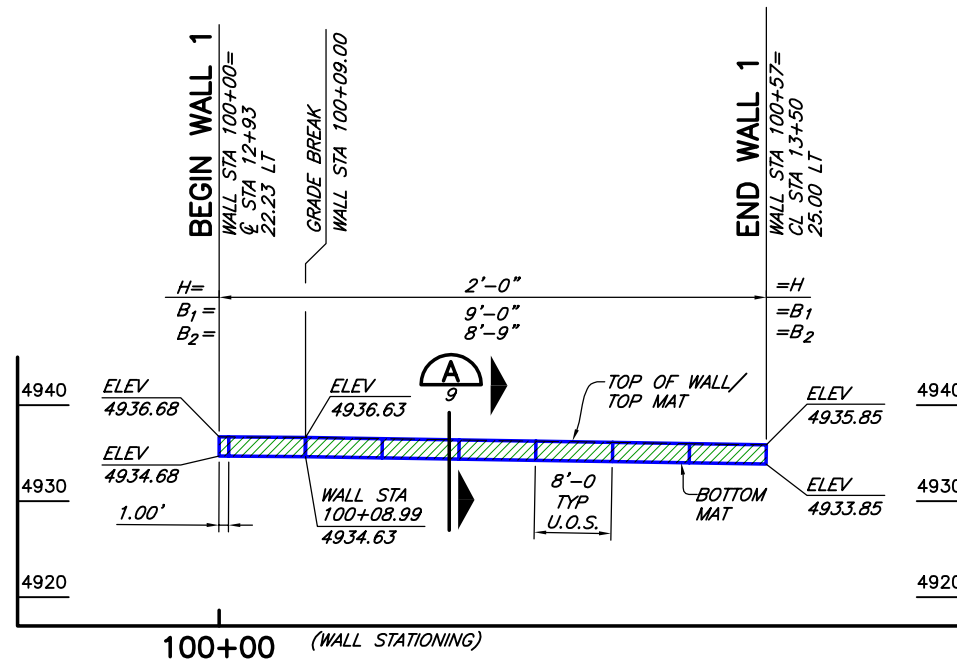

WALL 1
DEVELOPED ELEVATION (BACKFACE)

1"=10' HORIZ AND VERT
U.O.S.= UNLESS OTHERWISE STATED

WWR MAT LEGEND

- 8x12, W4.5xW3.5 WWR SOIL REINFORCING MATS
- 8x21, W7xW4 WWR SOIL REINFORCING MATS

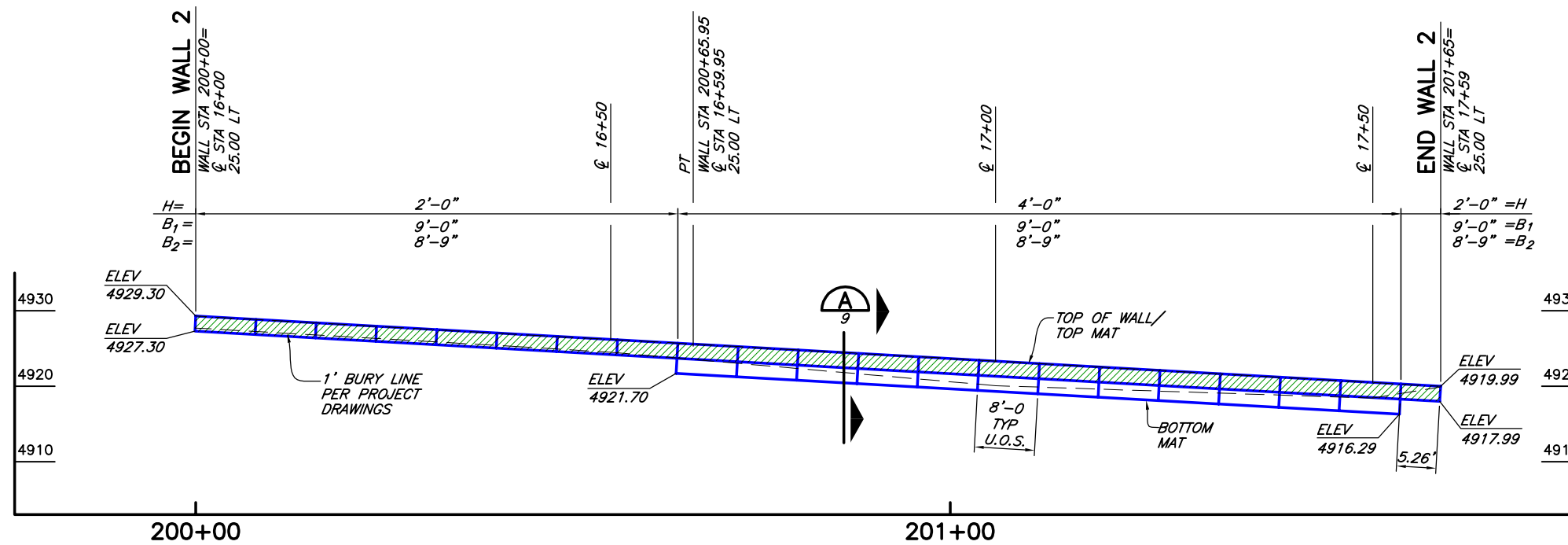

WALL 2
DEVELOPED ELEVATION (BACKFACE)

1"=10' HORIZ AND VERT
U.O.S.= UNLESS OTHERWISE STATED

WWR MAT LEGEND

- 8x12, W4.5xW3.5 WWR SOIL REINFORCING MATS
- 8x21, W7xW4 WWR SOIL REINFORCING MATS



WELDED WIRE WALLS

HILFIKER RETAINING WALLS



1902
SINCE 1902
1902
QUALITY PRODUCTS

1902 Hilfiker Lane
Eureka, CA 95503-5711
TOLL-FREE 800.762.8962
PH 707.443.5093 FAX 707.443.2891
WEB SITE www.hilfiker.com E-MAIL info@hilfiker.com

VERIFY SCALES
BAR IS ONE INCH ON ORIGINAL DRAWING
IF NOT ONE INCH ON THIS SHEET, ADJUST SCALES ACCORDINGLY

CONSULTING ENGINEERS & GEOLOGISTS, INC.
WWW.SHN-ENGR.COM
812 W. WABASH EUREKA, CA 95501
707-441-8855



DESIGN	JSO	DATE	06/11/15
DR	NMD	NO.	1
CHK	K/JN	PLAN CHECK COMMENTS	
APVD		REVISION	
BY			
K/JN			
IDaho DEPARTMENT OF TRANSPORTATION SH-55 GOOSE CREEK GRADE NEW MEADOWS, ADAMS COUNTY, IDAHO WALLS 1 & 2 ELEVATIONS			
SHEET		2 OF 10	
DATE		5/4/15	
PROJ. NO.		015060	

THE DESIGN CONTAINED ON THESE DRAWINGS IS BASED ON INFORMATION PROVIDED BY THE OWNER. ON THE BASIS OF THIS INFORMATION, THE HILFIKER COMPANY HAS DESIGNED, AND IS RESPONSIBLE FOR THE INTERNAL STABILITY OF THE STRUCTURE ONLY. EXTERNAL STABILITY, INCLUDING FOUNDATION AND SLOPE STABILITY, IS THE RESPONSIBILITY OF THE OWNER.

CAD: \\EUREKA\PROJECTS\2015\015060-SH-55\DWGS\015060-900-GOOSE-CREEK-R3.DWG
(HRW 150119 BW)

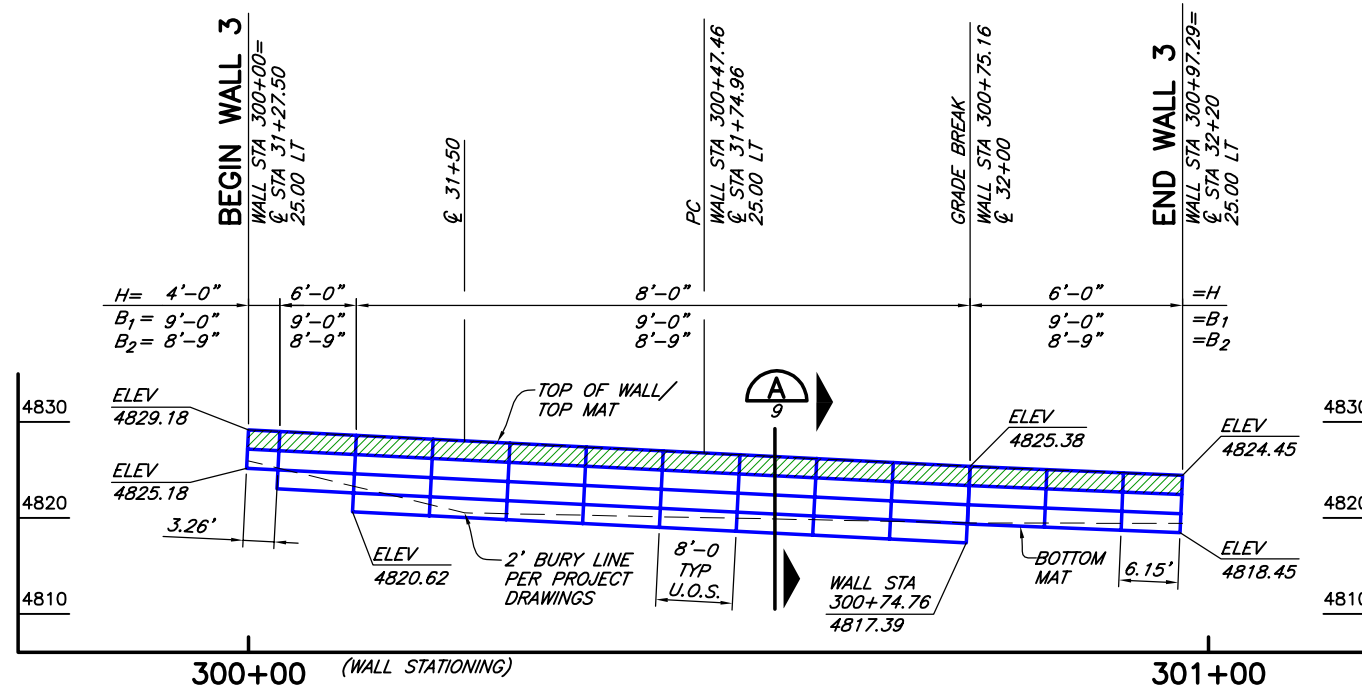
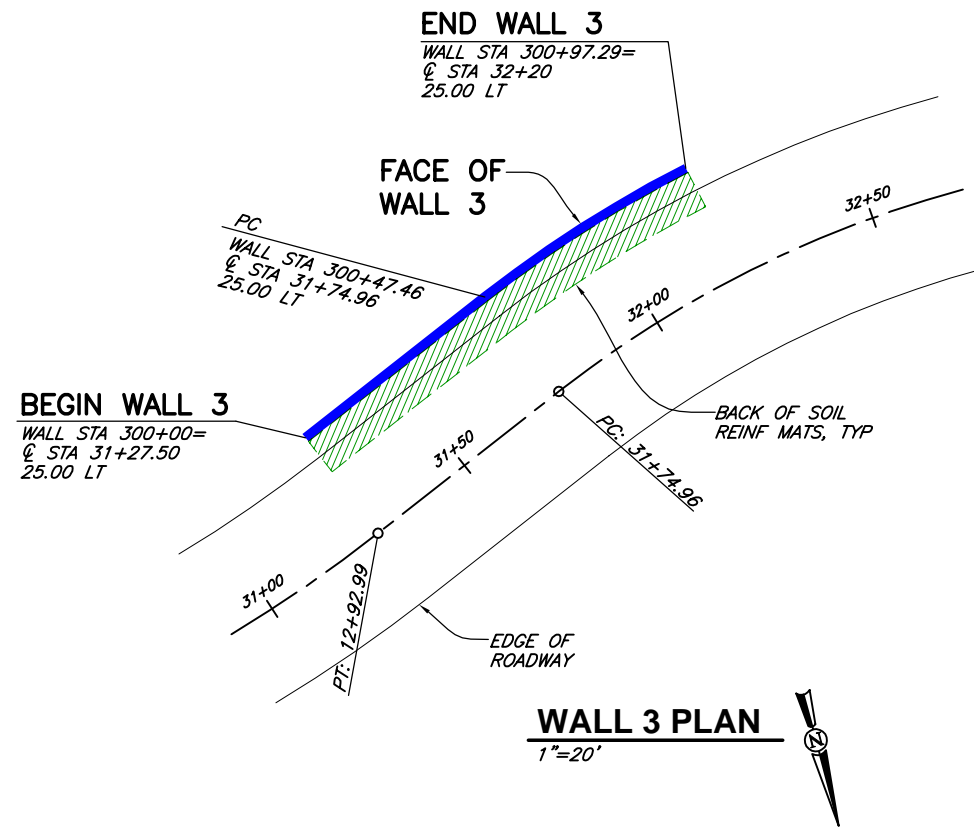

- WWR MAT LEGEND**
- 8x12, W4.5xW3.5 WWR SOIL REINFORCING MATS
 - 8x21, W7xW4 WWR SOIL REINFORCING MATS

THE DESIGN CONTAINED ON THESE DRAWINGS IS BASED ON INFORMATION PROVIDED BY THE OWNER. ON THE BASIS OF THIS INFORMATION, THE HILFIKER COMPANY HAS DESIGNED, AND IS RESPONSIBLE FOR THE INTERNAL STABILITY OF THE STRUCTURE ONLY. EXTERNAL STABILITY, INCLUDING FOUNDATION AND SLOPE STABILITY, IS THE RESPONSIBILITY OF THE OWNER.

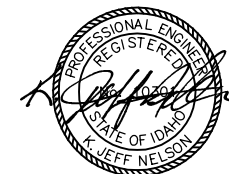

WELDED WIRE WALLS
HILFIKER RETAINING WALLS

1902 Hilfiker Lane
Eureka, CA 95503-5711
TOLL-FREE 800.762.8962
PH 707.443.5093 FAX 707.443.2891
WEBSITE www.hilfiker.com E-MAIL info@hilfiker.com

1902
SINCE 1902

VERIFY SCALES	BAR IS ONE INCH ON ORIGINAL DRAWING	IF NOT ONE INCH ON THIS SHEET, ADJUST SCALES ACCORDINGLY
CONSOLE ENGINEERS & GEOLOGISTS, INC.	WWW.SHN-ENGR.COM	812 W. WABASH EUREKA, CA 95501
SHN		
DSGN	JSD	BY
DR	MMD	DATE
CHK	K/JN	NO.
APVD		REVISION
IDAHO DEPARTMENT OF TRANSPORTATION SH-55 GOOSE CREEK GRADE NEW MEADOWS, ADAMS COUNTY, IDAHO		
WALL 3 PLAN & ELEVATION		
SHEET	3	OF 10
DATE	5/4/15	
PROJ. NO.	015060	

CAD: \\EUREKA\PROJECTS\2015\015060-SH-55\DWGS\015060-900-GOOSE-CREEK-R3.DWG
(HRW 150119 BW)

BEGIN WALL 4
WALL STA 400+00=
CL STA 33+35
23.00 LT

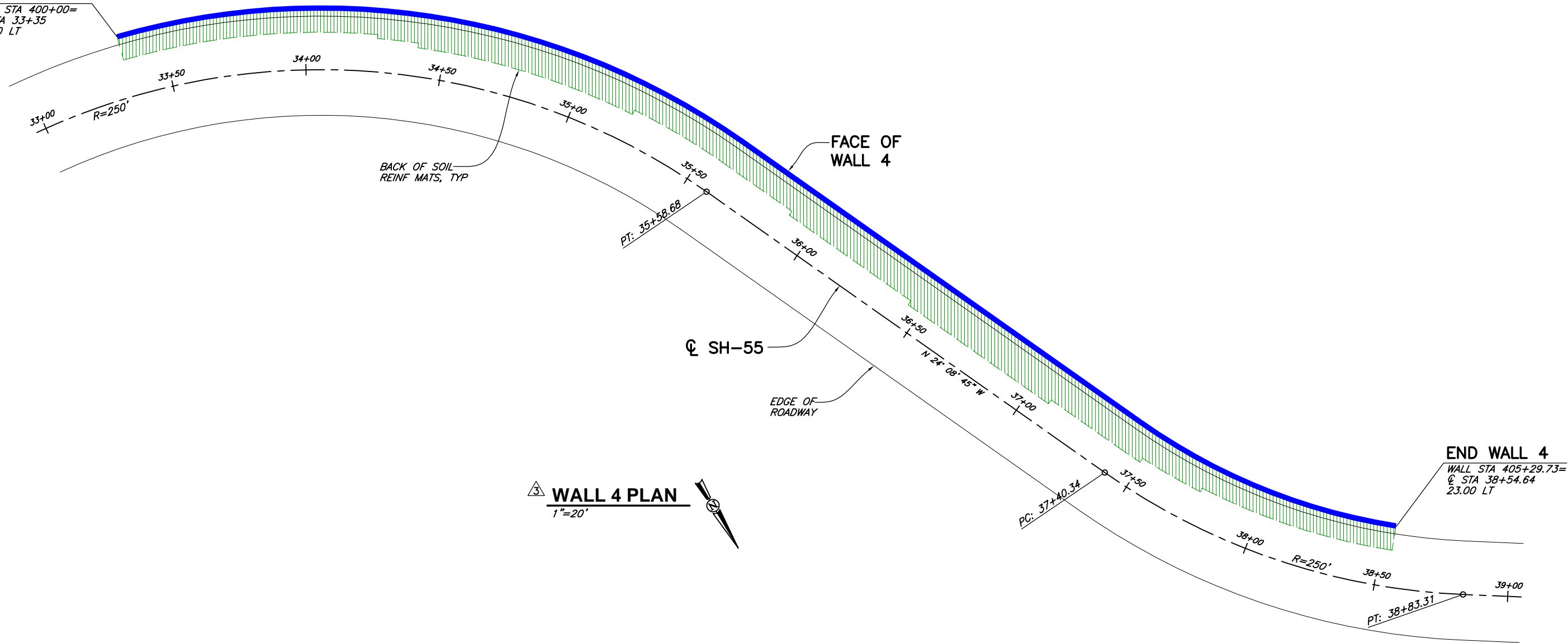

WALL 4 PLAN
1"=20'

END WALL 4
WALL STA 405+29.73=
CL STA 38+54.64
23.00 LT

THE DESIGN CONTAINED ON THESE DRAWINGS IS BASED ON INFORMATION PROVIDED BY THE OWNER. ON THE BASIS OF THIS INFORMATION, THE HILFIKER COMPANY HAS DESIGNED, AND IS RESPONSIBLE FOR THE INTERNAL STABILITY OF THE STRUCTURE ONLY. EXTERNAL STABILITY, INCLUDING FOUNDATION AND SLOPE STABILITY, IS THE RESPONSIBILITY OF THE OWNER.

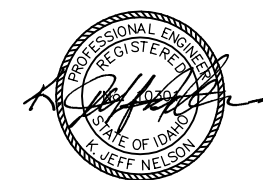

WELDED WIRE WALLS
HILFIKER RETAINING WALLS

1902 Hilfiker Lane
Eureka, CA 95503-5711
TOLL-FREE 800.762.8962
PH 707.443.5093 FAX 707.443.2891
WEBSITE www.hilfiker.com E-MAIL info@hilfiker.com

VERIFY SCALES BAR IS ONE INCH ON ORIGINAL DRAWING IF NOT ONE INCH ON THIS SHEET, ADJUST SCALES ACCORDINGLY	
CONSULTING ENGINEERS & GEOLOGISTS, INC. WWW.SHN-ENGR.COM 812 W. WABASH EUREKA, CA 95501 707-441-8855	
K/JM K/JM BY	REVISION NO. DATE
REVISION NO. DATE	PLAN CHECK COMMENTS
07/29/15 06/11/15	REVISED WALL 4 PLAN CHECK COMMENTS
JSO DR CHK APVD	NO. DATE
IDAHO DEPARTMENT OF TRANSPORTATION SH-55 GOOSE CREEK GRADE NEW MEADOWS, ADAMS COUNTY, IDAHO WALL 4 PLAN	
SHEET 4 OF 10	
DATE 5/4/15	
PROJ. NO. 015060	

CAD: \\EUREKA\PROJECTS\2015\015060-SH-55\DWGS\015060-900-GOOSE-CREEK-R3.DWG
(HRW 150119 BW)

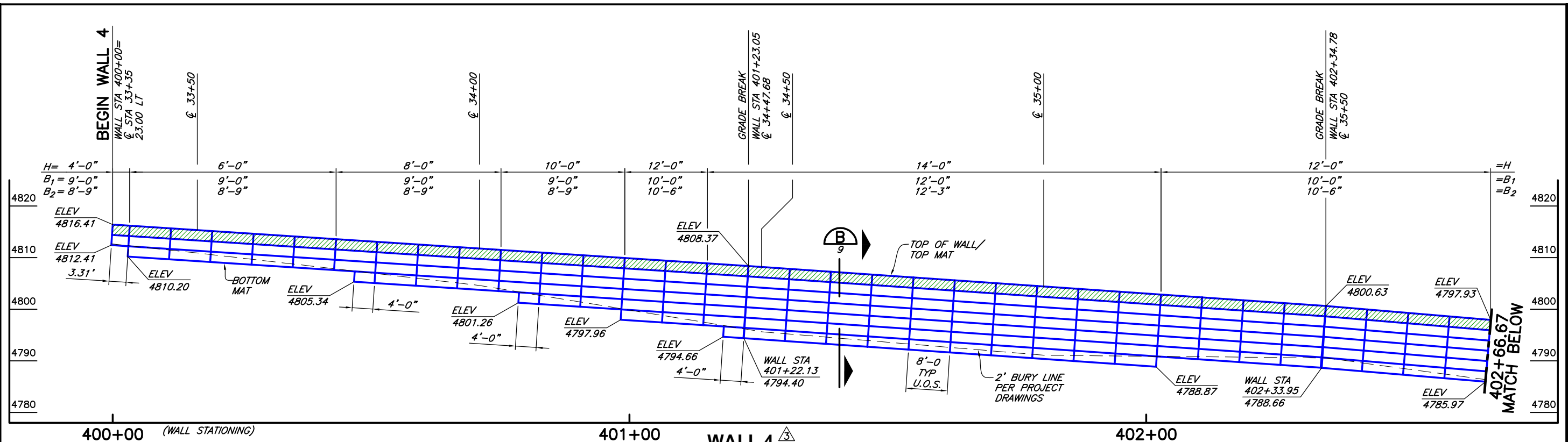

WALL 4
DEVELOPED ELEVATION (BACKFACE)
1"=10' HORIZ AND VERT
U.O.S.= UNLESS OTHERWISE STATED

WWR MAT LEGEND

- 8x12, W4.5xW3.5 WWR SOIL REINFORCING MATS
- 8x21, W7xW4 WWR SOIL REINFORCING MATS

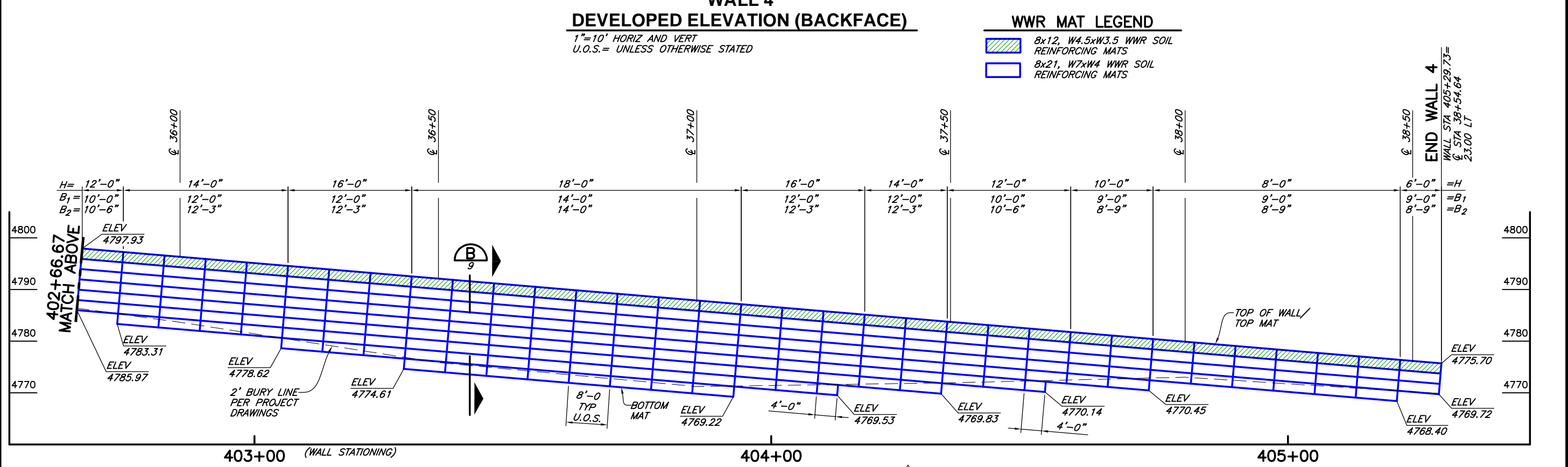

WALL 4 (CONTINUED)
DEVELOPED ELEVATION (BACKFACE)
1"=10' HORIZ AND VERT
U.O.S.= UNLESS OTHERWISE STATED

WWR MAT LEGEND

- 8x12, W4.5xW3.5 WWR SOIL REINFORCING MATS
- 8x21, W7xW4 WWR SOIL REINFORCING MATS

THE DESIGN CONTAINED ON THESE DRAWINGS IS BASED ON INFORMATION PROVIDED BY THE OWNER. ON THE BASIS OF THIS INFORMATION, THE HILFIKER COMPANY HAS DESIGNED, AND IS RESPONSIBLE FOR THE INTERNAL STABILITY OF THE STRUCTURE ONLY. EXTERNAL STABILITY, INCLUDING FOUNDATION AND SLOPE STABILITY, IS THE RESPONSIBILITY OF THE OWNER.



WELDED WIRE WALLS
HILFIKER RETAINING WALLS

1902 HilfiKER Lane
Eureka, CA 95503-5711
TOLL-FREE 800.762.8962
PH 707.443.5093 FAX 707.443.2891
WEBSITE www.hilfiKER.com E-MAIL info@hilfiKER.com

VERIFY SCALES
BAR IS ONE INCH ON ORIGINAL DRAWING
IF NOT ONE INCH ON THIS SHEET, ADJUST SCALES ACCORDINGLY

CONSULTING ENGINEERS & GEOLOGISTS, INC.
WWW.SHIN-ENGR.COM
812 W. WABASH EUREKA, CA 95501
707-441-8855

SHIN

NO.	DATE	REVISION	BY
1	07/29/15	REVISED WALL 4	K/JM
2	06/11/15	PLAN CHECK COMMENTS	K/JM

DESIGN: JSO
DR: NMD
CHK: K/JM
APVD:

IDAHO DEPARTMENT OF TRANSPORTATION
SH-55 GOOSE CREEK GRADE
NEW MEADOWS, ADAMS COUNTY, IDAHO

WALL 4 ELEVATIONS

SHEET **4A** OF 10
DATE 5/4/15
PROJ. NO. 015060

CAD: \\EUREKA\PROJECTS\2015\015060-SH-55\DWGS\015060-900-GOOSE-CREEK-R3.DWG
(HRW 150119 BW)

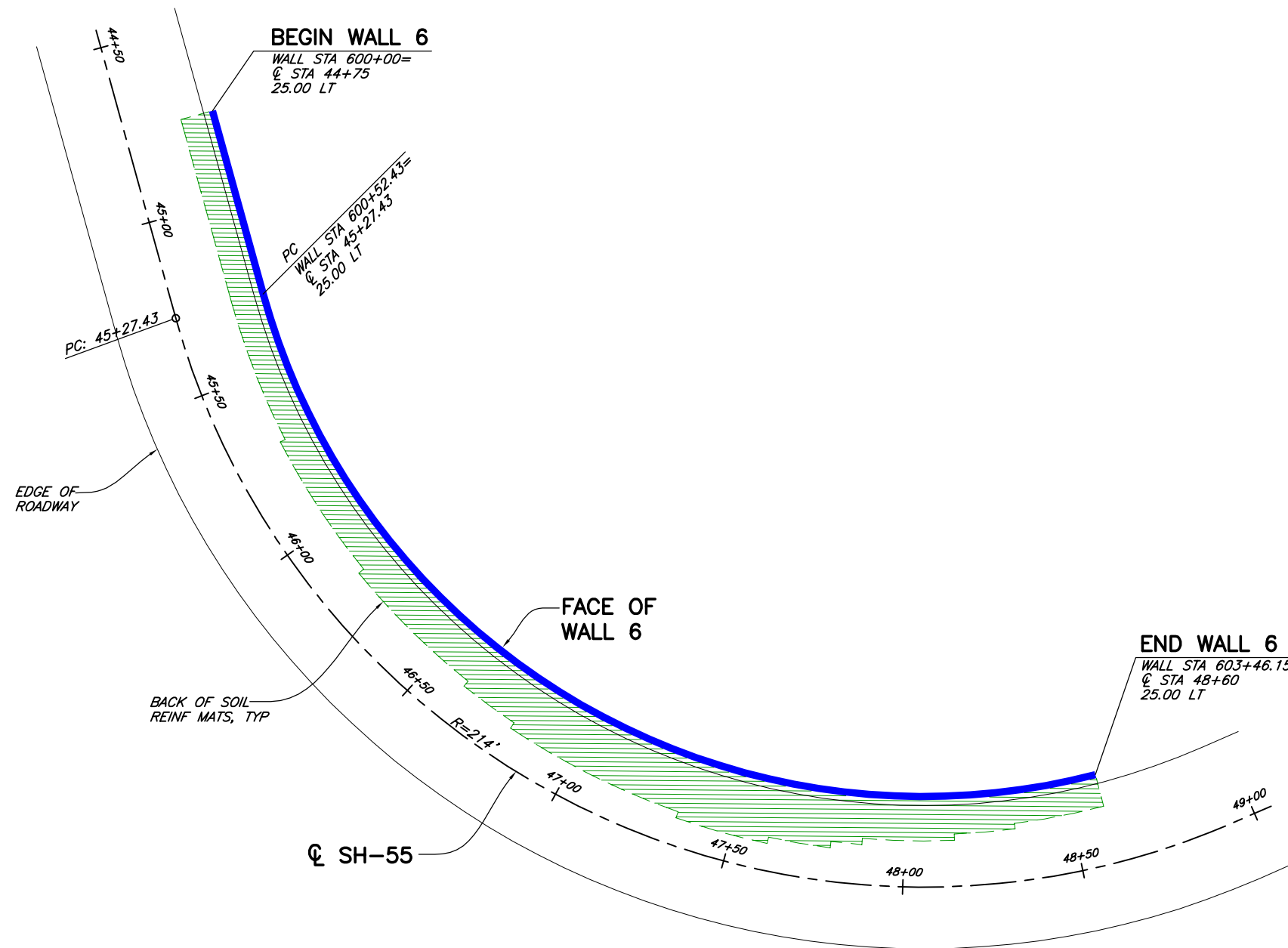

WALL 6 PLAN
1"=20'



WELDED WIRE WALLS

HILFIKER RETAINING WALLS



1902
SINCE 1902
1902
QUALITY PRODUCTS

1902 Hilfiker Lane
Eureka, CA 95503-5711
TOLL-FREE 800.762.8962
PH 707.443.5093 FAX 707.443.2891
WEB SITE www.hilfiker.com E-MAIL info@hilfiker.com

THE DESIGN CONTAINED ON THESE DRAWINGS IS BASED ON INFORMATION PROVIDED BY THE OWNER. ON THE BASIS OF THIS INFORMATION, THE HILFIKER COMPANY HAS DESIGNED, AND IS RESPONSIBLE FOR THE INTERNAL STABILITY OF THE STRUCTURE ONLY. EXTERNAL STABILITY, INCLUDING FOUNDATION AND SLOPE STABILITY, IS THE RESPONSIBILITY OF THE OWNER.

VERIFY SCALES
BAR IS ONE INCH ON ORIGINAL DRAWING
IF NOT ONE INCH ON THIS SHEET, ADJUST SCALES ACCORDINGLY

CONSULTING ENGINEERS & GEOLOGISTS, INC.
812 W. WABASH EUREKA, CA 95501
WWW.SHN-ENGR.COM
707-441-8855

SHN

DESIGN	JSO	BY	
DR	MMD	DATE	
CHK	K/JN	NO.	
APVD		REVISION	

IDAHO DEPARTMENT OF TRANSPORTATION
SH-55 GOOSE CREEK GRADE
NEW MEADOWS, ADAMS COUNTY, IDAHO

WALL 6 PLAN

SHEET 5 OF 10
DATE 5/4/15
PROJ. NO. 015060

CAD: \\EUREKA\PROJECTS\2015\015060-SH-55\DWGS\015060-900-GOOSE-CREEK-R3.DWG
(HRW 150119 BW)

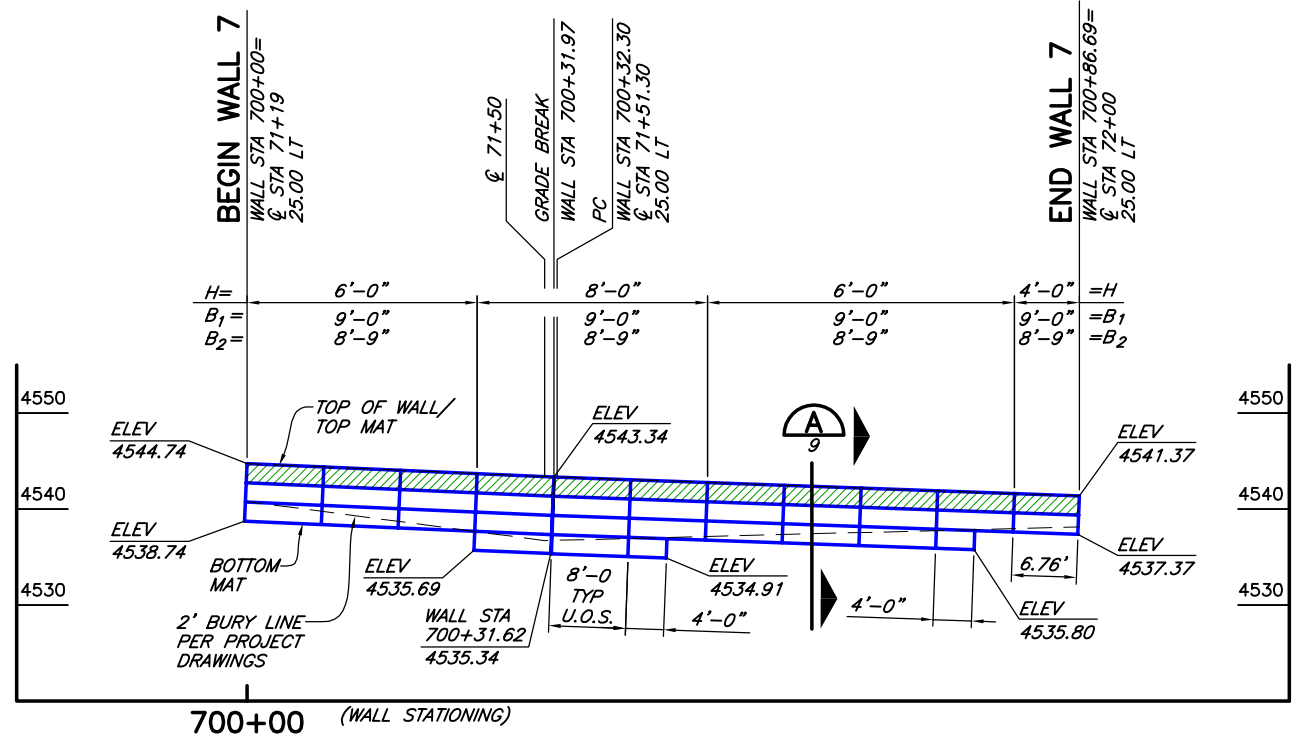

**WALL 7
DEVELOPED ELEVATION (BACKFACE)**

1"=10' HORIZ AND VERT
U.O.S.= UNLESS OTHERWISE STATED

WWR MAT LEGEND

- 8x12, W4.5xW3.5 WWR SOIL REINFORCING MATS
- 8x21, W7xW4 WWR SOIL REINFORCING MATS

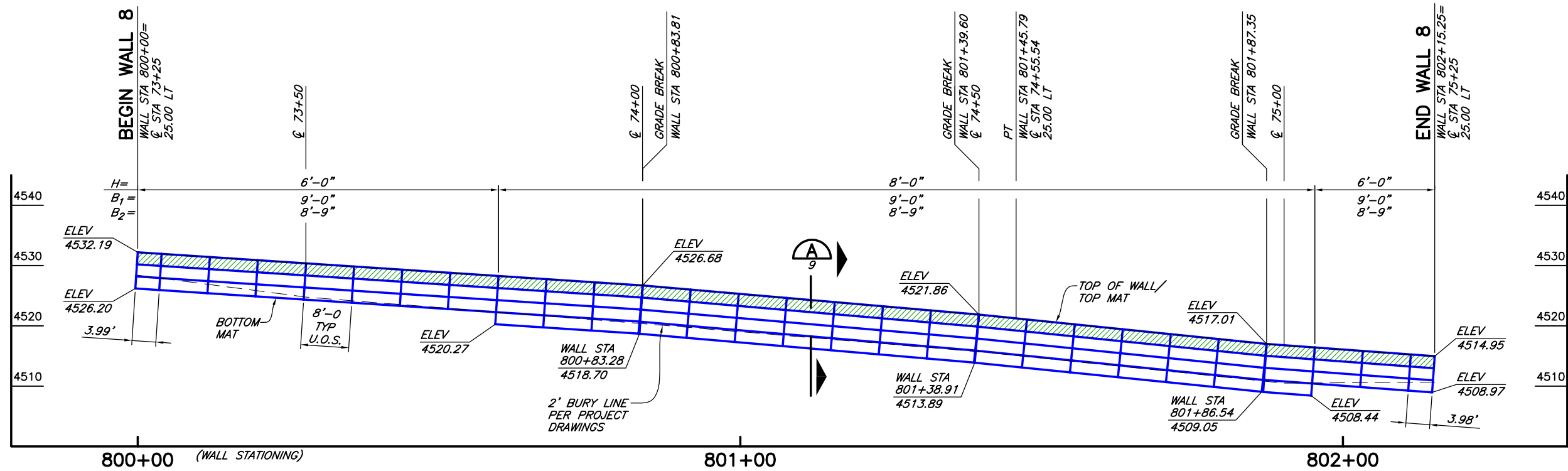

**WALL 8
DEVELOPED ELEVATION (BACKFACE)**

1"=10' HORIZ AND VERT
U.O.S.= UNLESS OTHERWISE STATED

WWR MAT LEGEND

- 8x12, W4.5xW3.5 WWR SOIL REINFORCING MATS
- 8x21, W7xW4 WWR SOIL REINFORCING MATS



**WELDED WIRE WALLS
HILFIKER RETAINING WALLS**



1902 Hilfiker Lane
Eureka, CA 95503-5711
TOLL-FREE 800.762.8962
PH 707.443.5093 FAX 707.443.2891
WEB SITE www.hilfiker.com E-MAIL info@hilfiker.com



VERIFY SCALES
BAR IS ONE INCH ON ORIGINAL DRAWING
IF NOT ONE INCH ON THIS SHEET, ADJUST SCALES ACCORDINGLY

CONSULTING ENGINEERS & GEOLOGISTS, INC.
812 W. WABASH EUREKA, CA 95501
WWW.SHN-ENGR.COM
707-441-8855

SH

NO.	DATE	PLAN CHECK COMMENTS	BY
1	06/11/15		KJM

DESIGN: JSO
DRAWING: NMD
CHECK: KJM
APPROVED: [Signature]

IDAHO DEPARTMENT OF TRANSPORTATION
SH-55 GOOSE CREEK GRADE
NEW MEADOWS, ADAMS COUNTY, IDAHO

WALLS 7 & 8 ELEVATIONS

SHEET 8 OF 10
DATE 5/4/15
PROJ. NO. 015060

THE DESIGN CONTAINED ON THESE DRAWINGS IS BASED ON INFORMATION PROVIDED BY THE OWNER. ON THE BASIS OF THIS INFORMATION, THE HILFIKER COMPANY HAS DESIGNED, AND IS RESPONSIBLE FOR THE INTERNAL STABILITY OF THE STRUCTURE ONLY. EXTERNAL STABILITY, INCLUDING FOUNDATION AND SLOPE STABILITY, IS THE RESPONSIBILITY OF THE OWNER.

CAD: \\EUREKA\PROJECTS\2015\015060-SH-55\DWGS\015060-900-GOOSE-CREEK-R3.DWG
(HRW 150119 BW)

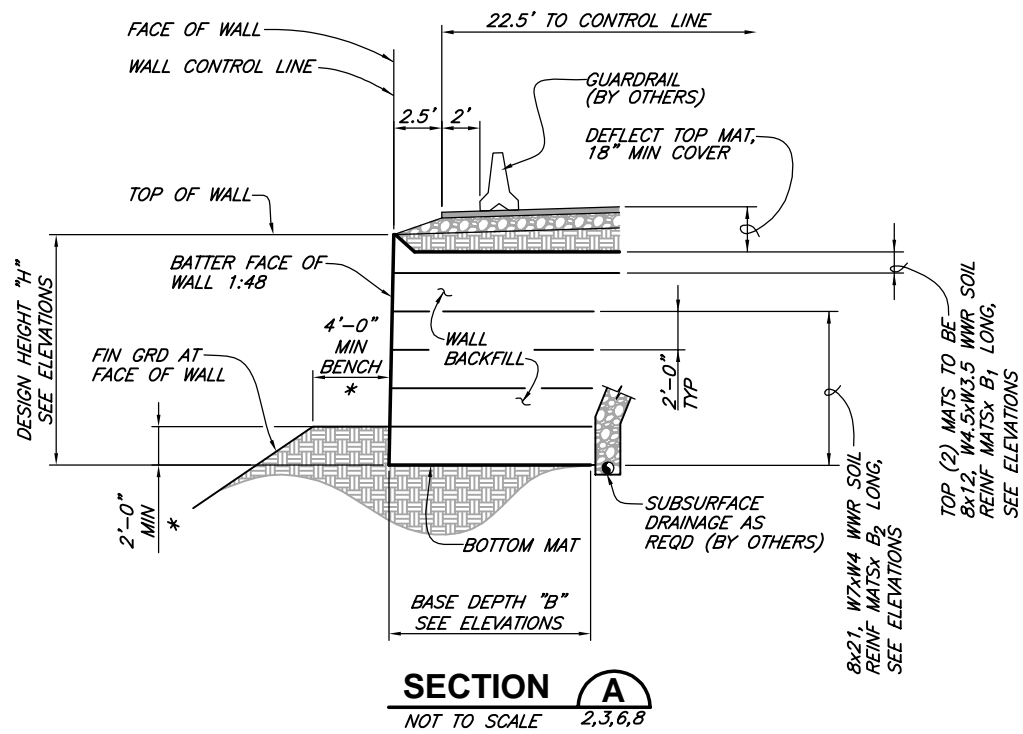

* WALLS 1 & 2 TO HAVE 1' MINIMUM BURY. NO BENCH IS REQUIRED.

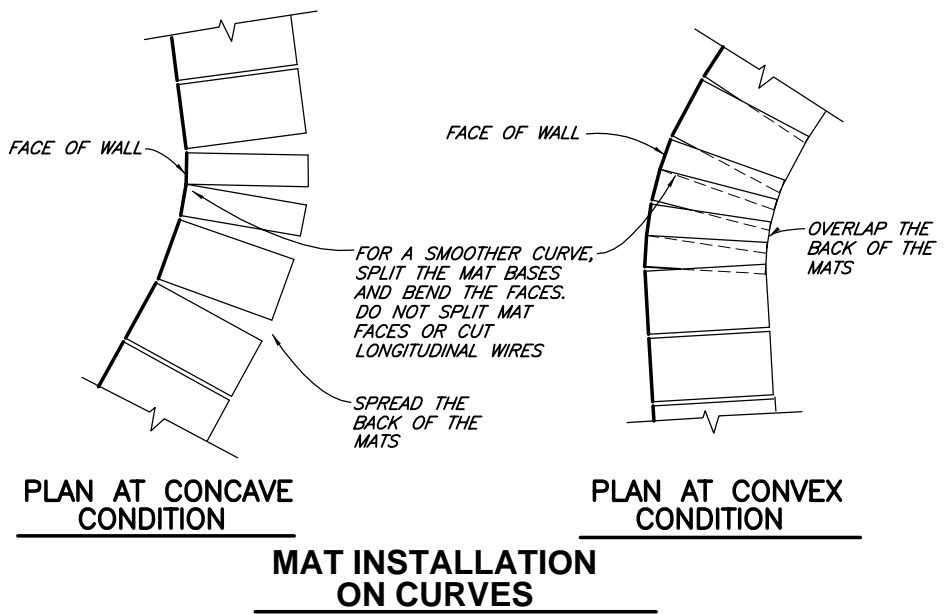
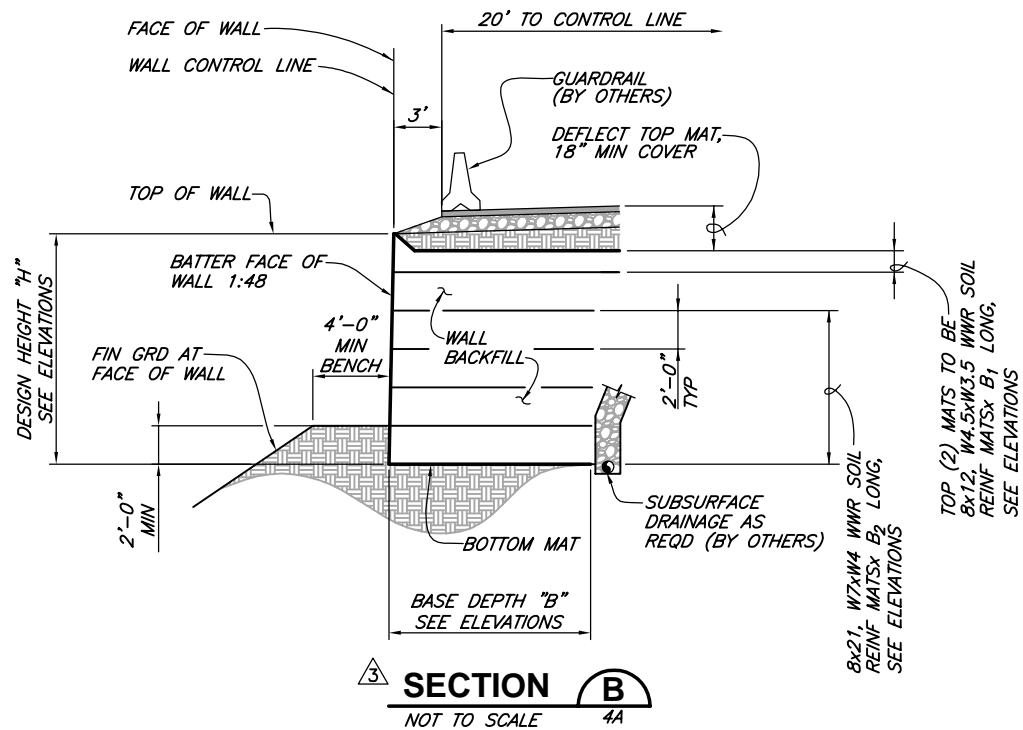
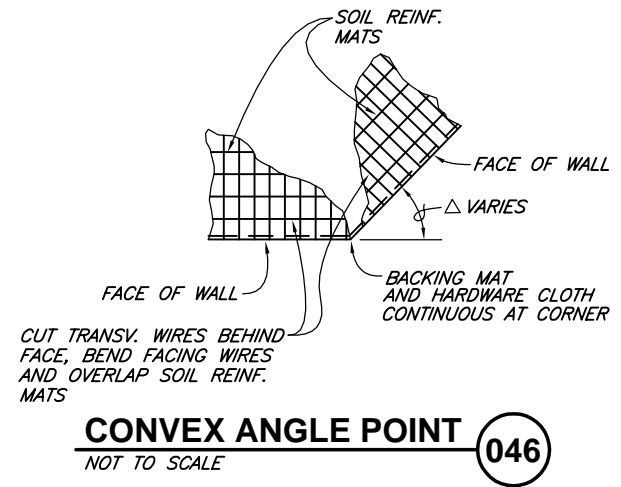
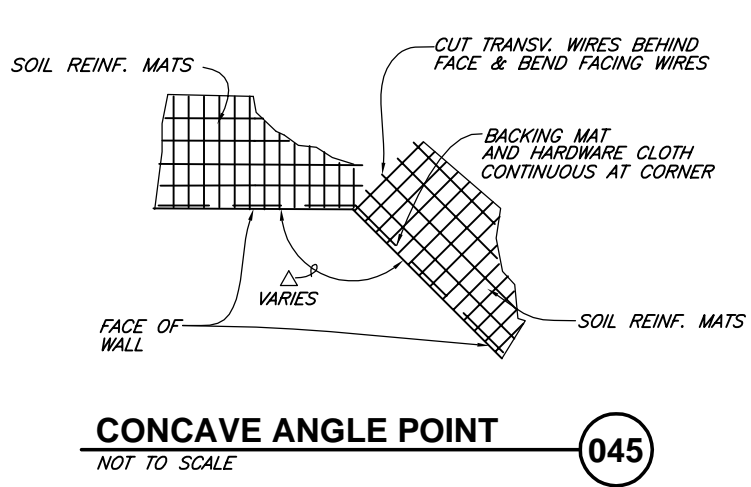

WELDED WIRE WALLS
HILFIKER RETAINING WALLS

1902
SINCE 1902
1902
1902

1902 Hilfiker Lane
Eureka, CA 95503-5711
TOLL-FREE 800.762.8962
PH 707.443.5093 FAX 707.443.2891
WEBSITE www.hilfiker.com E-MAIL info@hilfiker.com

THE DESIGN CONTAINED ON THESE DRAWINGS IS BASED ON INFORMATION PROVIDED BY THE OWNER. ON THE BASIS OF THIS INFORMATION, THE HILFIKER COMPANY HAS DESIGNED, AND IS RESPONSIBLE FOR THE INTERNAL STABILITY OF THE STRUCTURE ONLY. EXTERNAL STABILITY, INCLUDING FOUNDATION AND SLOPE STABILITY, IS THE RESPONSIBILITY OF THE OWNER.

VERIFY SCALES BAR IS ONE INCH ON ORIGINAL DRAWING IF NOT ONE INCH ON THIS SHEET, ADJUST SCALES ACCORDINGLY	
CONSULTING ENGINEERS & GEOLOGISTS, INC. WWW.SHIN-ENGR.COM 812 W. WABASH EUREKA, CA 95501 707-441-8855	
SECTION & DETAILS	
DESIGN	DR
CHK	APVD
NO.	DATE
REVISION	COMMENTS
4	REVISED WALL 4
07/29/15	06/11/15
NO.	DATE
9	5/4/15
9	015060

CAD: \\EUREKA\PROJECTS\2015\015060-SH-55\DWGS\015060-900-GOOSE-CREEK-R3.DWG
(HRW 150119 BW)

STEP 1

PLACE THE FIRST COURSE OF SOIL REINFORCEMENT MATS ON PREPARED FOUNDATION.

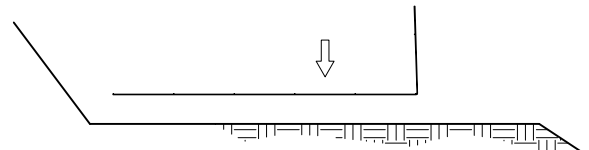

STEP 2

PLACE THE BACKING MAT AGAINST THE INSIDE FACE OF THE SOIL REINFORCEMENT MAT. CLIP THE SECOND-TO-TOP TRANSVERSE WIRE ON THE BACKING MAT TO THE TOP TRANSVERSE WIRE ON THE SOIL REINFORCEMENT MAT.

INSTALL CONTINUOUS HARDWARE CLOTH AND HOG-RING TO THE TOP WIRE ON THE BACKING MAT.

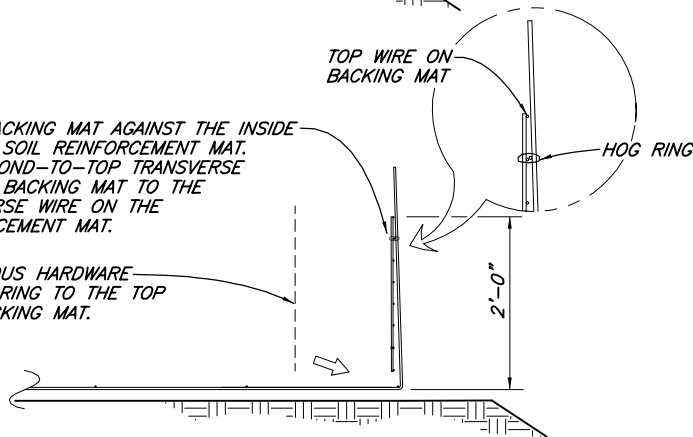

STEP 3

PLACE AND COMPACT THE BACKFILL IN LAYERS AND DENSITIES AS SPECIFIED IN THE PROJECT PLANS. LEAVE A VOID AT THE FACE AS SHOWN.

PLACE THE SECOND COURSE OF SOIL REINFORCEMENT MATS WITH THE BASE LONGITUDINAL WIRES RESTING ON THE TOP TRANSVERSE WIRE OF THE BACKING MAT BELOW. SLIDE THE SOIL REINFORCEMENT MAT INTO ALIGNMENT.

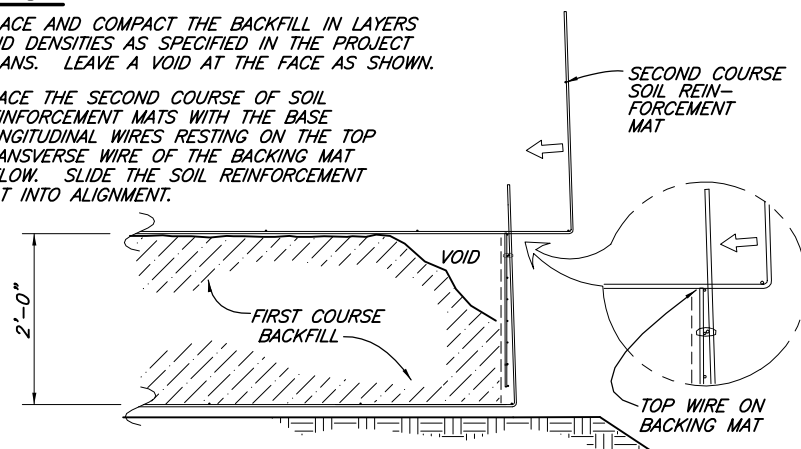

CONSTRUCTION SEQUENCE

NO SCALE

STEP 4

HOG THE BOTTOM TRANSVERSE WIRE OF THE BACKING MAT OVER THE VERTICAL PRONGS ON THE LOWER MAT. ROTATE THE BACKING MAT TO VERTICAL AND CLIP THE SECOND-TO-TOP TRANSVERSE WIRE ON THE BACKING MAT TO THE TOP WIRE ON THE SOIL REINFORCEMENT MAT.

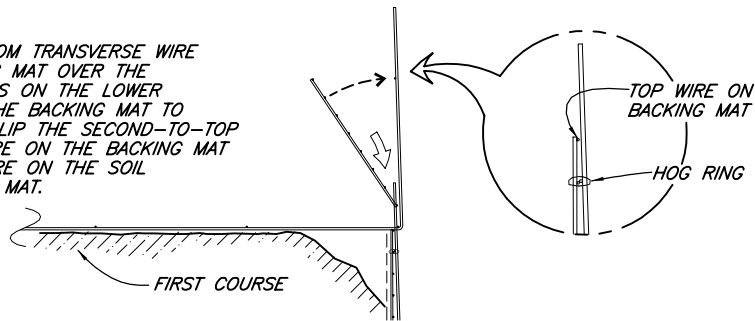

STEP 5

INSTALL THE HARDWARE CLOTH. PLACE AND COMPACT THE BACKFILL TO THE BASE ELEVATION OF THE NEXT MAT. REPEAT STEPS 3 THRU 5 TO THE TOP LIFT.

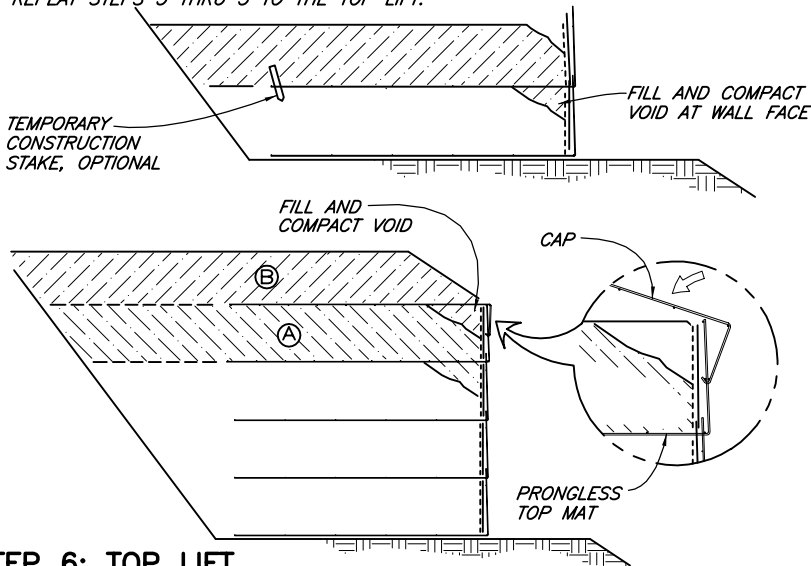

STEP 6: TOP LIFT

PLACE THE TOP LIFT PRONGLESS MAT, BACKING MAT AND HARDWARE CLOTH. PLACE AND COMPACT BACKFILL IN AREA "A". HOOK THE CAP OVER THE MIDDLE TRANSVERSE WIRE ON THE PRONGLESS MAT, AND ROTATE INTO PLACE. BACKFILL "B" TO 1'-6" MINIMUM COVER OVER THE CAP.

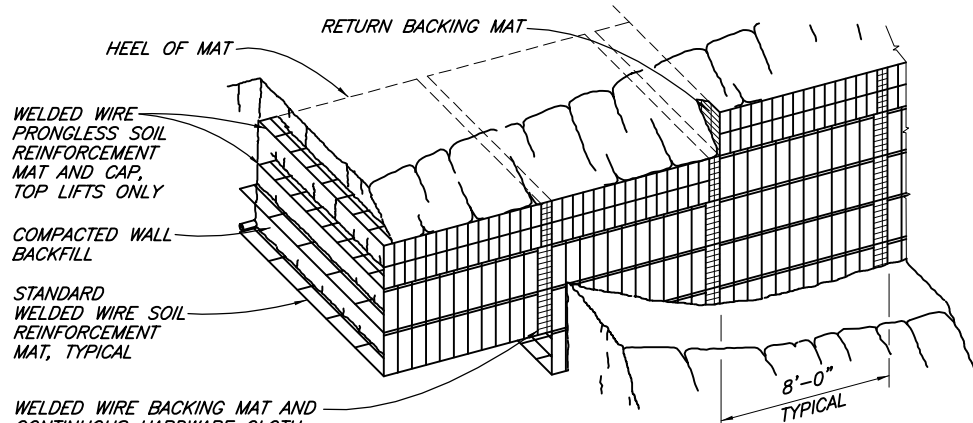

PICTORIAL ELEVATION

NO SCALE

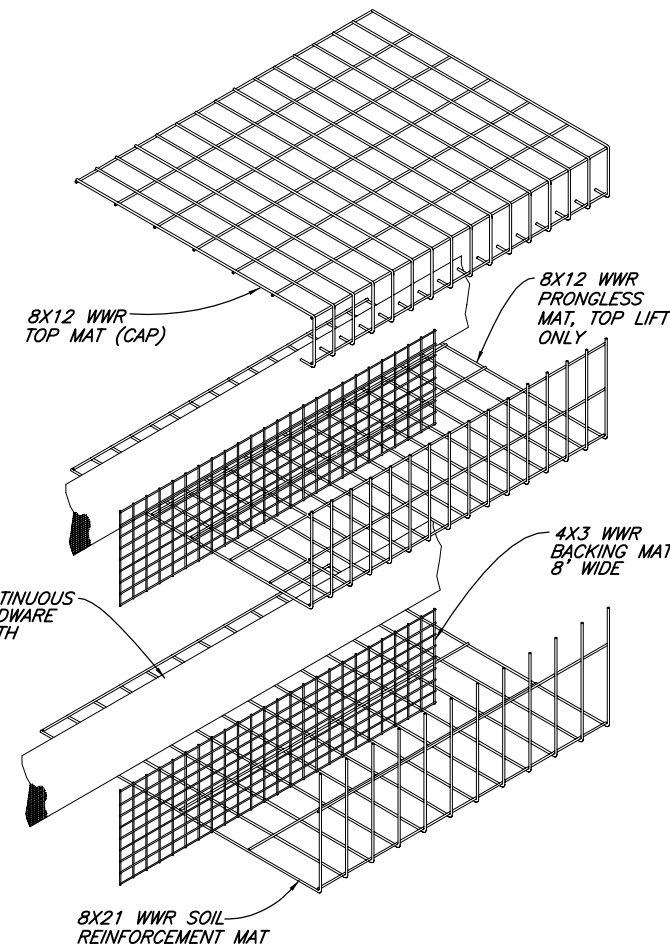

WALL COMPONENTS

NO SCALE

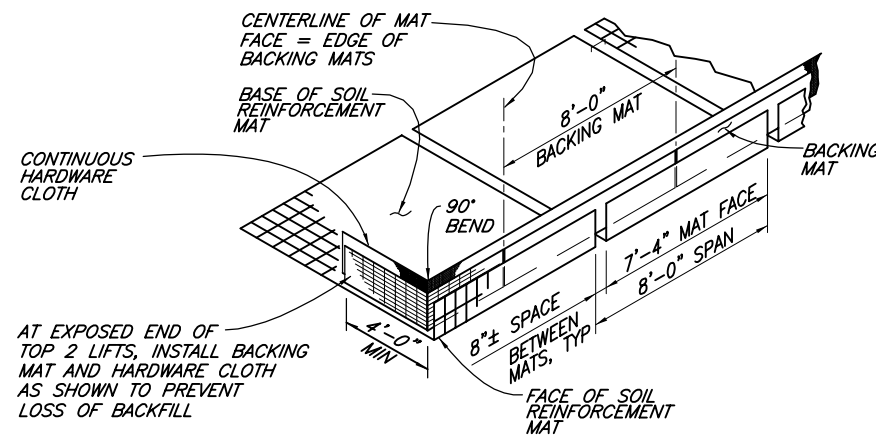

ASSEMBLED WALL COMPONENTS

NO SCALE

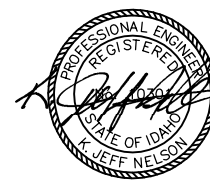

**WELDED WIRE WALLS
HILFIKER RETAINING WALLS**

1902 Hilfiker Lane
Eureka, CA 95503-5711
TOLL-FREE 800.762.8962
PH 707.443.5093 FAX 707.443.2891
WEBSITE www.hilfiker.com E-MAIL info@hilfiker.com



VERIFY SCALES
BAR IS ONE INCH ON ORIGINAL DRAWING
IF NOT ONE INCH ON THIS SHEET, ADJUST SCALES ACCORDINGLY

CONSULTING ENGINEERS & GEOLOGISTS, INC.
WWW.SHIN-ENGR.COM
812 W. WABASH EUREKA, CA 95501
707-441-8855



DESIGN	JSD	DATE	
DR	MMD	NO.	
CHK	K/JN	REVISION	
APP'D		BY	
IDAHO DEPARTMENT OF TRANSPORTATION SH-55 GOOSE CREEK GRADE NEW MEADOWS, ADAMS COUNTY, IDAHO WALL COMPONENTS AND CONSTRUCTION SEQUENCE			
SHEET 10 OF 10			
DATE 5/4/15			
PROJ. NO. 015060			

THE DESIGN CONTAINED ON THESE DRAWINGS IS BASED ON INFORMATION PROVIDED BY THE OWNER. ON THE BASIS OF THIS INFORMATION, THE HILFIKER COMPANY HAS DESIGNED, AND IS RESPONSIBLE FOR THE INTERNAL STABILITY OF THE STRUCTURE ONLY. EXTERNAL STABILITY, INCLUDING FOUNDATION AND SLOPE STABILITY, IS THE RESPONSIBILITY OF THE OWNER.