

**STEP 1**  
 PLACE THE FIRST COURSE OF FACING MATS ON PREPARED FOUNDATION.  
 PLACE AND COMPACT FIRST COURSE BACKFILL LEAVING VOID IN FACE PER PROJECT PLANS

**STEP 2**  
 PLACE THE BACKING MAT AND MIRAMESH OR FILTER FABRIC AGAINST THE INSIDE FACE OF THE FACING MAT. CLIP THE SECOND-TO-TOP TRANSVERSE WIRE ON THE BACKING MAT TO THE TOP TRANSVERSE WIRE ON THE FACING MAT.  
 PLACE THE FIRST COURSE OF GEOGRID AS SHOWN.

**STEP 3**  
 PLACE AND COMPACT SECOND COURSE BACKFILL LEAVING A VOID AS SHOWN  
 PLACE THE SECOND COURSE OF FACING MATS WITH THE BASE LONGITUDINAL WIRES RESTING ON THE TOP TRANSVERSE WIRE OF THE BACKING MAT BELOW. SLIDE THE SOIL REINFORCEMENT MAT INTO ALIGNMENT.

**STEP 4**  
 HOOK THE BOTTOM TRANSVERSE WIRE OF THE BACKING MAT OVER THE VERTICAL PRONGS ON THE LOWER MAT. ROTATE THE BACKING MAT TO VERTICAL AND CLIP THE SECOND-TO-TOP TRANSVERSE WIRE ON THE BACKING MAT AND THE MIRAMESH TO THE TOP WIRE ON THE SOIL REINFORCEMENT MAT.

**STEP 5**  
 INSTALL GEOGRID AS IN STEPS 1 AND 2. PLACE AND COMPACT THE BACKFILL TO THE BASE ELEVATION OF THE NEXT MAT. REPEAT STEPS 2 THROUGH 5 TO THE TOP LIFT.

**STEP 6: TOP LIFT**  
 PLACE THE TOP LIFT PRONGLESS MAT, BACKING MAT AND GEOGRID OR FILTER FABRIC. PLACE AND COMPACT BACKFILL AND ROCK IN THE TOP LIFT. HOOK THE MIDDLE TRANSVERSE WIRE ON THE PRONGLESS MAT, AND ROTATE INTO PLACE. PLACE AND COMPACT COVER OVER TOP MAT TO 1'-6" MINIMUM DEPTH.

**CONSTRUCTION SEQUENCE**  
 NOT TO SCALE

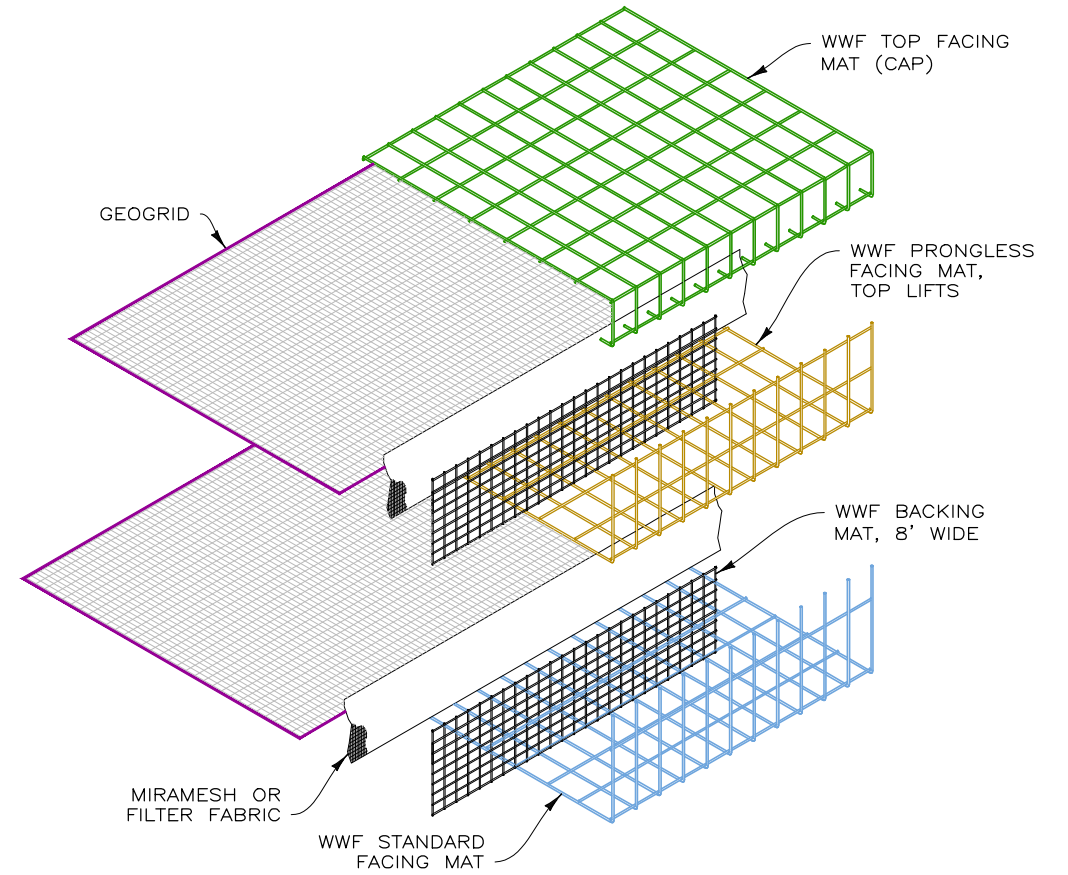

**WALL COMPONENTS**  
 NOT TO SCALE

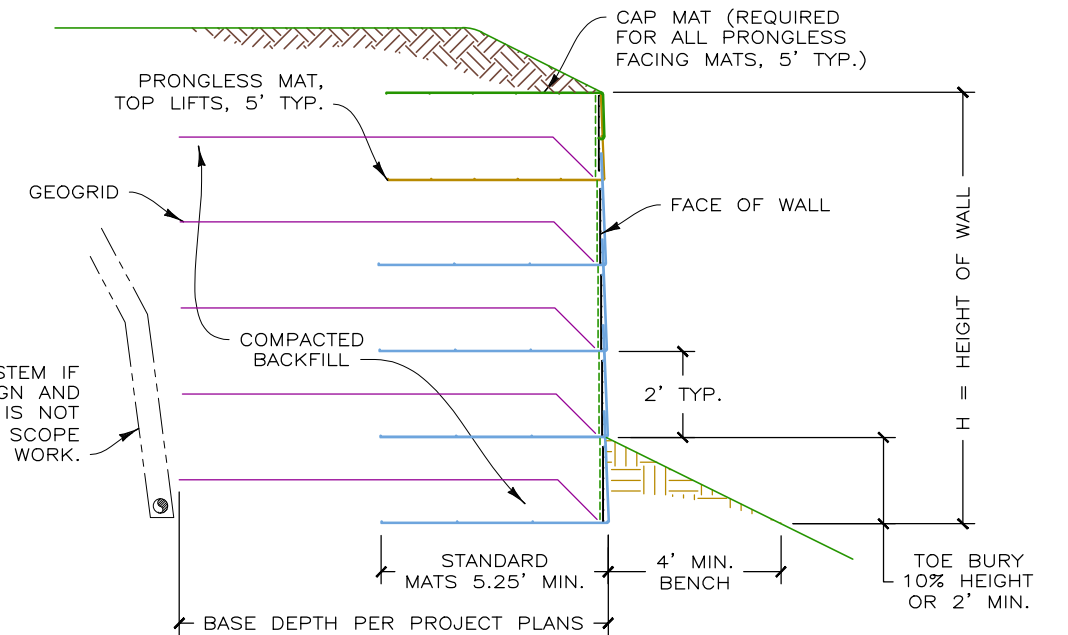

**TYPICAL SECTION - WIRE FACED GEOGRID WALL**  
 NOT TO SCALE

CAD: W:\PRODUCT INFO\1. DRAWINGS\1D DETAILS\WWF STANDARD DWGS.DWG

THIS DRAWING IS FURNISHED SOLELY FOR THE USE OF OR IN CONNECTION WITH THIS PROJECT AND THE PROPRIETARY INFORMATION SHOWN HEREON IS NOT TO BE TRANSMITTED TO ANY OTHER ORGANIZATION WITHOUT SPECIFIC AUTHORIZATION BY THE HILFIKER COMPANY. HILFIKER RETAINING WALLS ARE PROTECTED BY ONE OR MORE OF THE FOLLOWING PATENTS: 243,613; 243,697; 288,616; 4,117,686; 4,329,089; 4,324,508; 4,391,557; 4,505,621; 4,343,318; 4,661,023; 4,856,939; 4,929,125; 5,076,735; 5,647,695; 5,722,799; 5,733,072; 6,357,970B1; 6,874,975B2; 7,033,118B2; AND OTHERS. OTHER PATENTS PENDING (2008)

| REV.NO. | DATE | BY | DESCRIPTION |
|---------|------|----|-------------|
|         |      |    |             |
|         |      |    |             |
|         |      |    |             |

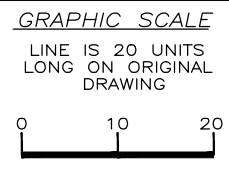

PROJ. MGR.  
 DRAWN BY HRW  
 REVIEWED BY HRW

**HILFIKER RETAINING WALLS**

1902 Hilfiker Lane  
 Eureka, CA 95503-5711  
 TOLL-FREE 800.762.8962  
 PH 707.443.5093 FAX 707.443.2891  
 WEB SITE www.hilfiker.com E-MAIL info@hilfiker.com

**SINCE 1902**  
 QUALITY PRODUCTS

DWG DATE OCT 2021  
 REVISION DATE  
 SCALE NOTED

|   |                |
|---|----------------|
| STANDARD DRAWING                              | PROJECT NO. -- |
| WELDED WIRE FACING SYSTEM WITH GEOGRID REINF. | SHEET 1        |
| RETAINING WALL SYSTEM                         | OF 3           |
| STANDARD DETAILS                              |                |

**STEP 1**  
PLACE THE FIRST COURSE OF FACING MATS ON PREPARED FOUNDATION.

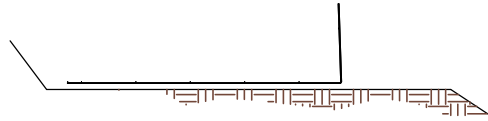

**STEP 2**  
PLACE THE BACKING MAT AGAINST THE INSIDE FACE OF THE FACING MAT. CLIP THE SECOND-TO-TOP TRANSVERSE WIRE ON THE BACKING MAT TO THE TOP TRANSVERSE WIRE ON THE FACING MAT. INSTALL CONTINUOUS FILTER FABRIC AS SHOWN.

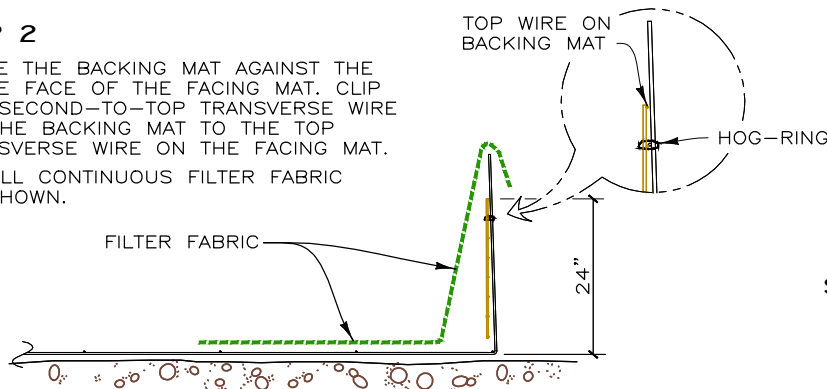

**STEP 3**  
PLACE AND COMPACT FIRST COURSE BACKFILL.  
PLACE GEOGRID AS SHOWN.

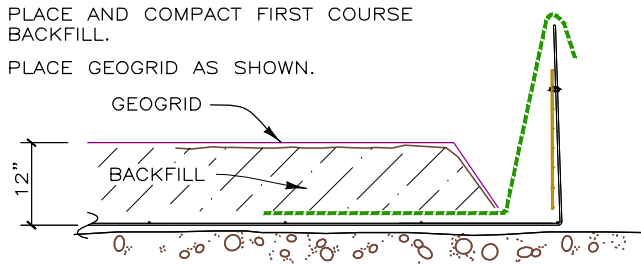

**STEP 4**  
PLACE AND COMPACT SECOND COURSE BACKFILL.  
BRING THE FILTER FABRIC OVER THE FRONT AND TOP OF THE BACKFILL AS SHOWN. PLACE THE ROCK IN THE FACE OF THE WALL PER PROJECT PLANS. LEAVE A VOID AS SHOWN.

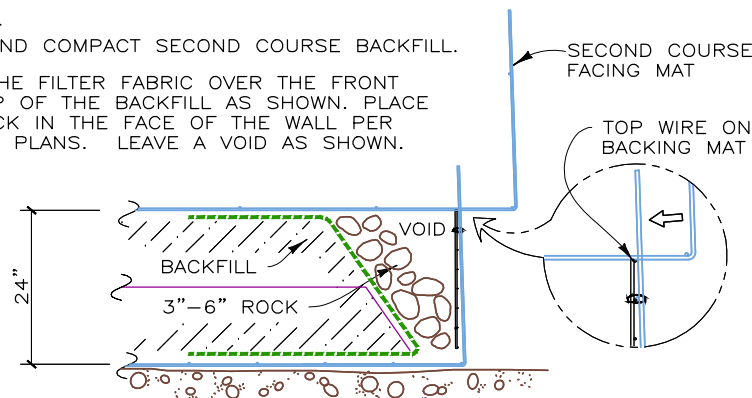

**CONSTRUCTION SEQUENCE - ROCK FACE**  
NOT TO SCALE

**STEP 4**  
HOOK THE BOTTOM TRANSVERSE WIRE OF THE BACKING MAT OVER THE VERTICAL PRONGS ON THE LOWER MAT. ROTATE THE BACKING MAT TO VERTICAL AND CLIP THE SECOND-TO-TOP TRANSVERSE WIRE ON THE BACKING MAT TO THE TOP WIRE ON THE FACING MAT.

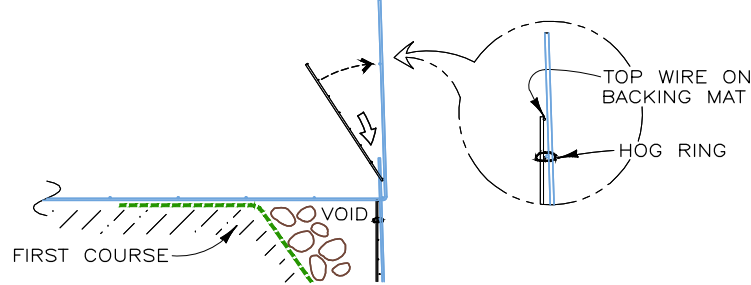

**STEP 5**  
INSTALL FILTER FABRIC AND GEOGRID AS IN STEPS 2-4. PLACE AND COMPACT THE BACKFILL AND ROCK TO THE BASE ELEVATION OF THE NEXT MAT. REPEAT STEPS 2 THROUGH 5 TO THE TOP LIFT.

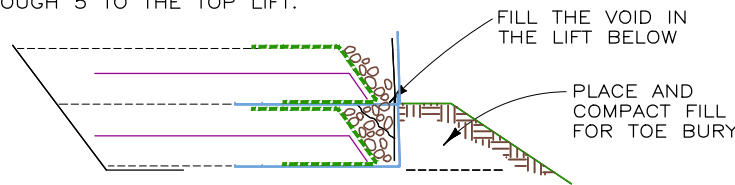

**STEP 6: TOP LIFT**  
PLACE THE TOP LIFT PRONGLESS MAT, BACKING MAT, FILTER FABRIC, AND GEOGRID. PLACE AND COMPACT BACKFILL AND ROCK IN THE TOP LIFT. HOOK FOLD THE TOP TAIL OF THE FILTER FABRIC OVER THE ROCK IN THE FACE TO PREVENT FINES FROM MIGRATING. HOOK THE CAP OVER THE MIDDLE TRANSVERSE WIRE ON THE PRONGLESS MAT, AND ROTATE INTO PLACE. PLACE AND COMPACT COVER OVER TOP MAT TO 1'-6" MINIMUM DEPTH.

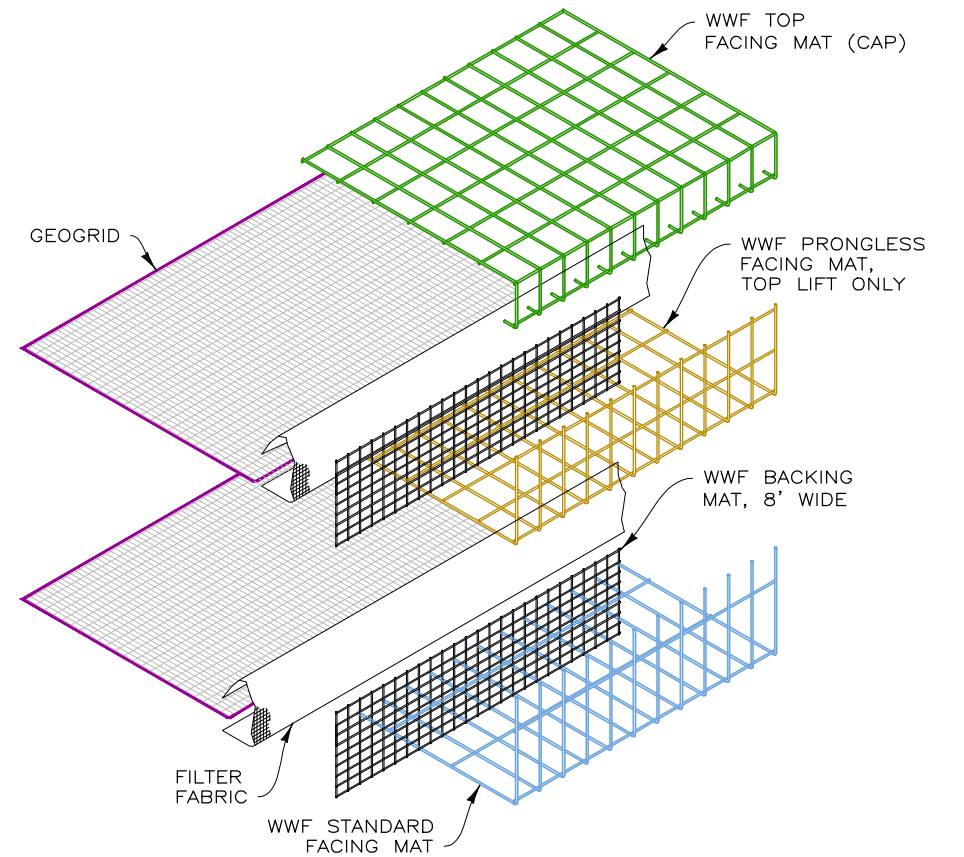
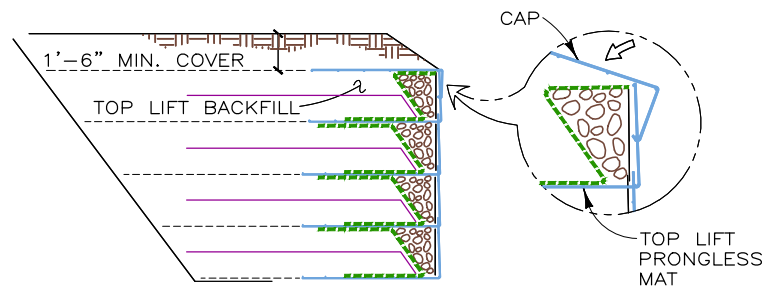

**WALL COMPONENTS**  
NOT TO SCALE

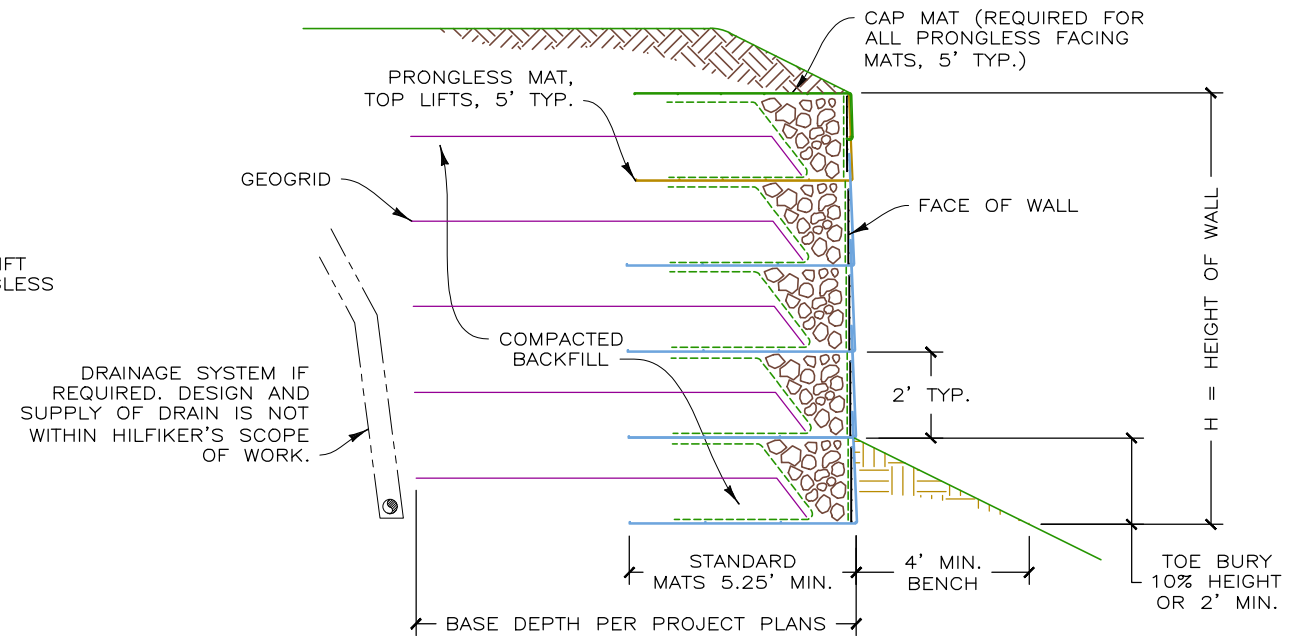

**TYPICAL SECTION - ROCK FACED GEOGRID WALL**  
NOT TO SCALE

CAD: W:\PRODUCT INFO\1. DRAWINGS\1D DETAILS\WWF STANDARD DWGS.DWG

THIS DRAWING IS FURNISHED SOLELY FOR THE USE OF OR IN CONNECTION WITH THIS PROJECT AND THE PROPRIETARY INFORMATION SHOWN HEREON IS NOT TO BE TRANSMITTED TO ANY OTHER ORGANIZATION WITHOUT SPECIFIC AUTHORIZATION BY THE HILFIKER COMPANY. HILFIKER RETAINING WALLS ARE PROTECTED BY ONE OR MORE OF THE FOLLOWING PATENTS: 243,613; 243,697; 288,616; 4,117,686; 4,329,089; 4,324,508; 4,391,557; 4,505,621; 4,343,318; 4,661,023; 4,856,939; 4,929,125; 5,076,735; 5,647,695; 5,722,799; 5,733,072; 6,357,970B1; 6,874,975B2; 7,033,118B2; AND OTHERS. OTHER PATENTS PENDING (2008)

| REV. NO. | DATE | BY | DESCRIPTION |
|----------|------|----|-------------|
|          |      |    |             |
|          |      |    |             |
|          |      |    |             |

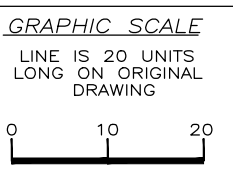

PROJ. MGR.  
DRAWN BY HRW  
REVIEWED BY HRW

**HILFIKER RETAINING WALLS**

1902 Hilfiker Lane  
Eureka, CA 95503-5711  
TOLL-FREE 800.762.8962  
PH 707.443.5093 FAX 707.443.2891  
WEBSITE www.hilfiker.com E-MAIL info@hilfiker.com

SINCE 1902 QUALITY PRODUCTS

DWG DATE OCT 2021  
REVISION DATE  
SCALE NOTED

|   |                |
|---|----------------|
| STANDARD DRAWING                              | PROJECT NO. -- |
| WELDED WIRE FACING SYSTEM WITH GEOGRID REINF. | SHEET 2 OF 3   |
| ROCK FACE RETAINING WALL SYSTEM               |                |
| STANDARD DETAILS                              |                |

**STEP 1**  
PLACE THE FIRST COURSE OF FACING MATS ON PREPARED FOUNDATION.

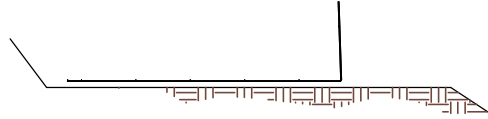

**STEP 2**  
PLACE THE BACKING MAT AND MIRAMESH AGAINST THE INSIDE FACE OF THE FACING MAT. CLIP THE SECOND-TO-TOP TRANSVERSE WIRE ON THE BACKING MAT TO THE TOP TRANSVERSE WIRE ON THE FACING MAT.

INSTALL CONTINUOUS FILTER FABRIC AS SHOWN.

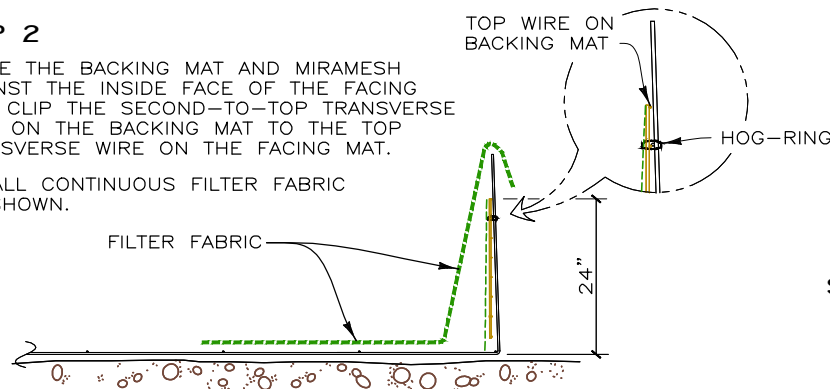

**STEP 3**  
PLACE AND COMPACT FIRST COURSE BACKFILL.

PLACE GEOGRID AS SHOWN.

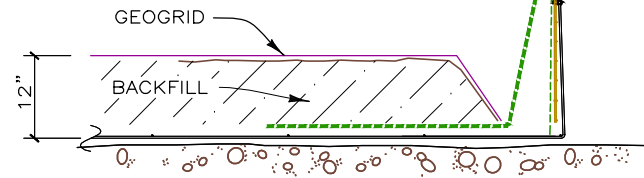

**STEP 4**  
PLACE AND COMPACT SECOND COURSE BACKFILL.

BRING THE FILTER FABRIC OVER THE FRONT AND TOP OF THE BACKFILL AS SHOWN. PLACE THE SOIL IN THE FACE OF THE WALL PER PROJECT PLANS. LEAVE A VOID AS SHOWN.

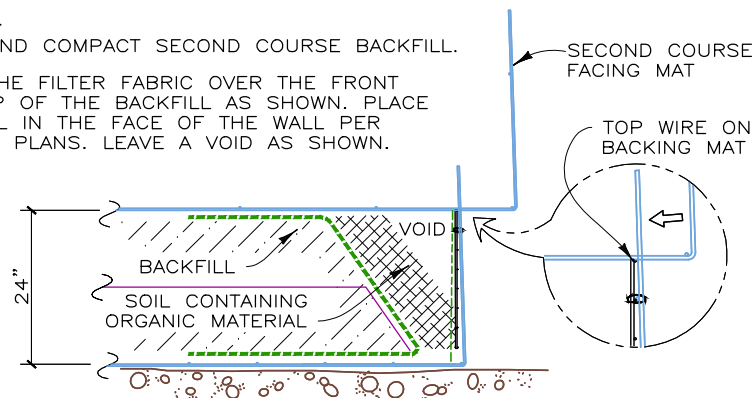

**STEP 4**  
HOOK THE BOTTOM TRANSVERSE WIRE OF THE BACKING MAT OVER THE VERTICAL PRONGS ON THE LOWER MAT. ROTATE THE BACKING MAT TO VERTICAL AND CLIP THE SECOND-TO-TOP TRANSVERSE WIRE ON THE BACKING MAT AND THE MIRAMESH TO THE TOP WIRE ON THE FACING MAT.

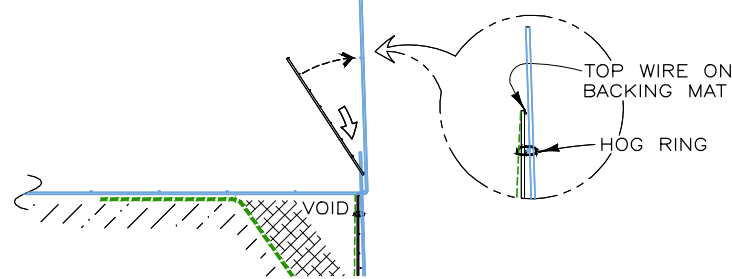

**STEP 5**  
INSTALL FILTER FABRIC AND GEOGRID AS IN STEPS 2-4. PLACE AND COMPACT THE BACKFILL AND SOIL TO THE BASE ELEVATION OF THE NEXT MAT. REPEAT STEPS 2 THROUGH 5 TO THE TOP LIFT.

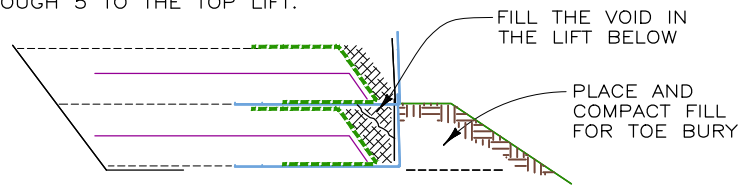

**STEP 6: TOP LIFT**  
PLACE THE TOP LIFT PRONGLESS MAT, BACKING MAT, MIRAMESH, FILTER FABRIC, AND GEOGRID. PLACE AND COMPACT BACKFILL AND SOIL IN THE TOP LIFT. HOOK FOLD THE TOP TAIL OF THE FILTER FABRIC OVER THE SOIL IN THE FACE TO PREVENT FINES FROM MIGRATING. HOOK THE CAP OVER THE MIDDLE TRANSVERSE WIRE ON THE PRONGLESS MAT, AND ROTATE INTO PLACE. PLACE AND COMPACT COVER OVER TOP MAT TO 1'-6" MINIMUM DEPTH.

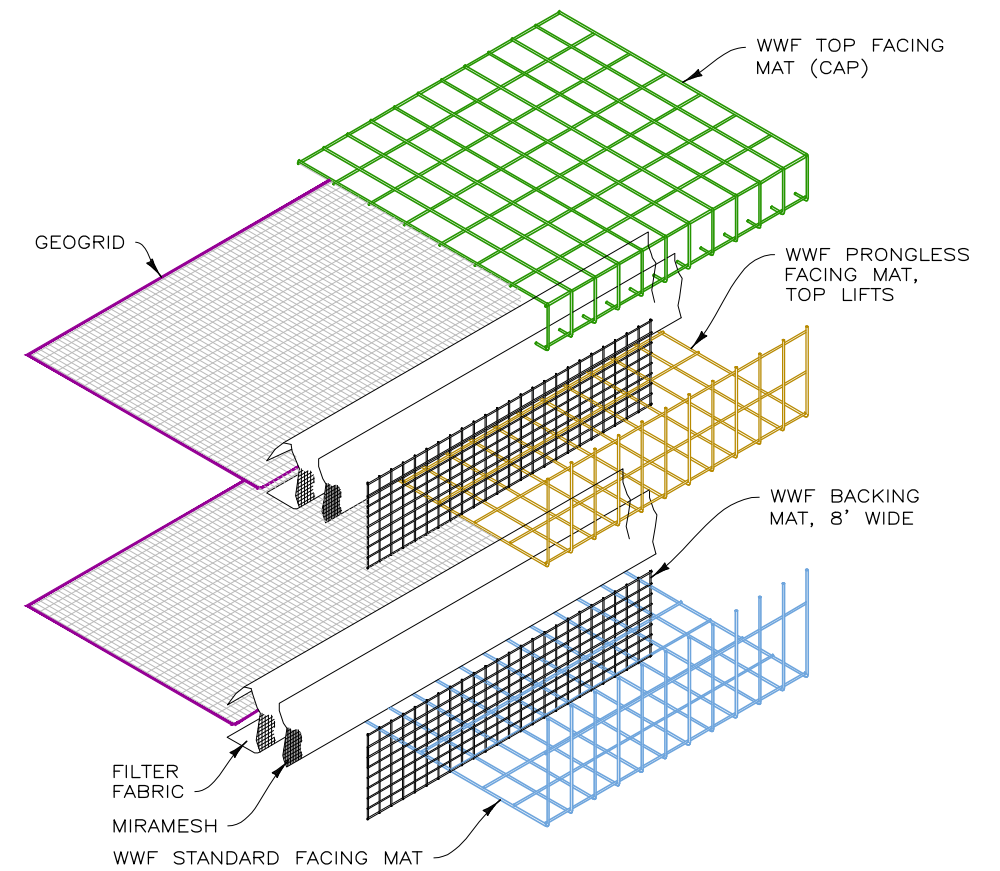
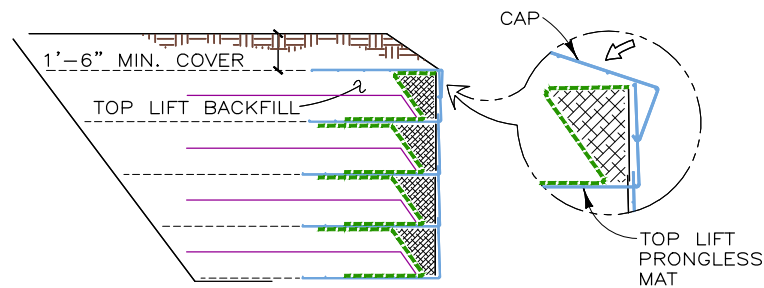

**WALL COMPONENTS**  
NOT TO SCALE

**CONSTRUCTION SEQUENCE - VEGETATIVE FACE**  
NOT TO SCALE

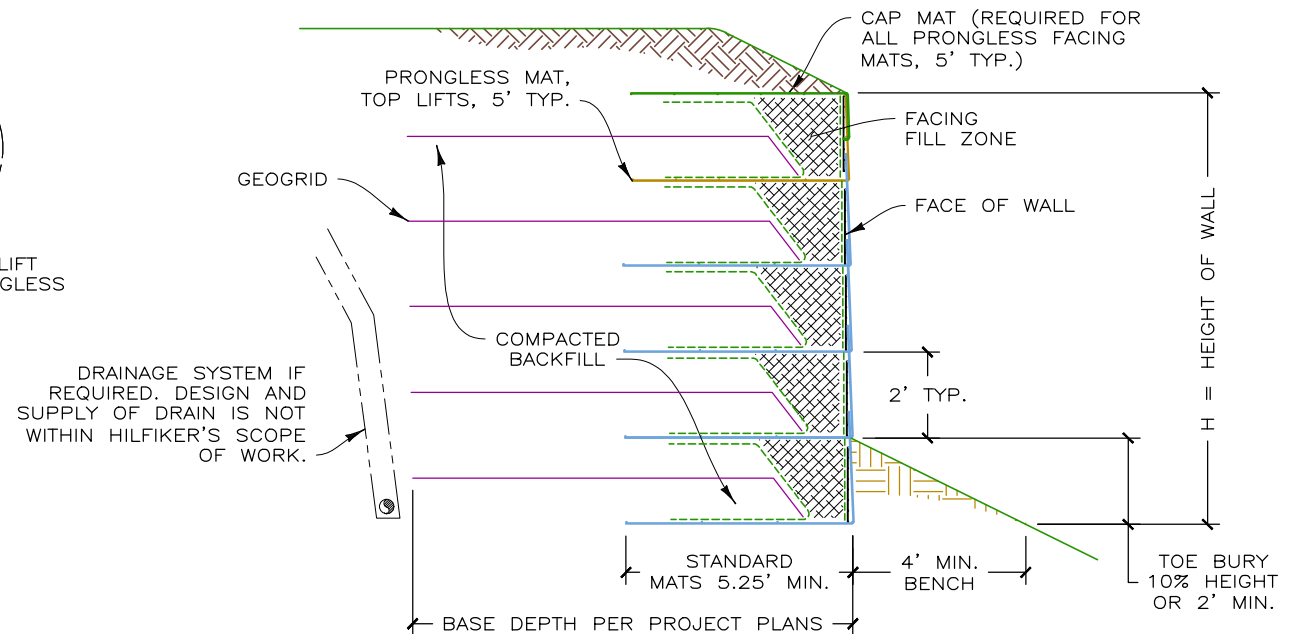

**TYPICAL SECTION - VEGETATIVE FACED GEOGRID WALL**  
NOT TO SCALE

CAD: W:\PRODUCT INFO\1. DRAWINGS\1D DETAILS\WWF STANDARD DWGS.DWG

THIS DRAWING IS FURNISHED SOLELY FOR THE USE OF OR IN CONNECTION WITH THIS PROJECT AND THE PROPRIETARY INFORMATION SHOWN HEREON IS NOT TO BE TRANSMITTED TO ANY OTHER ORGANIZATION WITHOUT SPECIFIC AUTHORIZATION BY THE HILFIKER COMPANY. HILFIKER RETAINING WALLS ARE PROTECTED BY ONE OR MORE OF THE FOLLOWING PATENTS: 243,613; 243,697; 288,616; 4,117,686; 4,329,089; 4,324,508; 4,391,557; 4,505,621; 4,343,318; 4,661,023; 4,856,939; 4,929,125; 5,076,735; 5,647,695; 5,722,799; 5,733,072; 6,357,970B1; 6,874,975B2; 7,033,118B2; AND OTHERS. OTHER PATENTS PENDING (2008)

| REV. NO. | DATE | BY | DESCRIPTION |
|----------|------|----|-------------|
|          |      |    |             |
|          |      |    |             |
|          |      |    |             |

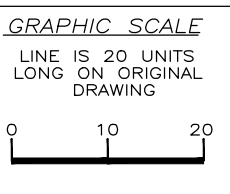

PROJ. MGR.  
DRAWN BY HRW  
REVIEWED BY HRW

**HILFIKER RETAINING WALLS**

1902 Hilfiker Lane  
Eureka, CA 95503-5711  
TOLL-FREE 800.762.8962  
PH 707.443.5093 FAX 707.443.2891  
WEBSITE www.hilfiker.com E-MAIL info@hilfiker.com

SINCE 1902 QUALITY PRODUCTS

DWG DATE OCT 2021  
REVISION DATE  
SCALE NOTED

STANDARD DRAWING  
WELDED WIRE FACING SYSTEM WITH GEOGRID REINF.  
**VEGETATIVE FACE RETAINING WALL SYSTEM**  
STANDARD DETAILS

PROJECT NO. --  
SHEET **3** OF 3

**STEP 1**  
PLACE THE FIRST COURSE OF FACING MATS ON PREPARED FOUNDATION.

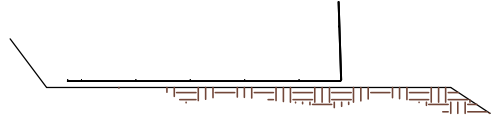

**STEP 2**  
PLACE THE BACKING MAT AND MIRAMESH AGAINST THE INSIDE FACE OF THE FACING MAT. CLIP THE SECOND-TO-TOP TRANSVERSE WIRE ON THE BACKING MAT TO THE TOP TRANSVERSE WIRE ON THE FACING MAT.

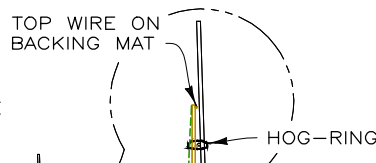

**STEP 3**  
PLACE AND COMPACT FIRST COURSE BACKFILL.  
PLACE GEOGRID AS SHOWN.

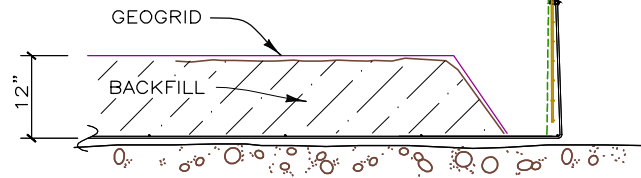

**STEP 4**  
PLACE AND COMPACT SECOND COURSE BACKFILL.  
BRING THE FILTER FABRIC OVER THE FRONT AND TOP OF THE BACKFILL AS SHOWN. PLACE THE SOIL IN THE FACE OF THE WALL PER PROJECT PLANS. LEAVE A VOID AS SHOWN.

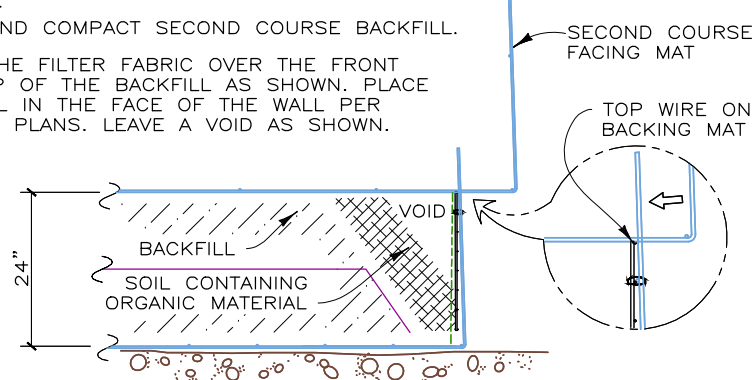

**CONSTRUCTION SEQUENCE - VEGETATIVE FACE**  
NOT TO SCALE

**STEP 4**  
HOOK THE BOTTOM TRANSVERSE WIRE OF THE BACKING MAT OVER THE VERTICAL PRONGS ON THE LOWER MAT. ROTATE THE BACKING MAT TO VERTICAL AND CLIP THE SECOND-TO-TOP TRANSVERSE WIRE ON THE BACKING MAT AND THE MIRAMESH TO THE TOP WIRE ON THE FACING MAT.

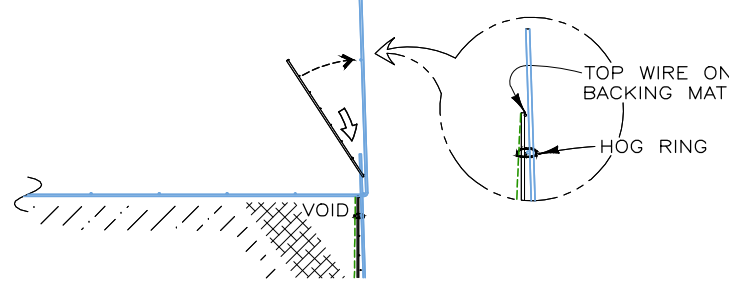

**STEP 5**  
INSTALL GEOGRID AS IN STEPS 2-4. PLACE AND COMPACT THE BACKFILL AND SOIL TO THE BASE ELEVATION OF THE NEXT MAT. REPEAT STEPS 2 THROUGH 5 TO THE TOP LIFT.

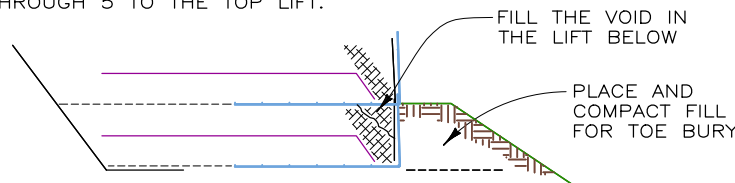

**STEP 6: TOP LIFT**  
PLACE THE TOP LIFT PRONGLESS MAT, BACKING MAT, MIRAMESH, AND GEOGRID. PLACE AND COMPACT BACKFILL AND SOIL IN THE TOP LIFT. HOOK FOLD THE TOP TAIL OF THE FILTER FABRIC OVER THE SOIL IN THE FACE TO PREVENT FINES FROM MIGRATING. HOOK THE CAP OVER THE MIDDLE TRANSVERSE WIRE ON THE PRONGLESS MAT, AND ROTATE INTO PLACE. PLACE AND COMPACT COVER OVER TOP MAT TO 1'-6" MINIMUM DEPTH.

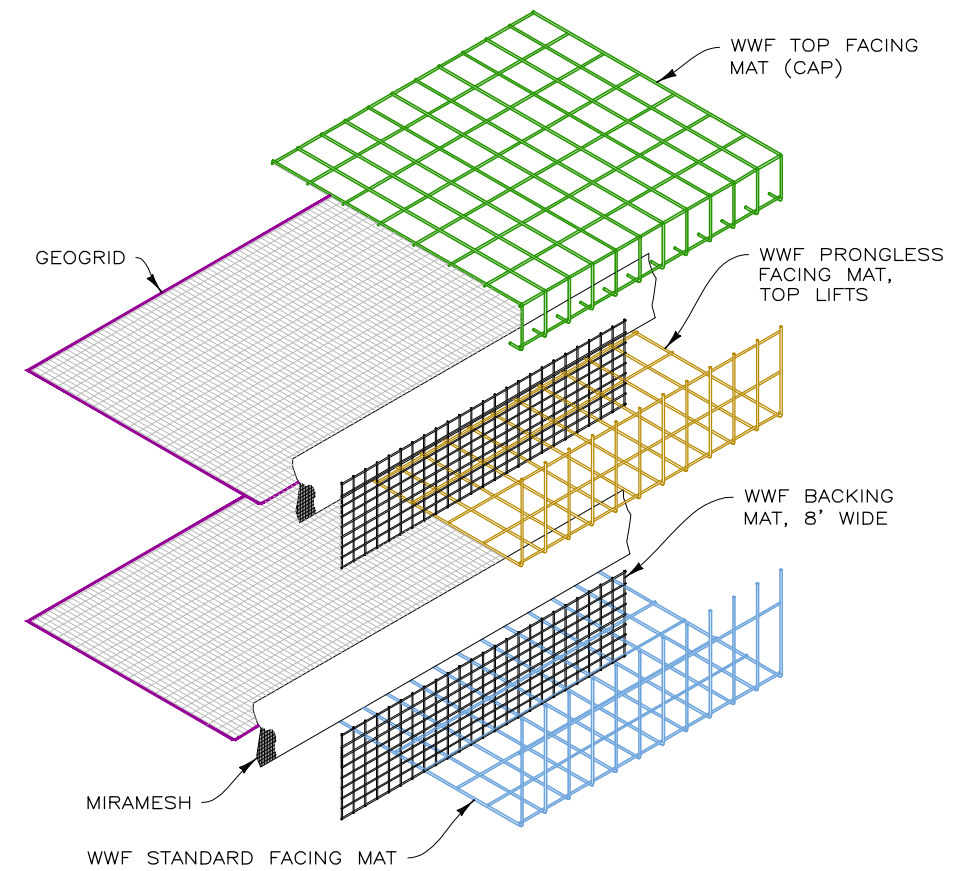
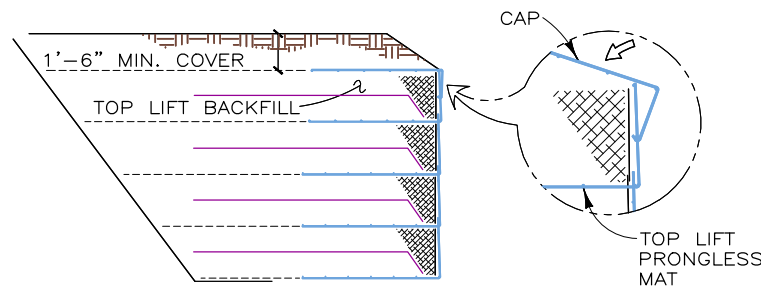

**WALL COMPONENTS**  
NOT TO SCALE

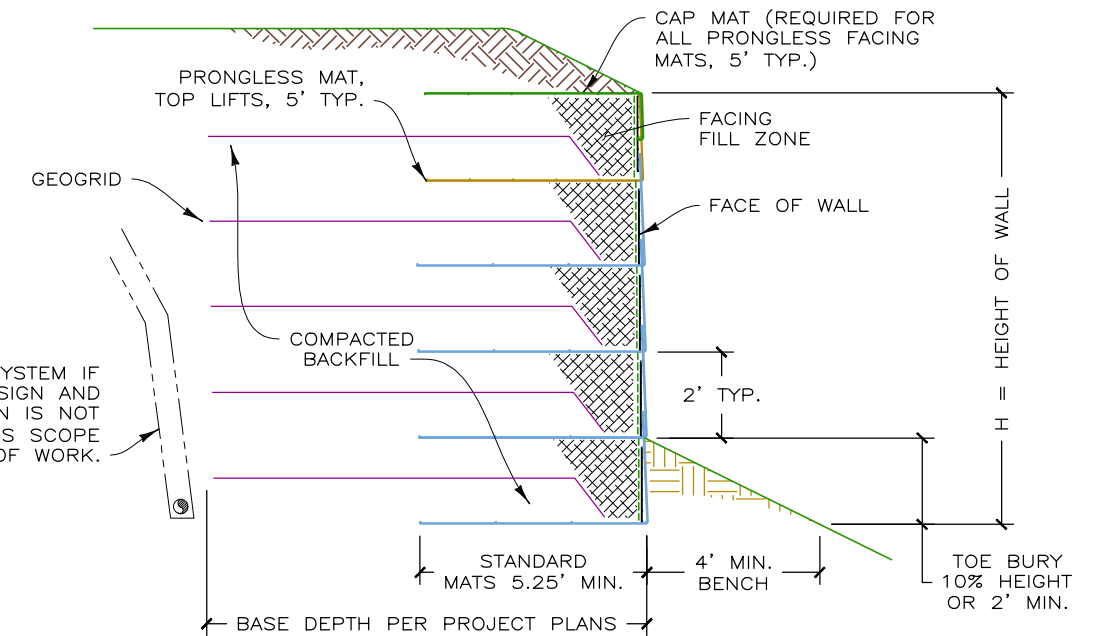

**TYPICAL SECTION - VEGETATIVE FACED GEOGRID WALL**  
NOT TO SCALE

CAD: W:\PRODUCT INFO\1. DRAWINGS\1D DETAILS\WWF STANDARD DWGS.DWG

THIS DRAWING IS FURNISHED SOLELY FOR THE USE OF OR IN CONNECTION WITH THIS PROJECT AND THE PROPRIETARY INFORMATION SHOWN HEREON IS NOT TO BE TRANSMITTED TO ANY OTHER ORGANIZATION WITHOUT SPECIFIC AUTHORIZATION BY THE HILFIKER COMPANY. HILFIKER RETAINING WALLS ARE PROTECTED BY ONE OR MORE OF THE FOLLOWING PATENTS: 243,613; 243,697; 288,616; 4,117,686; 4,329,089; 4,324,508; 4,391,557; 4,505,621; 4,343,318; 4,661,023; 4,856,939; 4,929,125; 5,076,735; 5,647,695; 5,722,799; 5,733,072; 6,357,970B1; 6,874,975B2; 7,033,118B2; AND OTHERS. OTHER PATENTS PENDING (2008)

| REV. NO. | DATE | BY | DESCRIPTION |
|----------|------|----|-------------|
|          |      |    |             |
|          |      |    |             |
|          |      |    |             |

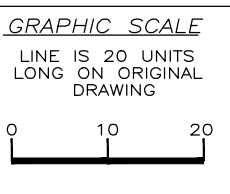

PROJ. MGR.  
DRAWN BY HRW  
REVIEWED BY HRW

**HILFIKER RETAINING WALLS**

1902 Hilfiker Lane  
Eureka, CA 95503-5711  
TOLL-FREE 800.762.8962  
PH 707.443.5093 FAX 707.443.2891  
WEBSITE www.hilfiker.com E-MAIL info@hilfiker.com

SINCE 1902 QUALITY PRODUCTS

DWG DATE OCT 2021  
REVISION DATE  
SCALE NOTED

|   |                |
|---|----------------|
| STANDARD DRAWING                              | PROJECT NO. -- |
| WELDED WIRE FACING SYSTEM WITH GEOGRID REINF. | SHEET 3        |
| VEGETATIVE FACE RETAINING WALL SYSTEM         | OF 3           |
| STANDARD DETAILS                              |                |