

LANDSLIDE MITIGATION Foamed Glass/Processed Backfill Mat Details

STEP 1
PLACE THE FIRST COURSE OF FACING MATS ON PREPARED FOUNDATION.
PLACE AND COMPACT FIRST COURSE BACKFILL LEAVING VOID IN FACE PER PROJECT PLANS

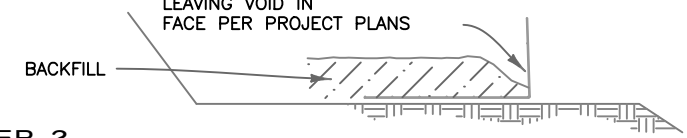

STEP 2
PLACE THE BACKING MAT, COCONUT FABRIC AND MIRAMESH AGAINST THE INSIDE FACE OF THE FACING MAT. CLIP THE TOP TRANSVERSE WIRE ON THE BACKING MAT TO THE TOP TRANSVERSE WIRE ON THE FACING MAT.
PLACE GEOGRID AS SHOWN.

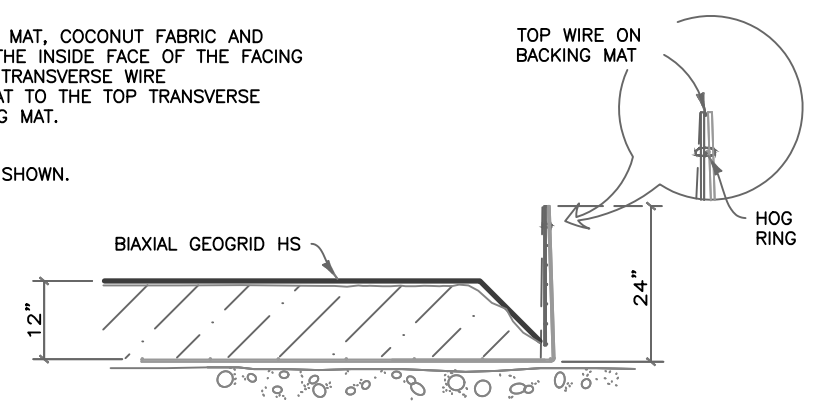

STEP 3
PLACE AND COMPACT SECOND COURSE BACKFILL

PLACE THE SECOND COURSE OF FACING MATS WITH THE BASE LONGITUDINAL WIRES RESTING ON THE TOP TRANSVERSE WIRE OF THE BACKING MAT BELOW. SLIDE THE SOIL REINFORCEMENT MAT INTO ALIGNMENT.

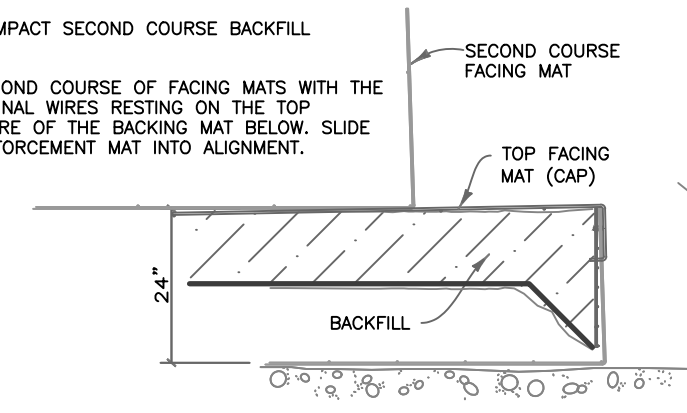

CONSTRUCTION SEQUENCE
NOT TO SCALE

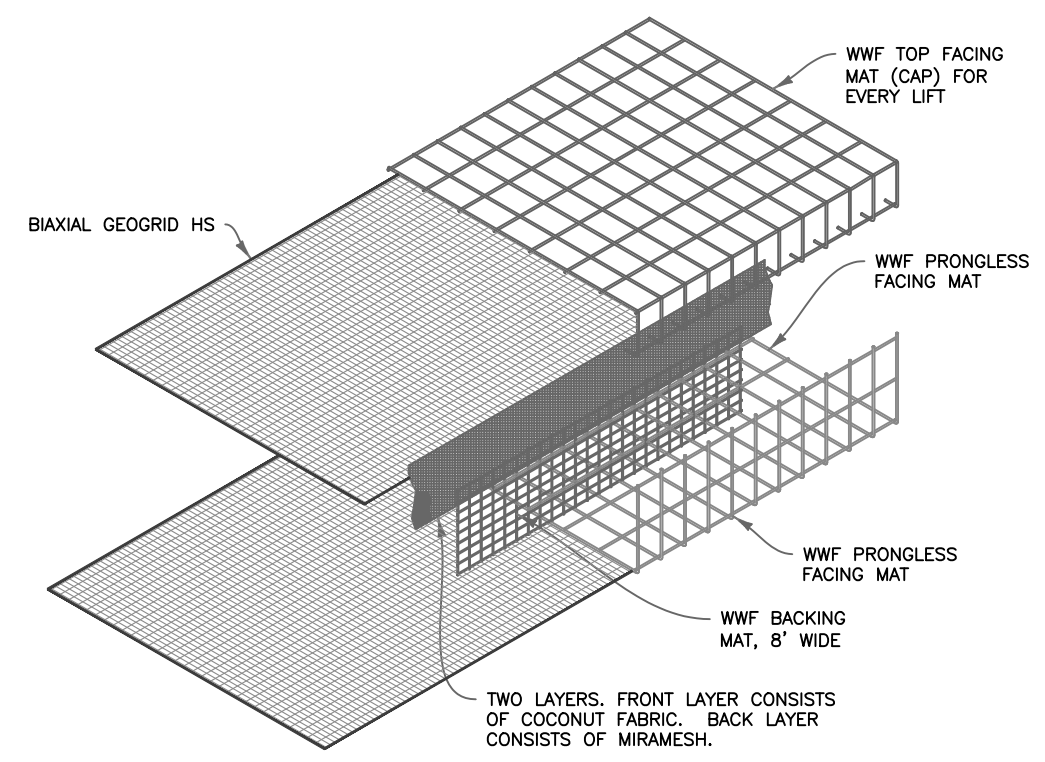

WALL COMPONENTS
NOT TO SCALE

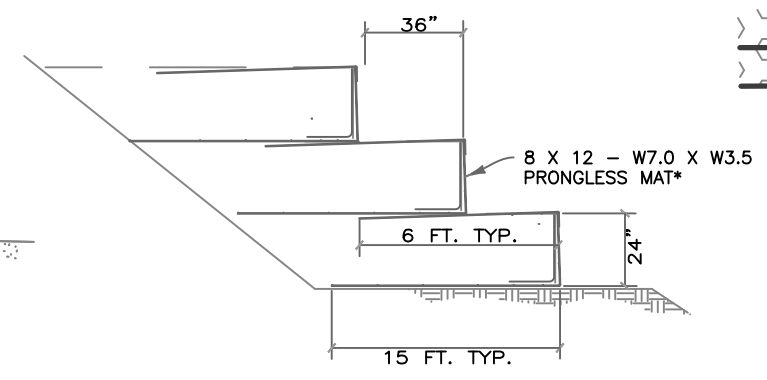

WALL COMPONENTS
NOT TO SCALE

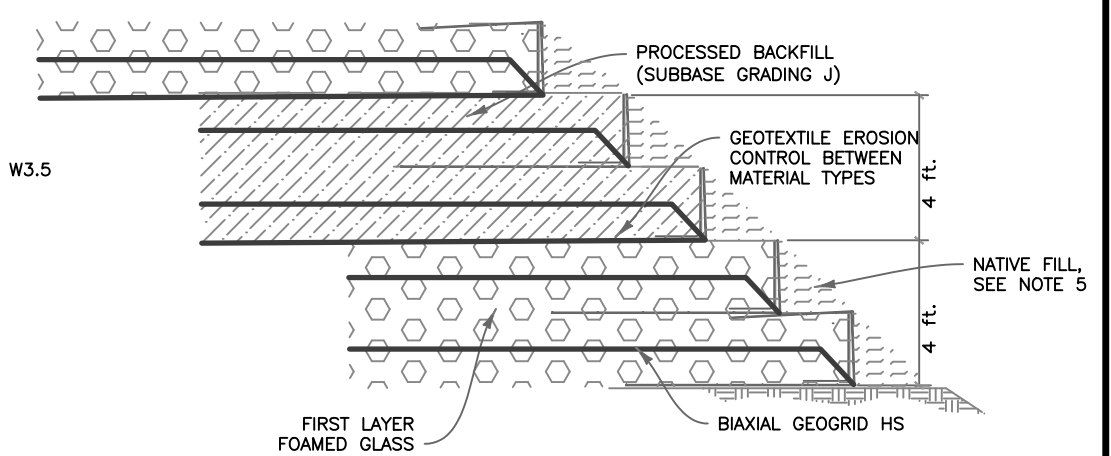

LIFT HEIGHTS
NOT TO SCALE

- NOTES:
1. PROCESSED FILL - PERFORM A MINIMUM OF FIVE (5) GRADATION TESTS PER EACH TWO (2) FOOT LIFT FOR BOTTOM SIX (6) LIFTS OF PROCESSED MATERIAL LAYERS, THEN PERFORM AT LEAST THREE (3) GRADATIONS PER EACH LIFT FOR PROCESSED MATERIALS LAYERS TO TOP OF EMBANKMENT.
 2. SEE SPECIAL PROVISIONS FOR TESTING OF FOAMED GLASS.
 3. BOTTOM TWO (2) LIFTS TO START WITH FOAMED GLASS. NEXT TWO (2) LIFTS CRUSHED BASE GRADING J AND SO FORTH ALTERNATING TO TOP.
 4. CONSTRUCTION METHOD SHOULD ADDRESS COLD WEATHER PLACEMENT PROTOCOLS TO ENSURE FROZEN PROCESSED FILL MATERIALS ARE NOT PLACED OR PLACEMENT OF PROCESSED MATERIAL CEASES.
 5. NATIVE FILL TO BE PLACED ON BASKET STEPS TO MIMIC NATURAL SLOPE. (SEE ROAD PLANS FOR PAY QUANTITIES).

NOT TO SCALE