

HILFIKER RETAINING WALLS

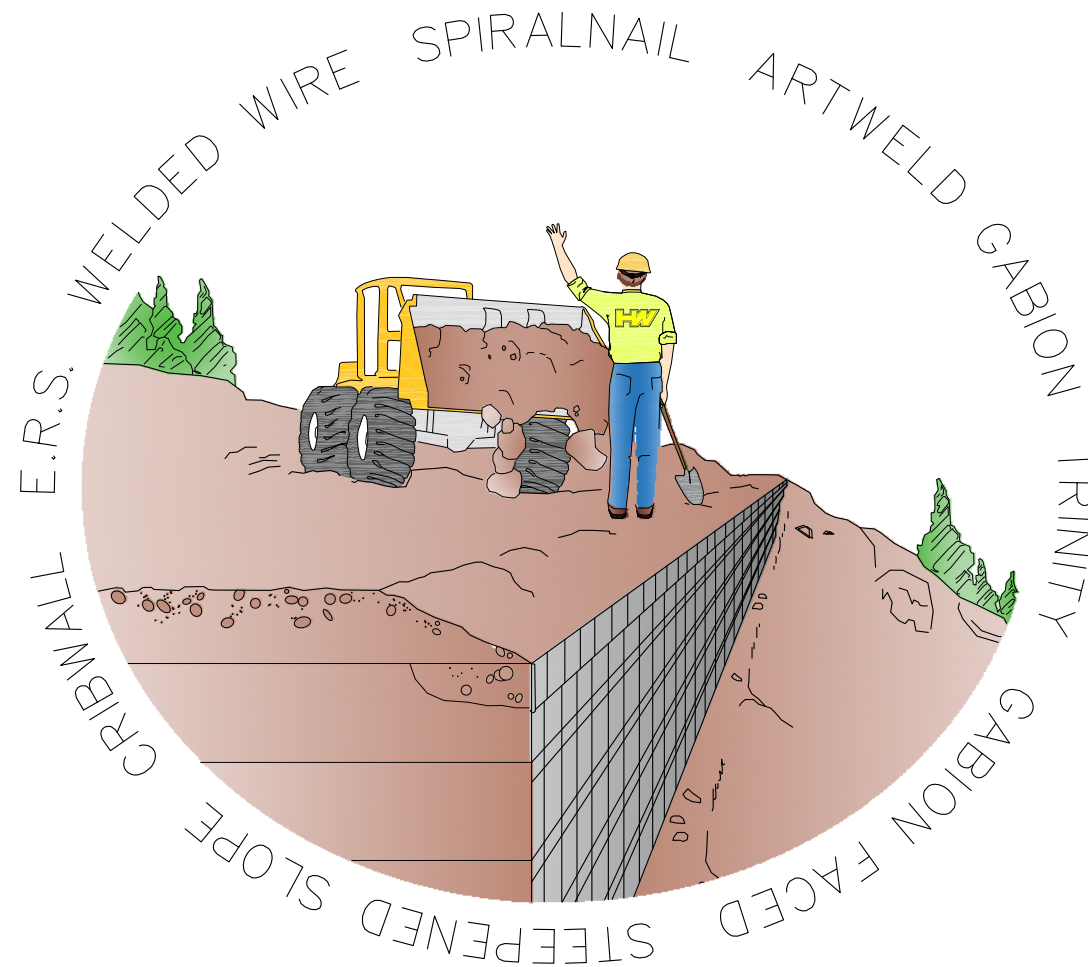

Shop Drawings



WELDED WIRE WALL

STATE HIGHWAY NO. 145A

(HRW 231019AW)

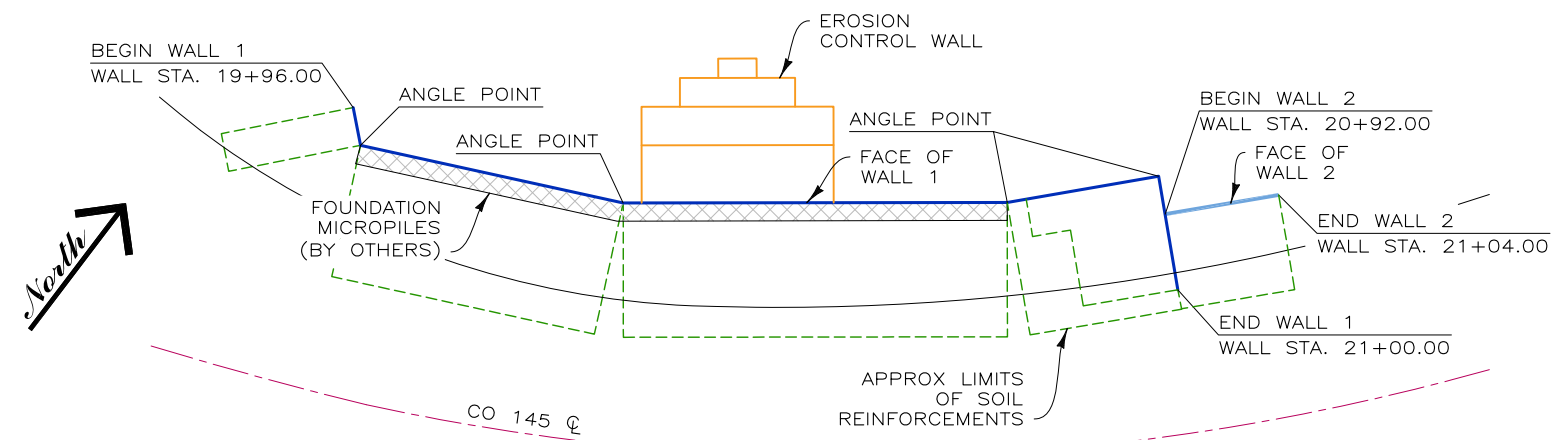

PLAN VIEW
SCALE: 1" = 20'

SUPPLIED QUANTITIES	
WALL NO.	FACE AREA
WALL 1	1,872 SQ. FT.
WALL 2	80 SQ. FT.
EROSION CONTROL WALL	112 SQ. FT.
TOTALS	2,064 SQ. FT.

	B1 8"x12" W7.0xW3.5 PRONGLESS AND CAP MATS
	B2 8"x10.5" W7.0xW3.5 STANDARD MATS
	B3 8"x21" W9.5xW4.0 STANDARD MATS

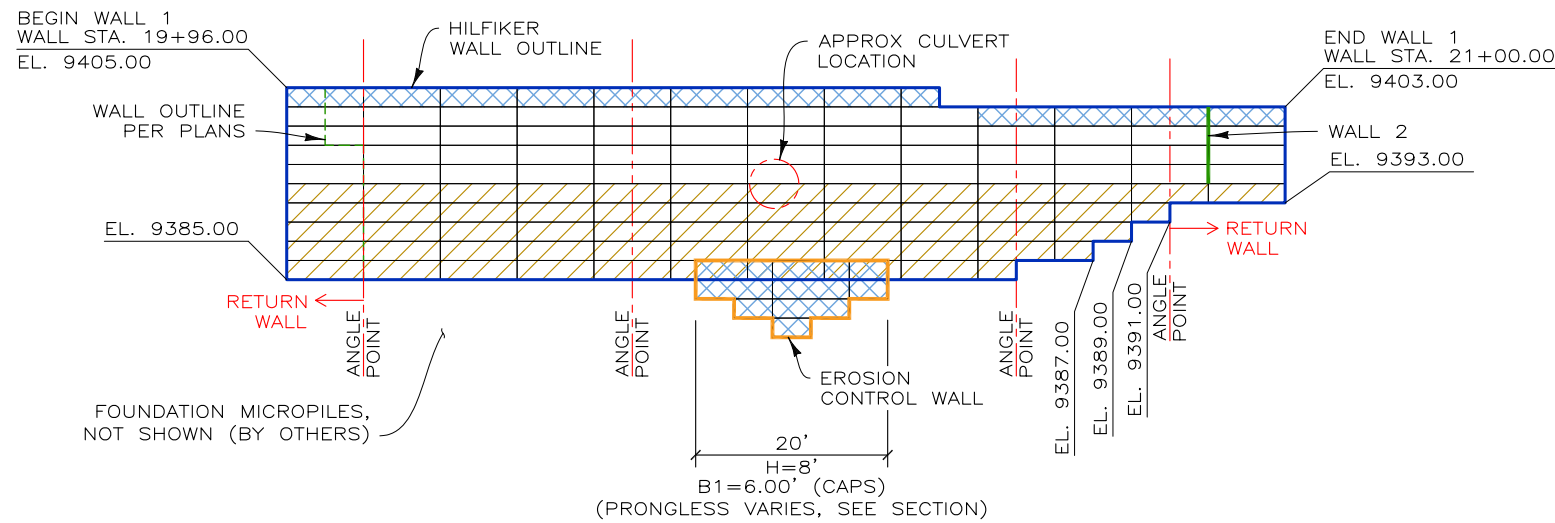
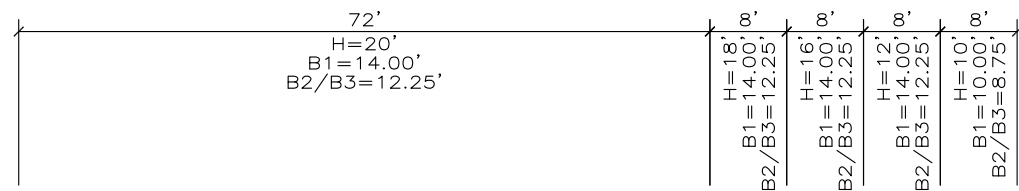

DEVELOPED ELEVATION - WALL 1
SCALE: 1" = 20' (BACK FACE)

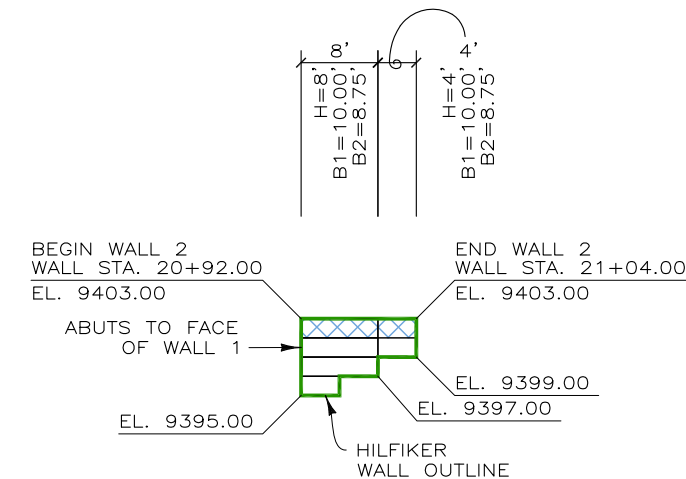

DEVELOPED ELEVATION - WALL 2
SCALE: 1" = 20' (BACK FACE)

231019AW - STATE HIGHWAY NO. 145A

THIS DRAWING IS FURNISHED SOLELY FOR THE USE OF OR IN CONNECTION WITH THIS PROJECT AND THE PROPRIETARY INFORMATION SHOWN HEREON IS NOT TO BE TRANSMITTED TO ANY OTHER ORGANIZATION WITHOUT SPECIFIC AUTHORIZATION BY THE HILFIKER COMPANY. HILFIKER RETAINING WALLS ARE PROTECTED BY ONE OR MORE OF THE FOLLOWING PATENTS: 243,613; 243,697; 288,616; 4,117,686; 4,329,089; 4,324,508; 4,391,557; 4,505,621; 4,343,318; 4,661,023; 4,856,939; 4,929,125; 5,076,735; 5,647,695; 5,722,799; 5,733,072; 6,357,970B1; 6,874,975B2; 7,033,118B2; AND OTHERS. OTHER PATENTS PENDING (2008)

REV. NO.	DATE	BY	DESCRIPTION
1	8 FEB 24	DH	SHOP DRAWINGS

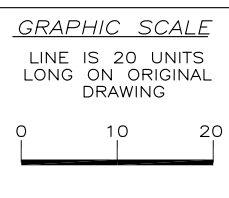

PROJ. MGR. LB
DRAWN BY DH
REVIEWED BY AH

HILFIKER RETAINING WALLS

1902 Hilfiker Lane
Eureka, CA 95503-5711
TOLL-FREE 800.762.8962
PH 707.443.5093 FAX 707.443.2891
WEBSITE www.hilfiker.com E-MAIL info@hilfiker.com

SINCE 1902
QUALITY PRODUCTS

DWG DATE 3 NOV 23
REVISION DATE 8 FEB 24
SCALE NOTED

SHOP DRAWINGS
WELDED WIRE WALL
STATE HIGHWAY NO. 145A
COLORADO DEPARTMENT OF TRANSPORTATION
SAN MIGUEL COUNTY, COLORADO
ELEVATION VIEWS

PROJECT NO. 231019AW
SHEET 1 OF 5

PROJECT-SPECIFIC NOTES:

1. REFERENCE DRAWINGS: BASED ON PROJECT PLANS FOR COLORADO DEPARTMENT OF TRANSPORTATION, NOT DATED (COVER SHEET PRINTED 10/16/2023), SHEETS 16-19, 25, AND 26.
2. BLACK AND WHITE REPRODUCTION OF THIS COLOR ORIGINAL MAY REDUCE ITS EFFECTIVENESS AND LEAD TO INCORRECT INTERPRETATION.
3. IT IS ASSUMED THAT ALL MATERIALS, BACKFILL AND CONSTRUCTION METHODS FOR HILFIKER M.S.E. WALLS WILL CONFORM TO HILFIKER'S SPECIFICATIONS AND/OR THOSE OF THE HILFIKER ENGINEERING CONSULTANT.
4. THIS IS NOT AN ENGINEERED SUBMITTAL. ALL INFORMATION HEREON IS DERIVED FROM THE REFERENCE DRAWINGS, AND IS SUBJECT TO GEOMETRIC AND GEOTECHNICAL CONFIRMATION. THE APPLICABLE HILFIKER CONSTRUCTION GUIDE AND SPECIFICATIONS ARE AN INTEGRAL PART OF THIS SUBMITTAL.
5. HILFIKER RETAINING WALLS SHALL NOT BE RESPONSIBLE FOR THE INTERNAL STABILITY OF THE RETAINING WALL, AND NOT FOR GLOBAL STABILITY OR FOUNDATION BEARING CAPACITY. THE OWNER/CONTRACTOR SHALL BE RESPONSIBLE FOR ALL JOB SITE DRAINAGE, SAFETY AND FALL PROTECTION PROVISIONS FOR WORKERS IN COMPLIANCE WITH OSHA AND ANY OTHER APPLICABLE REQUIREMENTS.
6. WALL DESIGN SHALL REQUIRE A NON-SATURATED BACKFILL. SURFACE AND SUBSURFACE DRAINAGE CONTROL MAY BE REQUIRED TO PREVENT SATURATION OF THE BACKFILL OR TO RELIEVE HYDROSTATIC PRESSURES. DRAINAGE CONTROL SHALL BE AS SPECIFIED IN THE OWNER'S PROJECT PLANS AND SPECIFICATIONS, OR AS DIRECTED BY THE OWNER'S ENGINEER.

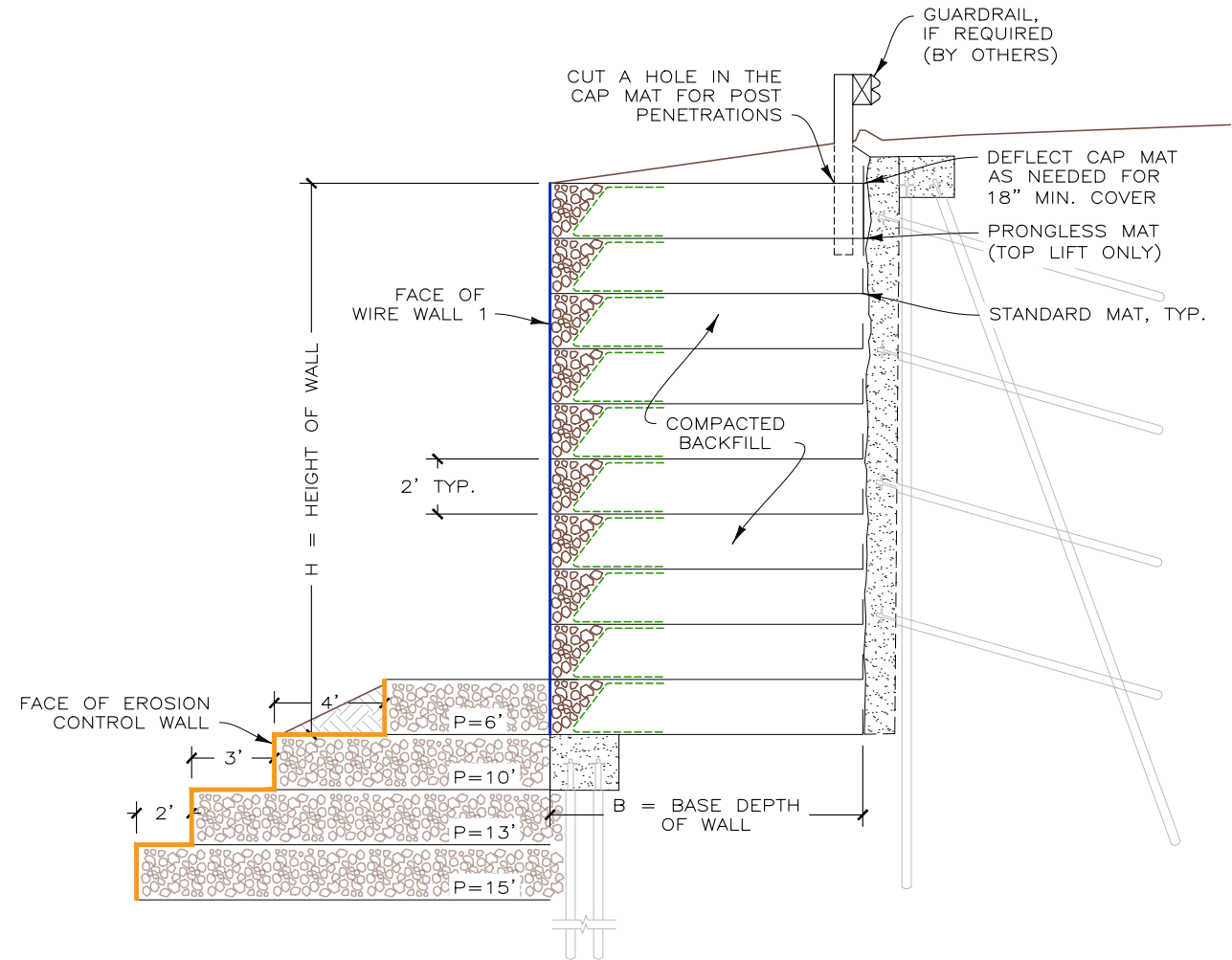

TYPICAL WELDED WIRE WALL SECTION
SCALE: 3" = 20'

231019AW—STATE HIGHWAY NO. 145A

THIS DRAWING IS FURNISHED SOLELY FOR THE USE OF OR IN CONNECTION WITH THIS PROJECT AND THE PROPRIETARY INFORMATION SHOWN HEREON IS NOT TO BE TRANSMITTED TO ANY OTHER ORGANIZATION WITHOUT SPECIFIC AUTHORIZATION BY THE HILFIKER COMPANY. HILFIKER RETAINING WALLS ARE PROTECTED BY ONE OR MORE OF THE FOLLOWING PATENTS: 243,613; 243,697; 288,616; 4,117,686; 4,329,089; 4,324,506; 4,391,557; 4,505,621; 4,343,318; 4,661,023; 4,856,939; 4,929,125; 5,076,735; 5,647,695; 5,722,799; 5,733,072; 6,357,970B1; 6,874,975B2; 7,033,118B2; AND OTHERS. OTHER PATENTS PENDING (2008)

REV.NO.	DATE	BY	DESCRIPTION
1	8 FEB 24	DH	SHOP DRAWINGS

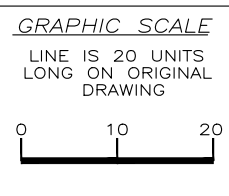

PROJ. MGR.
LB
DRAWN BY
DH
REVIEWED BY
AH

HILFIKER RETAINING WALLS

1902 HilfiKER Lane
Eureka, CA 95503-5711
TOLL-FREE 800.762.8962
PH 707.443.5093 FAX 707.443.2891
WEBSITE www.hilfiKER.com E-MAIL info@hilfiKER.com

SINCE 1902
QUALITY PRODUCTS

DWG DATE
3 NOV 23
REVISION DATE
8 FEB 24
SCALE
NOTED

SHOP DRAWINGS
WELDED WIRE WALL
STATE HIGHWAY NO. 145A
COLORADO DEPARTMENT OF TRANSPORTATION
SAN MIGUEL COUNTY, COLORADO
TYPICAL SECTION AND NOTES

PROJECT NO.
231019AW
SHEET
2
OF 5

STEP 1

PLACE THE FIRST COURSE OF SOIL REINFORCEMENT MATS ON PREPARED FOUNDATION

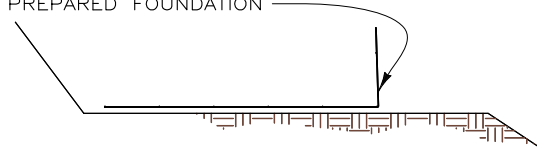

STEP 2

PLACE THE BACKING MAT AGAINST THE INSIDE FACE OF THE SOIL REINFORCEMENT MAT. CLIP THE SECOND-TO-TOP TRANSVERSE WIRE ON THE BACKING MAT TO THE TOP TRANSVERSE WIRE ON THE SOIL REINFORCEMENT MAT.

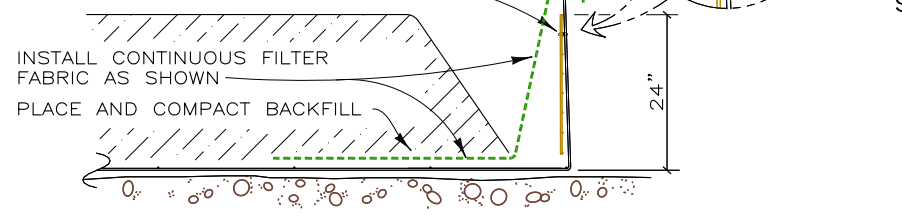

STEP 3

BRING THE FILTER FABRIC OVER THE FRONT AND TOP OF THE BACKFILL AS SHOWN. PLACE THE ROCK IN THE FACE OF THE WALL. LEAVE A VOID AS SHOWN.

PLACE THE SECOND COURSE OF SOIL REINFORCEMENT MATS WITH THE BASE LONGITUDINAL WIRES RESTING ON THE TOP TRANSVERSE WIRE OF THE BACKING MAT BELOW. SLIDE THE SOIL REINFORCEMENT MAT INTO ALIGNMENT.

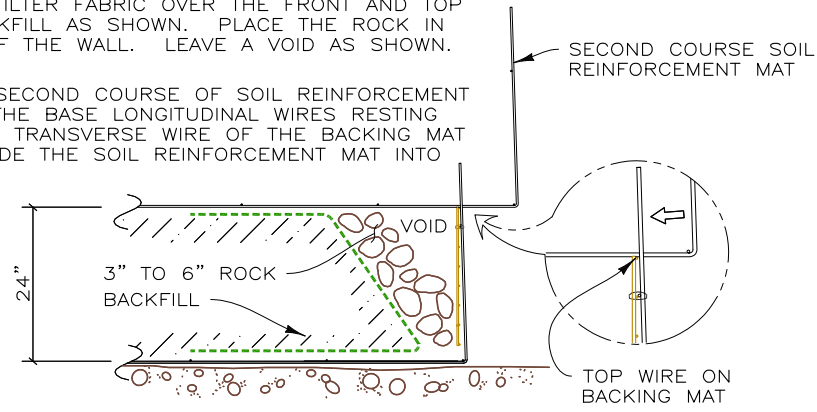

STEP 4

HOOK THE BOTTOM TRANSVERSE WIRE OF THE BACKING MAT OVER THE VERTICAL PRONGS ON THE LOWER MAT. ROTATE THE BACKING MAT TO VERTICAL AND CLIP THE SECOND-TO-TOP TRANSVERSE WIRE ON THE BACKING MAT TO THE TOP WIRE ON THE SOIL REINFORCEMENT MAT.

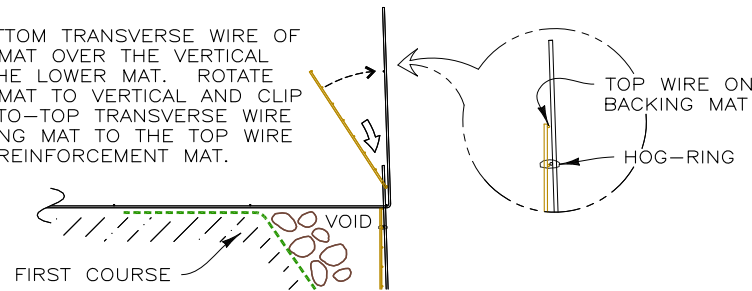

STEP 5

INSTALL THE FILTER FABRIC AS IN STEPS 2 AND 3. PLACE AND COMPACT THE BACKFILL AND ROCK TO THE BASE ELEVATION OF THE NEXT MAT. REPEAT STEPS 2 THROUGH 5 TO THE TOP LIFT.

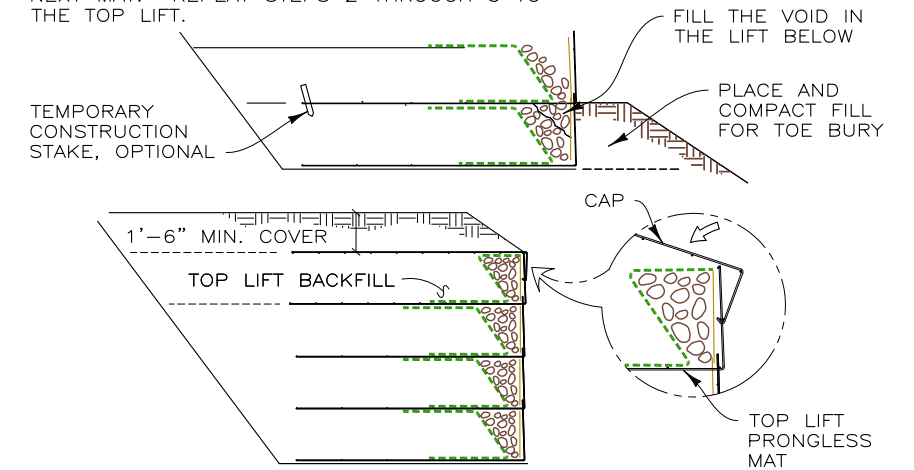

STEP 6: TOP LIFT

PLACE THE TOP LIFT PRONGLESS MAT, BACKING MAT AND FILTER FABRIC. PLACE AND COMPACT BACKFILL AND ROCK IN THE TOP LIFT. FOLD THE TOP TAIL OF THE FILTER FABRIC OVER THE ROCK IN THE FACE TO PREVENT FINES FROM MIGRATING. HOOK THE CAP OVER THE MIDDLE TRANSVERSE WIRE ON THE PRONGLESS MAT, AND ROTATE INTO PLACE. PLACE AND COMPACT COVER OVER TOP MAT TO 1'-6" MINIMUM DEPTH.

CONSTRUCTION SEQUENCE

NOT TO SCALE

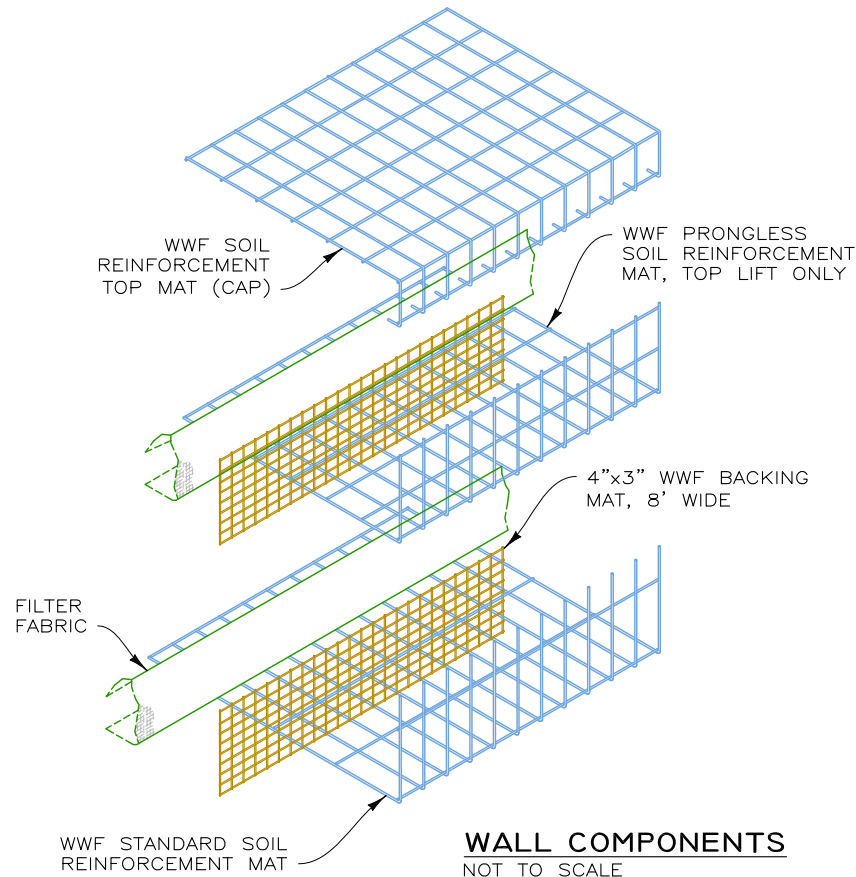

WALL COMPONENTS
NOT TO SCALE

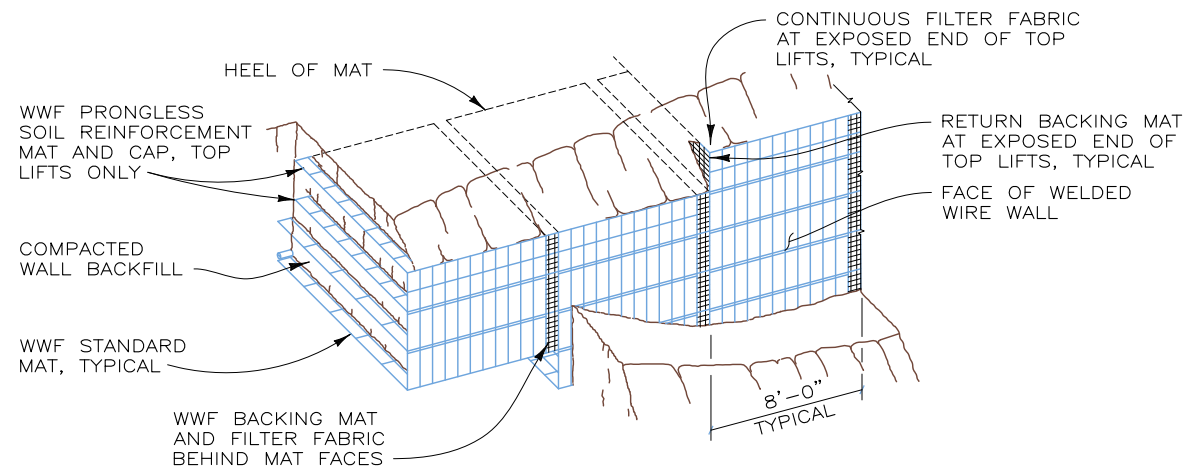

PICTORIAL ELEVATION
NOT TO SCALE

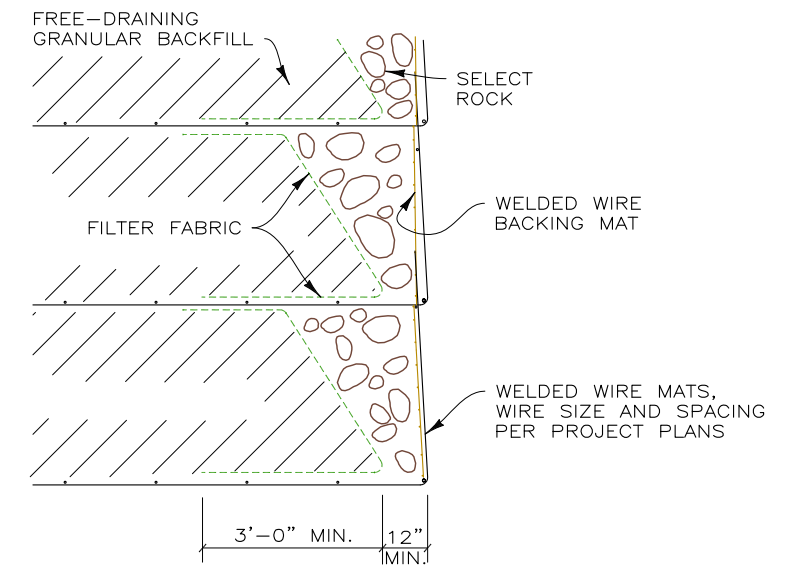

SECTION
ROCK FACING DETAIL
NOT TO SCALE

DETAILS FOR WALLS 1 AND 2

231019AW - STATE HIGHWAY NO. 145A

THIS DRAWING IS FURNISHED SOLELY FOR THE USE OF OR IN CONNECTION WITH THIS PROJECT AND THE PROPRIETARY INFORMATION SHOWN HEREON IS NOT TO BE TRANSMITTED TO ANY OTHER ORGANIZATION WITHOUT SPECIFIC AUTHORIZATION BY THE HILFIKER COMPANY. HILFIKER RETAINING WALLS ARE PROTECTED BY ONE OR MORE OF THE FOLLOWING PATENTS: 2,433,613; 2,433,697; 2,886,616; 4,117,686; 4,329,089; 4,324,506; 4,391,557; 4,505,621; 4,343,318; 4,661,023; 4,856,939; 4,929,125; 5,076,735; 5,647,695; 5,722,799; 5,733,072; 6,357,970B1; 6,874,975B2; 7,033,118B2; AND OTHERS. OTHER PATENTS PENDING (2008)

REV. NO.	DATE	BY	DESCRIPTION
1	8 FEB 24	DH	SHOP DRAWINGS

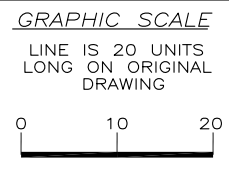

PROJ. MGR.
LB
DRAWN BY
DH
REVIEWED BY
AH

HILFIKER RETAINING WALLS

1902 Hilfiker Lane
Eureka, CA 95503-5711
TOLL-FREE 800.762.8962
PH 707.443.5093 FAX 707.443.2691
WEBSITE www.hilfiker.com E-MAIL info@hilfiker.com

DWG DATE
3 NOV 23
REVISION DATE
8 FEB 24
SCALE
NOTED

SHOP DRAWINGS
WELDED WIRE WALL
STATE HIGHWAY NO. 145A
COLORADO DEPARTMENT OF TRANSPORTATION
SAN MIGUEL COUNTY, COLORADO
CONSTRUCTION SEQUENCE AND DETAILS

PROJECT NO.
231019AW
SHEET
3
OF 5

LEGEND
(THIS DETAIL ONLY)

- P PRONGLESS MAT
- S STANDARD MAT
- STANDARD MAT

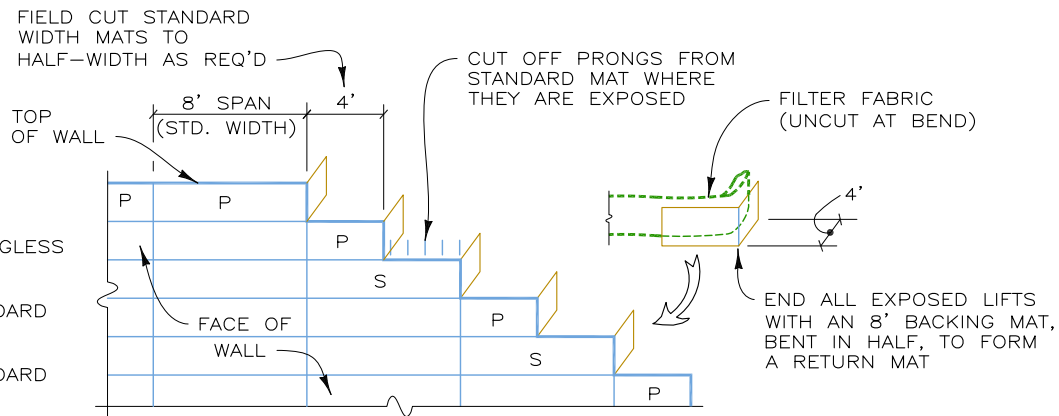

RETURN MATS AND TOP OF WALL DETAIL
NOT TO SCALE

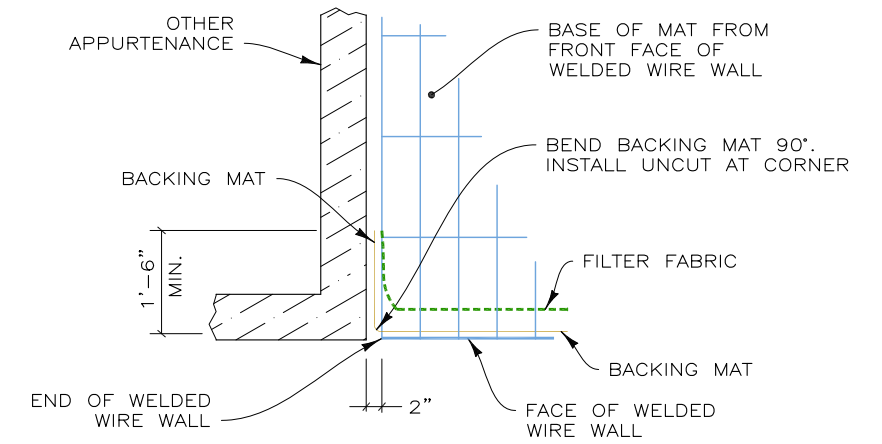

WELDED WIRE WALL END AT OTHER APPURTENANCE
NOT TO SCALE

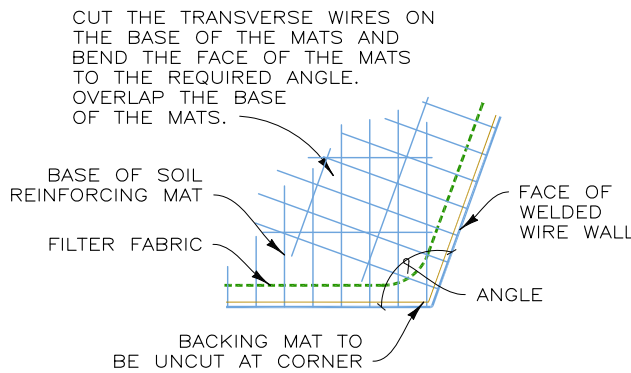

OBTUSE CONVEX ANGLE
NOT TO SCALE

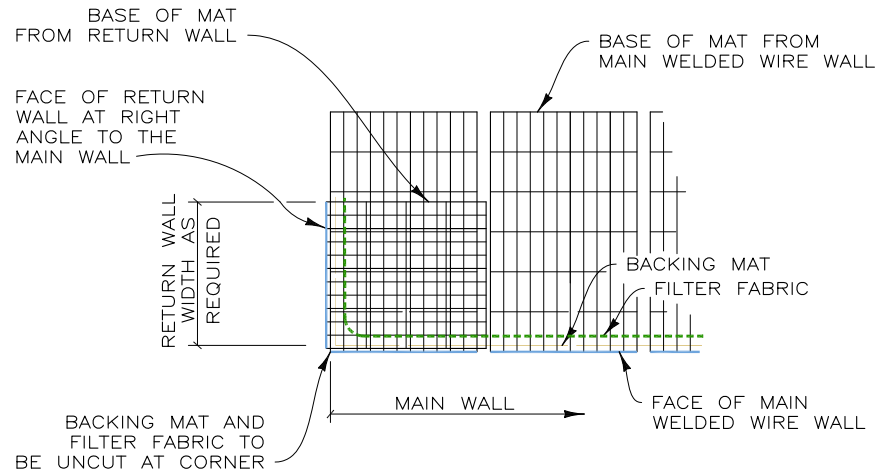

RETURN WALL DETAIL
NOT TO SCALE

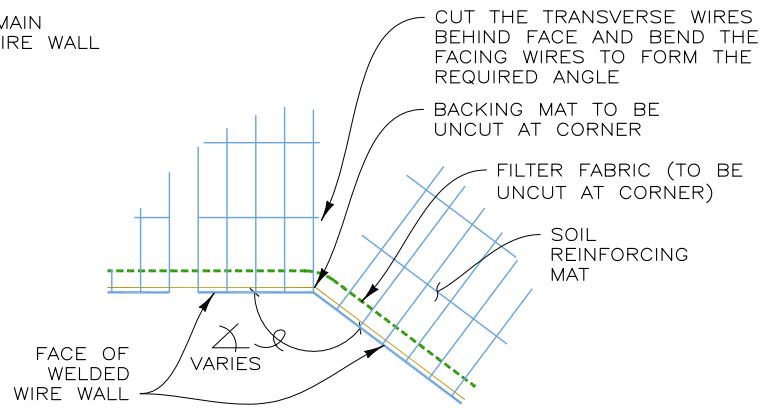

CONCAVE ANGLE DETAIL
NOT TO SCALE

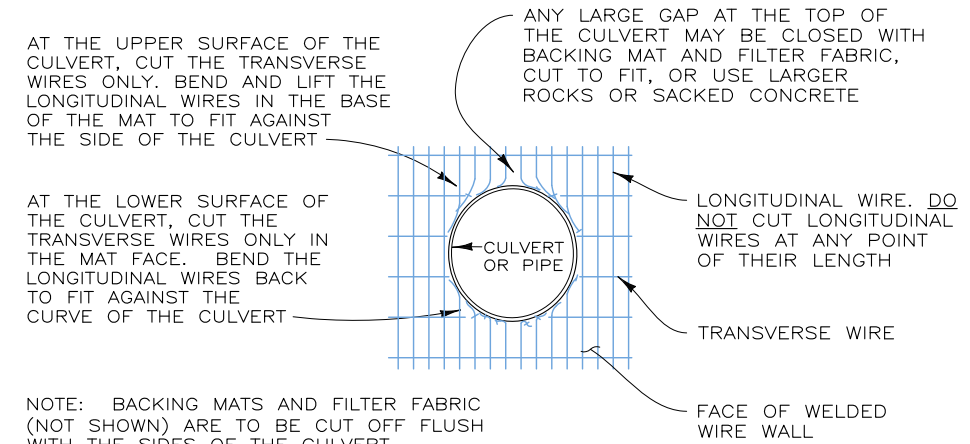

NOTE: BACKING MATS AND FILTER FABRIC (NOT SHOWN) ARE TO BE CUT OFF FLUSH WITH THE SIDES OF THE CULVERT

CULVERT THRU WALL FACE
NOT TO SCALE

DETAILS FOR WALLS 1 AND 2

THIS DRAWING IS FURNISHED SOLELY FOR THE USE OF OR IN CONNECTION WITH THIS PROJECT AND THE PROPRIETARY INFORMATION SHOWN HEREON IS NOT TO BE TRANSMITTED TO ANY OTHER ORGANIZATION WITHOUT SPECIFIC AUTHORIZATION BY THE HILFIKER COMPANY. HILFIKER RETAINING WALLS ARE PROTECTED BY ONE OR MORE OF THE FOLLOWING PATENTS: 243,613; 243,697; 288,616; 4,117,686; 4,329,089; 4,324,506; 4,391,557; 4,505,621; 4,343,318; 4,661,023; 4,856,939; 4,929,125; 5,076,735; 5,647,695; 5,722,799; 5,733,072; 6,357,970B1; 6,874,975B2; 7,033,118B2; AND OTHERS. OTHER PATENTS PENDING (2008)

REV.NO.	DATE	BY	DESCRIPTION
1	8 FEB 24	DH	SHOP DRAWINGS

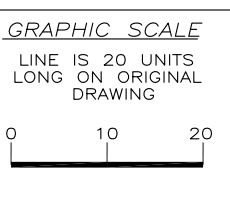

PROJ. MGR. LB
DRAWN BY DH
REVIEWED BY AH

HILFIKER RETAINING WALLS

1902 Hilfiker Lane
Eureka, CA 95503-5711
TOLL-FREE 800.762.8962
PH 707.443.5093 FAX 707.443.2691
WEBSITE www.hilfiker.com E-MAIL Info@hilfiker.com

1902
SINCE 1902
QUALITY PRODUCTS

DWG DATE 3 NOV 23
REVISION DATE 8 FEB 24
SCALE NOTED

SHOP DRAWINGS
WELDED WIRE WALL
STATE HIGHWAY NO. 145A
COLORADO DEPARTMENT OF TRANSPORTATION
SAN MIGUEL COUNTY, COLORADO
TYPICAL DETAILS

PROJECT NO. 231019AW
SHEET 4 OF 5

STEP 1

PLACE THE FIRST COURSE OF SOIL REINFORCEMENT MATS ON PREPARED FOUNDATION

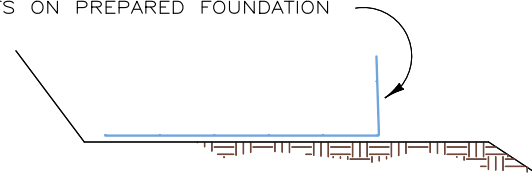

STEP 2

PLACE THE BACKING MAT AGAINST THE INSIDE FACE OF THE SOIL REINFORCEMENT MAT. CLIP THE SECOND-TO-TOP TRANSVERSE WIRE ON THE BACKING MAT TO THE TOP TRANSVERSE WIRE ON THE SOIL REINFORCEMENT MAT.

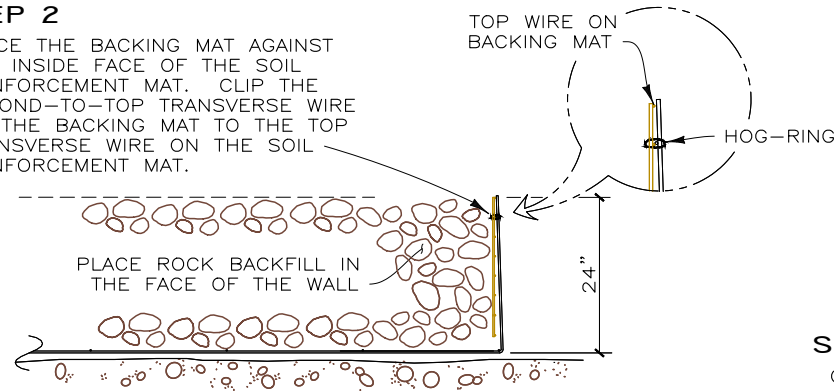

STEP 3

PLACE AND COMPACT BACKFILL AND ROCK. HOOK THE CAP OVER THE MIDDLE TRANSVERSE WIRE ON THE PRONGLESS MAT, AND ROTATE INTO PLACE.

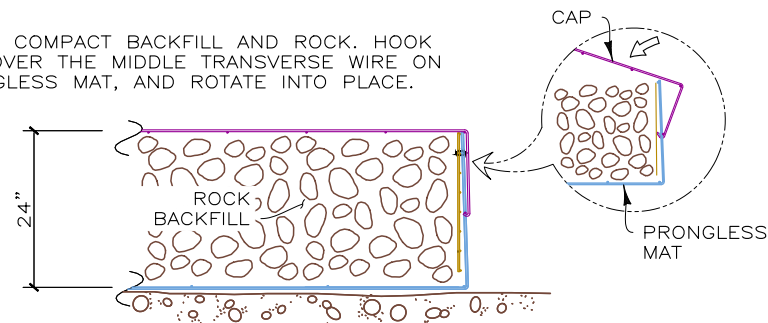

STEP 4

REPEAT STEPS 1 THROUGH 3, PLACING EACH REINFORCEMENT LIFT 24" BACK FROM THE LIFT BELOW.

PLACE ROCK MATERIAL IN FRONT OF WIRE ON THE LIFT BELOW AS REQUIRED.

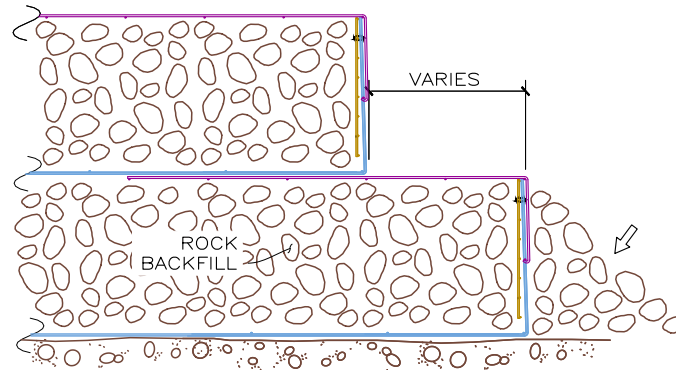

STEP 5: TOP LIFT

ONCE WALL IS TO DESIGNED HEIGHT, PLACE AND COMPACT COVER OVER TOP MAT TO 1'-6" MINIMUM DEPTH.

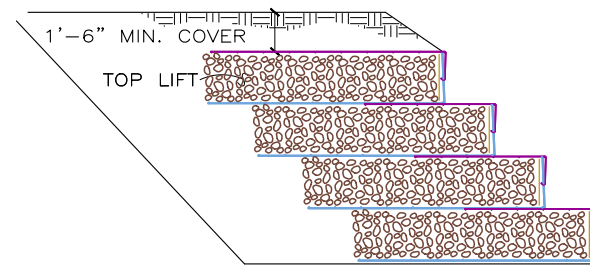

CONSTRUCTION SEQUENCE
NOT TO SCALE

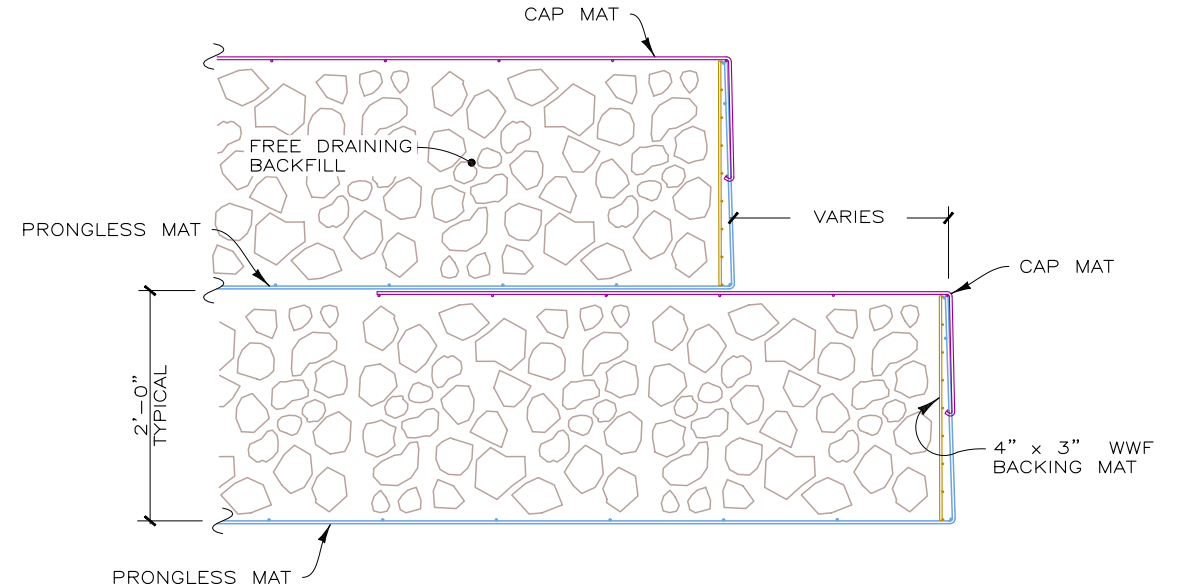

SECTION
WALL FACE DETAIL
NOT TO SCALE

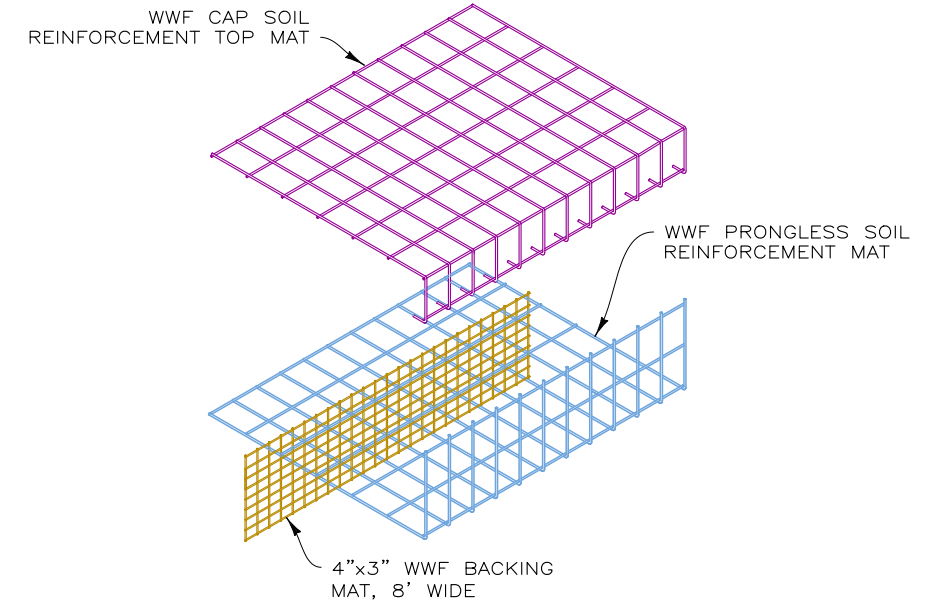

WALL COMPONENTS
NOT TO SCALE

DETAILS FOR EROSION CONTROL WALL

231019AW—STATE HIGHWAY NO. 145A

THIS DRAWING IS FURNISHED SOLELY FOR THE USE OF OR IN CONNECTION WITH THIS PROJECT AND THE PROPRIETARY INFORMATION SHOWN HEREON IS NOT TO BE TRANSMITTED TO ANY OTHER ORGANIZATION WITHOUT SPECIFIC AUTHORIZATION BY THE HILFIKER COMPANY. HILFIKER RETAINING WALLS ARE PROTECTED BY ONE OR MORE OF THE FOLLOWING PATENTS: 243,613; 243,697; 286,616; 4,117,686; 4,329,089; 4,324,508; 4,391,357; 4,505,621; 4,343,318; 4,661,023; 4,856,939; 4,929,125; 5,076,735; 5,647,695; 5,722,799; 5,733,072; 6,357,970B1; 6,874,975B2; 7,033,118B2; AND OTHERS. OTHER PATENTS PENDING (2008)

REV. NO.	DATE	BY	DESCRIPTION
1	8 FEB 24	DH	SHOP DRAWINGS

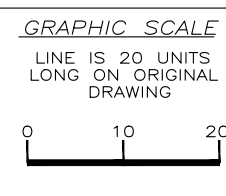

PROJ. MGR.
LB
DRAWN BY
DH
REVIEWED BY
AH

HILFIKER RETAINING WALLS

1902 Hilfiker Lane
Eureka, CA 95503-5711
TOLL-FREE 800.762.8962
PH 707.443.5093 FAX 707.443.2891
WEBSITE www.hilfiker.com E-MAIL info@hilfiker.com

SINCE 1902
QUALITY PRODUCTS

DWG DATE
3 NOV 23
REVISION DATE
8 FEB 24
SCALE
NOTED

SHOP DRAWINGS
WELDED WIRE WALL
STATE HIGHWAY NO. 145A
COLORADO DEPARTMENT OF TRANSPORTATION
SAN MIGUEL COUNTY, COLORADO
CONSTRUCTION SEQUENCE AND DETAILS

PROJECT NO.
231019AW
SHEET
5
OF 5