

160202BW LANNON QUARRY STATIONARY JAW PLANT CRUSHER

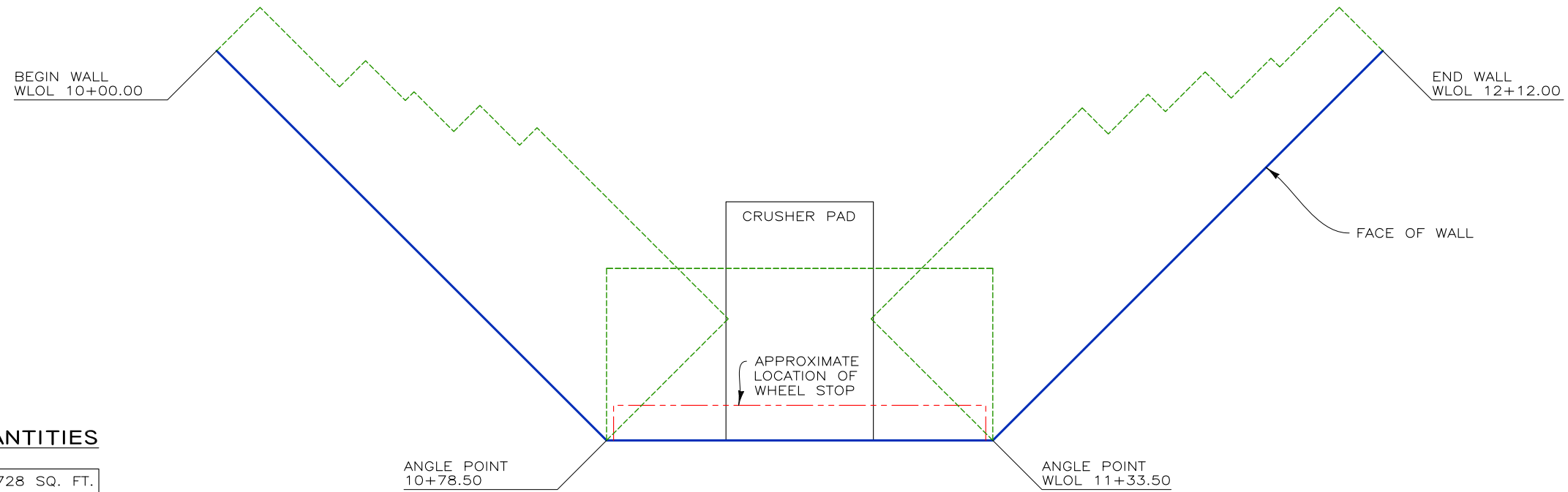

**ESTIMATED QUANTITIES**

WALL FACE AREA: 5,728 SQ. FT.

**PLAN VIEW**  
SCALE: 1" = 20'

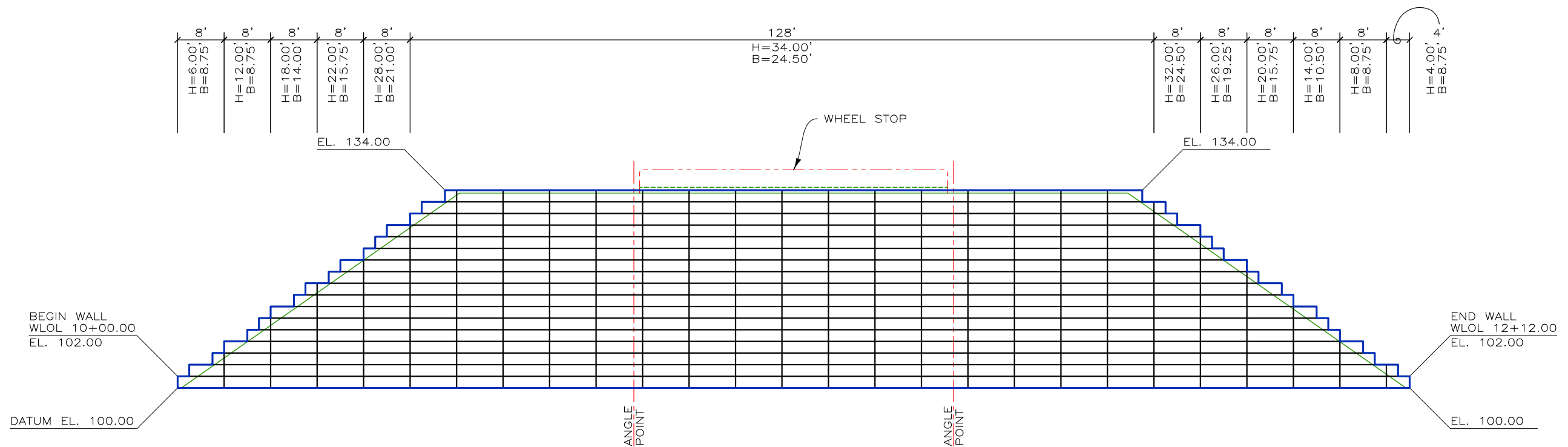

**DEVELOPED ELEVATION**  
SCALE: 1" = 20'

THIS DRAWING IS FURNISHED SOLELY FOR THE USE OF OR IN CONNECTION WITH THIS PROJECT AND THE PROPRIETARY INFORMATION SHOWN HEREON IS NOT TO BE TRANSMITTED TO ANY OTHER ORGANIZATION WITHOUT SPECIFIC AUTHORIZATION BY THE HILFIKER COMPANY. HILFIKER RETAINING WALLS ARE PROTECTED BY ONE OR MORE OF THE FOLLOWING PATENTS: 243,613; 243,697; 288,616; 4,117,686; 4,329,089; 4,324,508; 4,391,557; 4,505,621; 4,343,318; 4,661,023; 4,856,939; 4,929,125; 5,076,735; 5,647,695; 5,722,799; 5,733,072; 6,357,970B1; 6,874,975B2; 7,033,118B2; AND OTHERS. OTHER PATENTS PENDING (2008)

REV.NO.	DATE	BY	DESCRIPTION

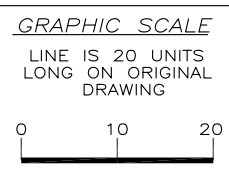

PROJ.MGR.  
SCB  
ENGINEER  
CADD BY  
AMJ

**HILFIKER RETAINING WALLS**

1902 Hilfiker Lane  
Eureka, CA 95503-5711  
TOLL-FREE 800.762.8962  
PH 707.443.5093 FAX 707.443.2891  
WEBSITE www.hilfiker.com E-MAIL info@hilfiker.com

SINCE 1902 QUALITY PRODUCTS

DWG DATE  
8 FEB 16  
REVISION DATE  
SCALE  
NOTED

**FOR BIDDING PURPOSES ONLY**

WELDED WIRE WALL  
**LANNON QUARRY STATIONARY JAW PLANT CRUSHER**  
LANNON STONE PRODUCTS LANNON, WISCONSIN  
PLAN VIEW AND DEVELOPED ELEVATION

PROJECT NO.  
160202BW  
SHEET  
**1**  
OF 3

160202BW LANNON QUARRY STATIONARY JAW PLANT CRUSHER

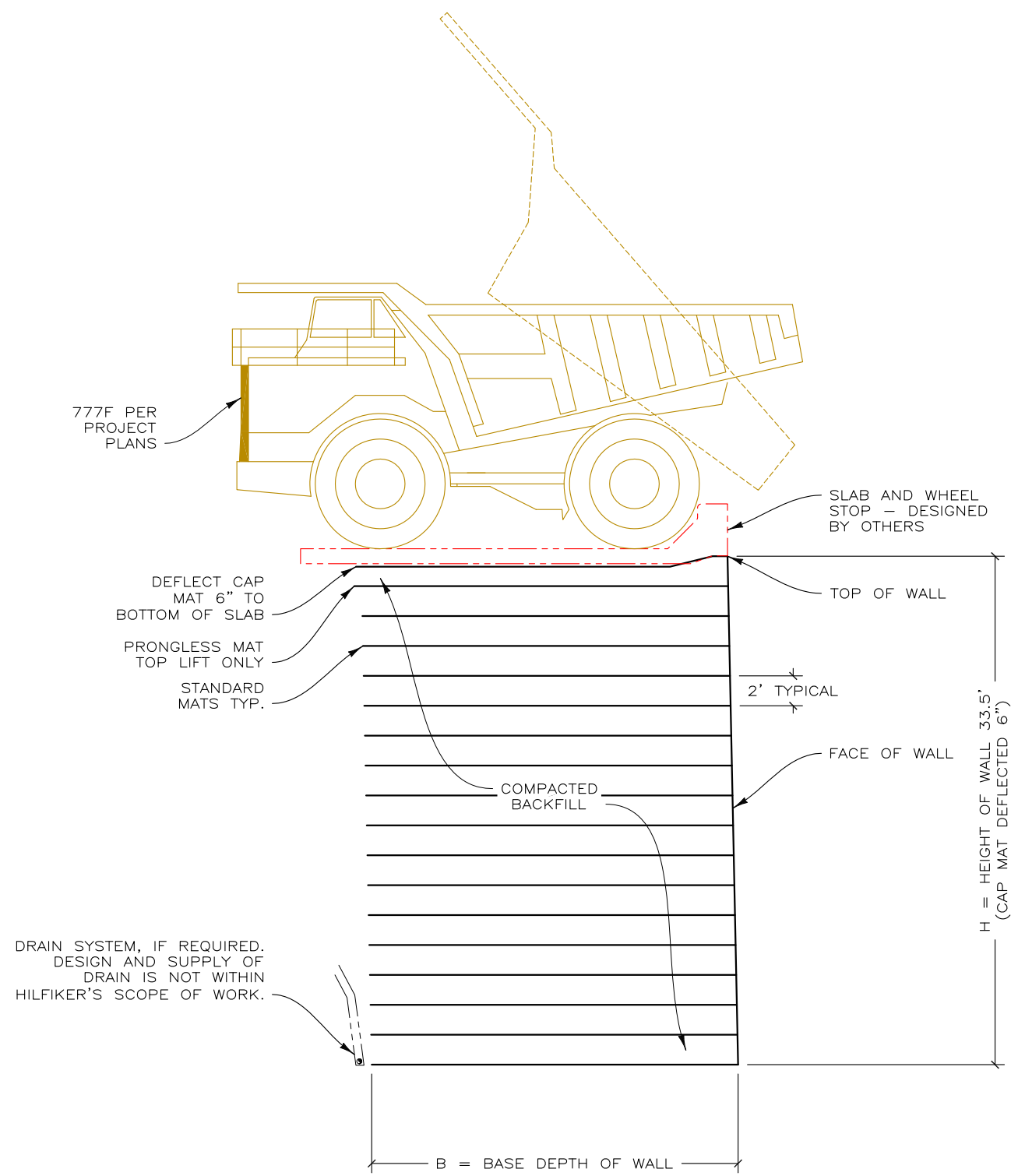

**TYPICAL SECTION**  
SCALE: 1" = 10'

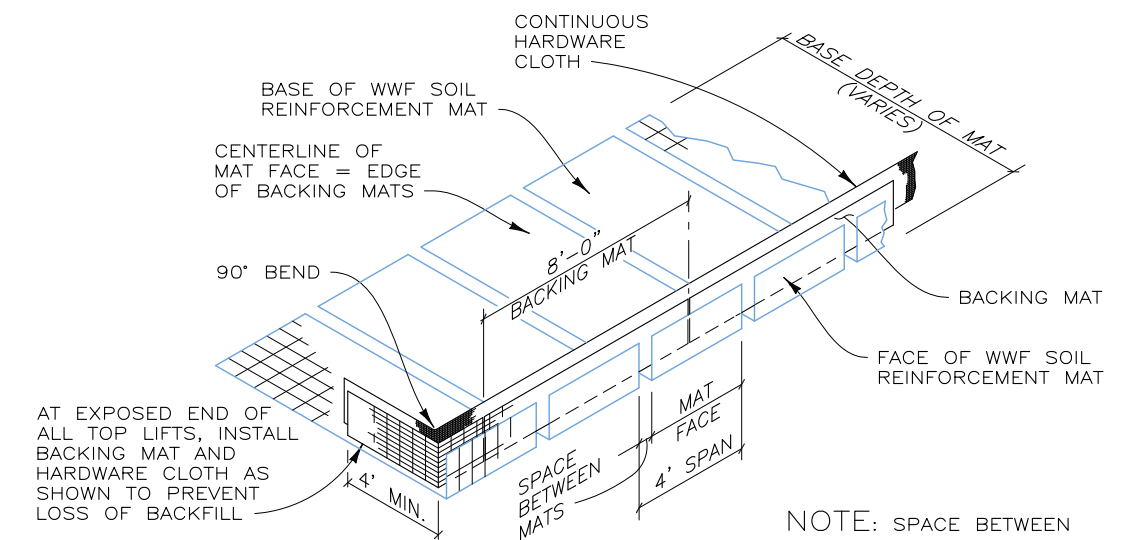
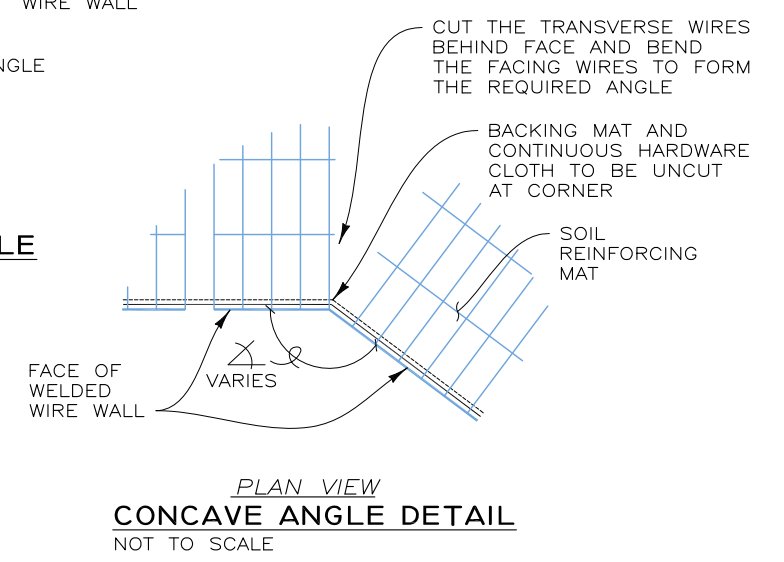
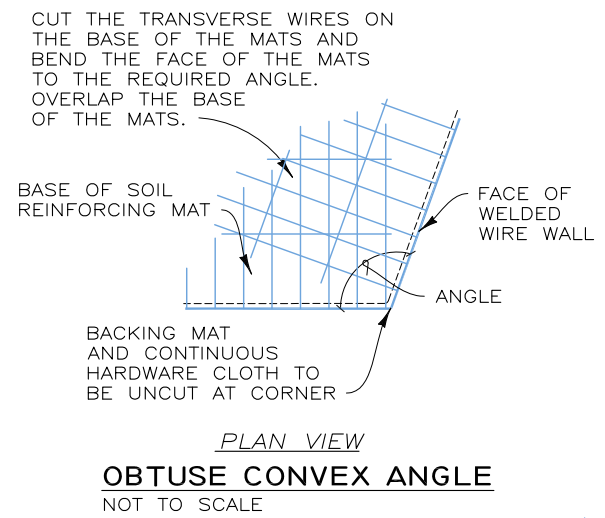

**WELDED WIRE WALL COMPONENTS WITH RETURN MAT**  
NOT TO SCALE

THIS DRAWING IS FURNISHED SOLELY FOR THE USE OF OR IN CONNECTION WITH THIS PROJECT AND THE PROPRIETARY INFORMATION SHOWN HEREON IS NOT TO BE TRANSMITTED TO ANY OTHER ORGANIZATION WITHOUT SPECIFIC AUTHORIZATION BY THE HILFIKER COMPANY. HILFIKER RETAINING WALLS ARE PROTECTED BY ONE OR MORE OF THE FOLLOWING PATENTS: 243,613; 243,697; 288,616; 4,117,686; 4,329,089; 4,324,508; 4,391,557; 4,505,621; 4,343,318; 4,661,023; 4,856,939; 4,929,125; 5,076,735; 5,647,695; 5,722,799; 5,733,072; 6,357,970B1; 6,874,975B2; 7,033,118B2; AND OTHERS. OTHER PATENTS PENDING (2008)

REV.NO.	DATE	BY	DESCRIPTION

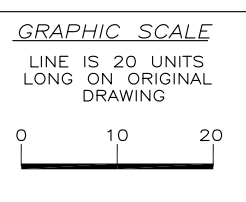

PROJ.MGR.  
SCB  
ENGINEER  
CADD BY  
AMJ

**HILFIKER RETAINING WALLS**

1902 Hilfiker Lane  
Eureka, CA 95503-5711  
TOLL-FREE 800.762.8962  
PH 707.443.5093 FAX 707.443.2891  
WEBSITE www.hilfiker.com E-MAIL Info@hilfiker.com

DWG DATE  
8 FEB 16  
REVISION DATE  
SCALE  
NOTED

**FOR BIDDING PURPOSES ONLY**

WELDED WIRE WALL  
**LANNON QUARRY STATIONARY JAW PLANT CRUSHER**

LANNON STONE PRODUCTS LANNON, WISCONSIN

TYPICAL SECTION AND DETAILS

PROJECT NO.  
160202BW  
SHEET  
**2**  
OF 3

**STEP 1**  
PLACE THE FIRST COURSE OF SOIL REINFORCEMENT MATS ON PREPARED FOUNDATION

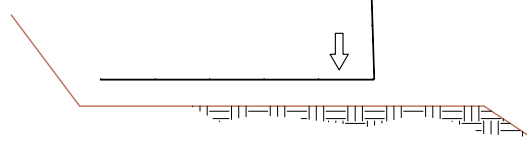

**STEP 2**  
PLACE THE BACKING MAT AGAINST THE INSIDE FACE OF THE SOIL REINFORCEMENT MAT. CLIP THE SECOND-TO-TOP TRANSVERSE WIRE ON THE BACKING MAT TO THE TOP TRANSVERSE WIRE ON THE SOIL REINFORCEMENT MAT.

INSTALL CONTINUOUS HARDWARE CLOTH, HOG-RING TO THE TOP WIRE ON THE BACKING MAT.

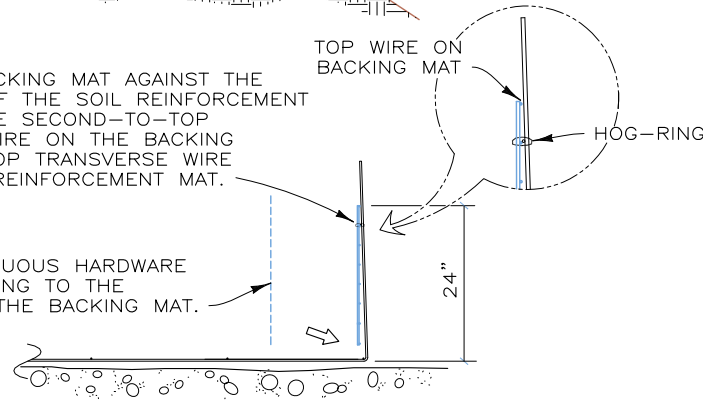

**STEP 3**  
PLACE AND COMPACT THE BACKFILL IN LAYERS AND DENSITIES AS SPECIFIED IN THE PROJECT PLANS. LEAVE A VOID AT THE FACE AS SHOWN.

PLACE THE SECOND COURSE OF SOIL REINFORCEMENT MATS WITH THE BASE LONGITUDINAL WIRES RESTING ON THE TOP TRANSVERSE WIRE OF THE BACKING MAT BELOW. SLIDE THE SOIL REINFORCEMENT MAT INTO ALIGNMENT.

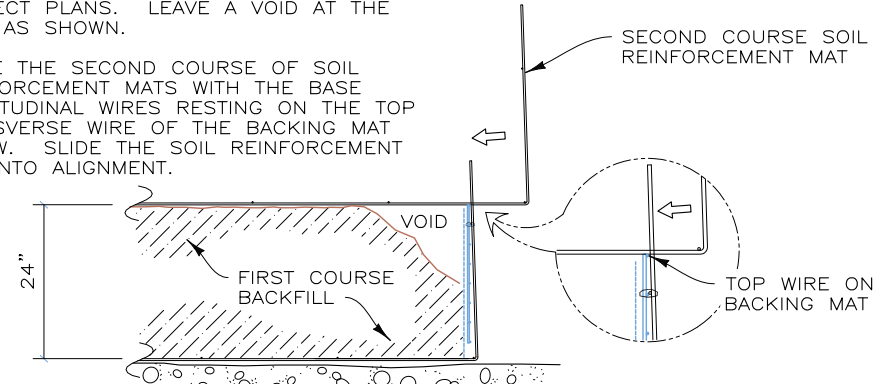

**STEP 4**  
HOOK THE BOTTOM TRANSVERSE WIRE OF THE BACKING MAT OVER THE VERTICAL PRONGS ON THE LOWER MAT. ROTATE THE BACKING MAT TO VERTICAL AND CLIP THE SECOND-TO-TOP TRANSVERSE WIRE ON THE BACKING MAT TO THE TOP WIRE ON THE SOIL REINFORCEMENT MAT.

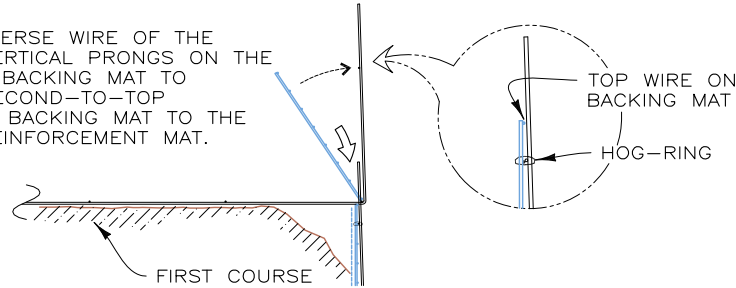

**STEP 5**  
INSTALL THE CONTINUOUS HARDWARE CLOTH. PLACE AND COMPACT THE BACKFILL TO THE BASE ELEVATION OF THE NEXT MAT. REPEAT STEPS 3 THROUGH 5 TO THE TOP LIFT.

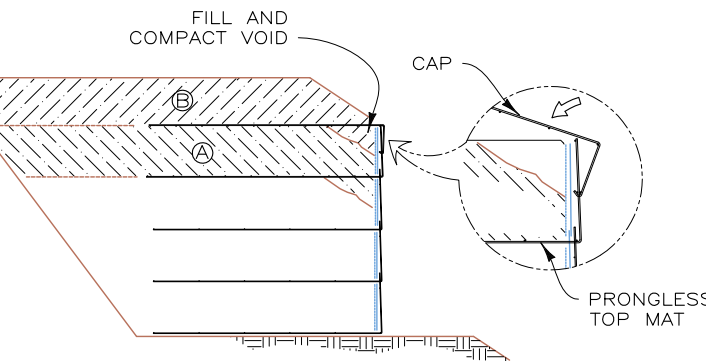
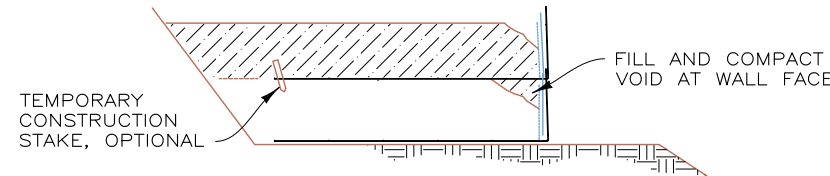

**STEP 6: TOP LIFT**  
PLACE THE TOP LIFT PRONGLESS MAT, BACKING MAT AND CONTINUOUS HARDWARE CLOTH. PLACE AND COMPACT BACKFILL IN AREA "A". HOOK THE CAP OVER THE MIDDLE TRANSVERSE WIRE ON THE PRONGLESS MAT, AND ROTATE INTO PLACE. BACKFILL "B" TO 1'-6" MIN. COVER OVER THE CAP.

**CONSTRUCTION SEQUENCE**

NOT TO SCALE

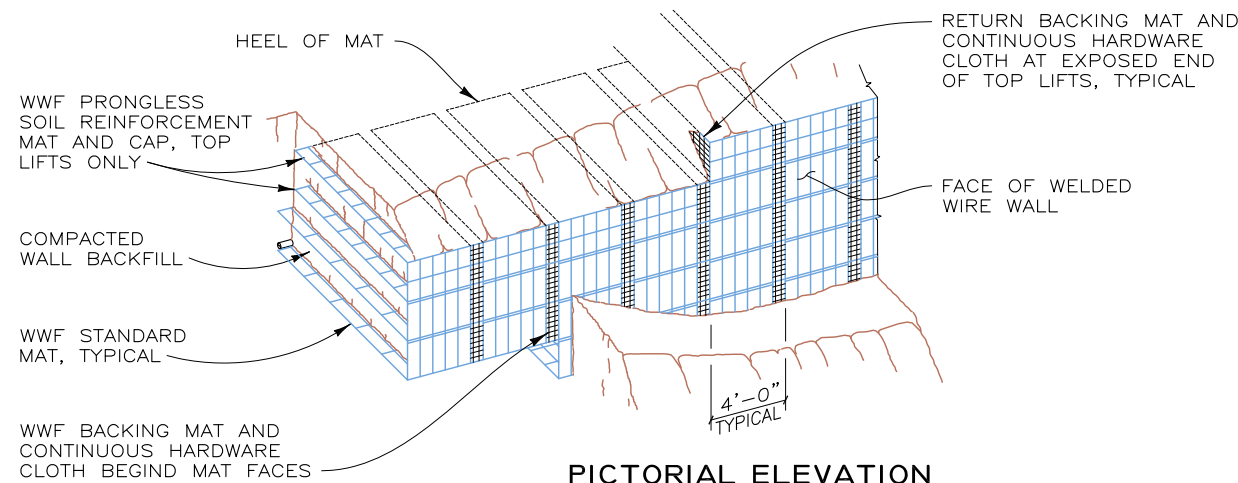

**PICTORIAL ELEVATION**

NOT TO SCALE

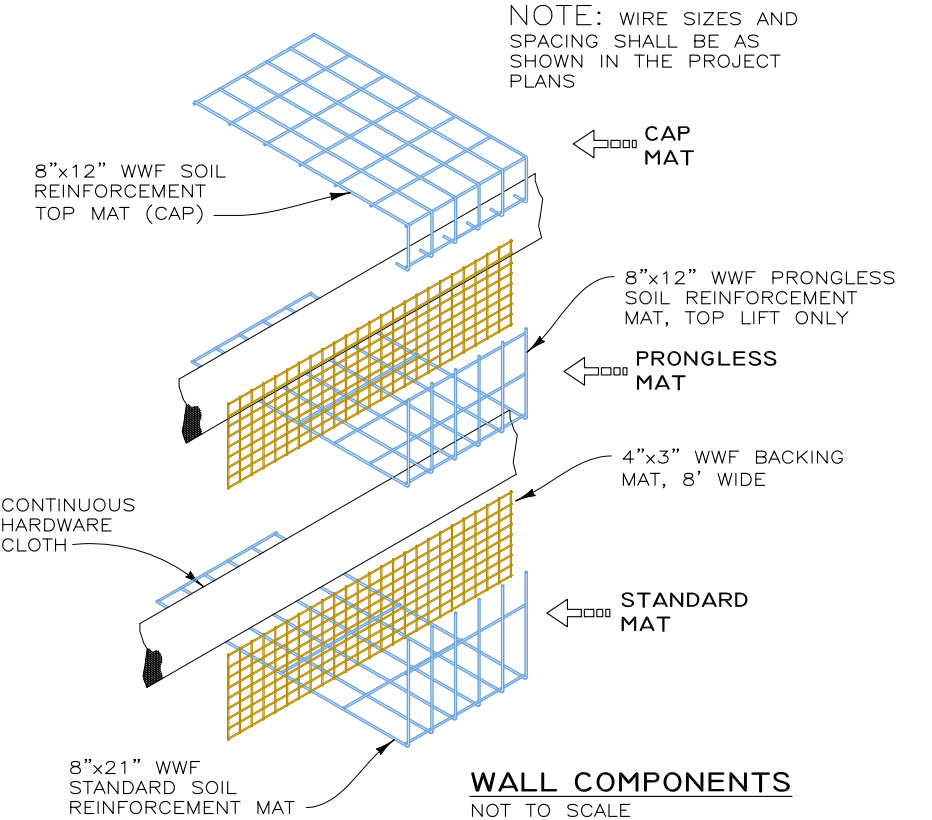

NOTE: WIRE SIZES AND SPACING SHALL BE AS SHOWN IN THE PROJECT PLANS

**PROJECT-SPECIFIC NOTES:**

1. REFERENCE DRAWINGS: BASED ON PROJECT PLANS FOR LANNON STONE PRODUCTS FOR STATIONARY JAW PLANT CRUSHER. PLAN VIEW SKETCH RECEIVED 2 FEBRUARY 2016 AND CRUSHER SECTION DATED 12 AUGUST 2015.
2. IT IS ASSUMED THAT ALL MATERIALS, BACKFILL AND CONSTRUCTION METHODS FOR HILFIKER M.S.E. WALLS AND/OR GABIONS WILL CONFORM TO HILFIKER'S SPECIFICATIONS AND/OR THOSE OF THE HILFIKER ENGINEERING CONSULTANT.
3. THIS IS NOT AN ENGINEERED SUBMITTAL. ALL INFORMATION HEREON IS DERIVED FROM THE REFERENCE DRAWINGS, AND IS SUBJECT TO GEOMETRIC AND GEOTECHNICAL CONFIRMATION. THE APPLICABLE HILFIKER CONSTRUCTION GUIDE AND SPECIFICATIONS ARE AN INTEGRAL PART OF THIS SUBMITTAL.
4. UPON ENGINEERED DESIGN, HILFIKER RETAINING WALLS SHALL BE RESPONSIBLE ONLY FOR THE INTERNAL STABILITY OF THE RETAINING WALL, AND NOT FOR GLOBAL STABILITY OR FOUNDATION BEARING CAPACITY. THE OWNER/CONTRACTOR SHALL BE RESPONSIBLE FOR ALL JOB SITE DRAINAGE, SAFETY AND FALL PROTECTION PROVISIONS FOR WORKERS IN COMPLIANCE WITH OSHA AND ANY OTHER APPLICABLE REQUIREMENTS.
5. M.S.E. WALLS SHALL REQUIRE A NON-SATURATED BACKFILL. SURFACE AND SUBSURFACE DRAINAGE CONTROL MAY BE REQUIRED TO PREVENT SATURATION OF THE BACKFILL OR TO RELIEVE HYDROSTATIC PRESSURES. DRAINAGE CONTROL SHALL BE AS SPECIFIED IN THE OWNER'S PROJECT PLANS AND SPECIFICATIONS, OR AS DIRECTED BY THE OWNER'S ENGINEER.

160202BW LANNON QUARRY STATIONARY JAW PLANT CRUSHER

THIS DRAWING IS FURNISHED SOLELY FOR THE USE OF OR IN CONNECTION WITH THIS PROJECT AND THE PROPRIETARY INFORMATION SHOWN HEREON IS NOT TO BE TRANSMITTED TO ANY OTHER ORGANIZATION WITHOUT SPECIFIC AUTHORIZATION BY THE HILFIKER COMPANY. HILFIKER RETAINING WALLS ARE PROTECTED BY ONE OR MORE OF THE FOLLOWING PATENTS: 243,613; 243,697; 288,616; 4,117,686; 4,329,089; 4,324,508; 4,391,557; 4,505,621; 4,343,318; 4,661,023; 4,856,939; 4,929,125; 5,076,735; 5,647,695; 5,722,799; 5,733,072; 6,357,970B1; 6,874,975B2; 7,033,118B2; AND OTHERS. OTHER PATENTS PENDING (2008)

REV.NO.	DATE	BY	DESCRIPTION

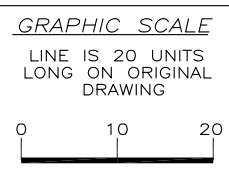

PROJ.MGR. SCB  
ENGINEER  
CADD BY AMJ

**HILFIKER RETAINING WALLS**

1902 HilfiKER Lane  
Eureka, CA 95503-5711  
TOLL-FREE 800.762.8962  
PH 707.443.5093 FAX 707.443.2891  
WEBSITE www.hilfiKER.com E-MAIL info@hilfiKER.com

SINCE 1902 QUALITY PRODUCTS

DWG DATE 8 FEB 16  
REVISION DATE  
SCALE NOTED

**FOR BIDDING PURPOSES ONLY**

WELDED WIRE WALL  
**LANNON QUARRY STATIONARY JAW PLANT CRUSHER**  
LANNON STONE PRODUCTS LANNON, WISCONSIN  
CONSTRUCTION DETAILS AND NOTES

PROJECT NO. 160202BW  
SHEET 3 OF 3