

VICINITY MAP
NOT TO SCALE

KEY PLAN
GRAPHIC SCALE

DESIGN NOTES

1. DESIGN IS BASED ON THE ASSUMPTION THAT BACKFILL WITHIN THE REINFORCED SOIL MASS, METHODS OF CONSTRUCTION AND THE QUALITY OF MATERIALS CONFORM TO THE REQUIREMENTS OF HILFIKER RETAINING WALLS.
2. ASSUMED SOIL CHARACTERISTICS:
 WALL BACKFILL – AGGREGATE (CONTRACTOR TO VERIFY BY TEST):
 TOTAL UNIT WEIGHT: 130 PCF
 INTERNAL FRICTION ANGLE: 34° (ASTM D3080)
 COHESION: 0 PSF
 RETAINED BACKFILL:
 TOTAL UNIT WEIGHT: 120 PCF
 INTERNAL FRICTION ANGLE: 31°
 COHESION: 0 PSF
 FOUNDATION SOILS:
 TOTAL UNIT WEIGHT: 110 PCF
 INTERNAL FRICTION ANGLE: 31°
 COHESION: 0 PSF

 SEISMIC ACCELERATION: 0.085g

 IF ACTUAL CHARACTERISTICS, GRADES OR DIMENSIONS OF SOIL MATERIALS DIFFER FROM THOSE LISTED ABOVE OR SHOWN ON THE PLANS, HILFIKER RETAINING WALLS SHALL BE NOTIFIED TO EVALUATE THE NEED TO REDESIGN.
3. THE DESIGN REQUIRES A NON-SATURATED BACKFILL. SURFACE AND SUB-SURFACE DRAINAGE CONTROL MAY BE REQUIRED TO PREVENT SATURATION OF THE BACKFILL OR RELIEVE HYDROSTATIC PRESSURES.
4. SURFACE AND INTERNAL DRAINAGE CONTROL SHALL BE AS SPECIFIED IN THE PROJECT PLANS AND SPECIFICATIONS OR AS DIRECTED BY THE OWNER'S ENGINEER. PAYMENT FOR DRAINAGE SHALL BE AS SPECIFIED IN THE PROJECT SPECIFICATIONS.
5. SOIL REINFORCEMENTS SHALL BE FABRICATED OF WELDED WIRE FABRIC CONFORMING TO AASHTO M-32 AND M-55 AND SHALL BE GALVANIZED IN ACCORDANCE WITH AASHTO M-111 FOLLOWING FABRICATION.
6. THIS DESIGN SUBMITTAL IS BASED ON ASTM A1115 – STANDARD PRACTICE FOR CONSTRUCTION OF MECHANICALLY STABILIZED EARTH WALLS WITH INEXTENSIBLE SOIL REINFORCEMENT (LATEST APPROVAL).
7. THIS IS A PERMANENT MSE WALL DESIGNED FOR 75 YEARS OF SERVICE. THE OWNER IS ITD. TEMPORARY SHORING AS SHOWN ON THE DRAWINGS IS DESIGNED FOR 1 YEAR OF SERVICE.
8. H-PILES WILL BE DRIVEN THROUGH 30" CMP. CMP WILL BE INSTALLED DURING WALL CONSTRUCTION.
9. STEEL GUARDRAIL POSTS WILL BE DRIVEN THROUGH REINFORCEMENT MATS (BY OTHERS) AS SHOWN ON THE TYPICAL SECTION.
10. SHANNON & WILSON IS NOT THE OWNER'S "ENGINEER OF RECORD" OR THE OWNER'S "GEOTECHNICAL ENGINEER" OR THE OWNER'S "HYDRAULIC ENGINEER," AS DESCRIBED IN ASTM A1115. THE OWNER IS RESPONSIBLE FOR THE FOLLOWING:
 A. EVALUATING GLOBAL STABILITY
 B. ESTABLISHING FOUNDATION BEARING RESISTANCE DESIGN CRITERIA
 C. IMPLEMENTING AN ADEQUATE QUALITY CONTROL PROGRAM
8. HILFIKER RETAINING WALLS, INC (800-762-8962) IS THE "WALL SUPPLIER" WHOSE SYSTEM AND COMPONENTS ARE THE SOLE BASIS OF THIS SUBMITTAL.
9. SHANNON & WILSON (208-658-8700) IS THE "WALL DESIGN ENGINEER," AS DESCRIBED IN ASTM A1115. SHANNON & WILSON HAS SPECIFIED THE TYPE(S), SIZES, AND LOCATIONS OF BURIED REINFORCEMENTS FOR THIS SUBMITTAL.
10. THE ENGINEER OF RECORD ADMINISTERS THE OWNER'S REQUIREMENTS FOR THE LONG-TERM STABILITY OF THE MSE WALL (MSEW), INCLUDING:
 A. FOUNDATION PREPARATION REQUIREMENTS OF THE GEOTECHNICAL ENGINEER
 B. INTERNAL DRAINAGE SYSTEMS AND COMPONENTS TO ENSURE NON-SATURATED BACKFILL.
 C. SCOUR COUNTERMEASURES ALONG THE TOE
 D. EROSION COUNTERMEASURES AT THE ENDS
 E. SURFACE WATER DRAINAGE CONTROLS ABOVE THE WALL
 F. CONSTRUCTION OF THE SUPPLIED MSEW SYSTEM WITH ALL OF ITS APPURTENANT COMPONENTS
 G. PROTECTION OF REINFORCEMENT, SUCH THAT UNAUTHORIZED CUTTING OF WIRES DOES NOT OCCUR
11. HEAVY CRANES OR SIMILAR HEAVY LOADS SHALL NOT BE PLACED WITHIN TWENTY FEET OF THE MSE WALL FACE. DO NOT STOCKPILE SOIL ON THE MSE WALLS.
12. IF THERE ARE BOTTOM OF WALL ELEVATION DISCREPANCIES, NOTIFY OUR OFFICE SO THAT REDESIGN CAN BE CONSIDERED.

2/10/2022 10:46 AM
R:\08456-04 WIR PREPARED 2-10-2022.dwg

THE DESIGN CONTAINED ON THESE DRAWINGS IS BASED ON INFORMATION PROVIDED BY THE OWNER. ON THE BASIS OF THIS INFORMATION, THE HILFIKER COMPANY HAS DESIGNED, AND IS RESPONSIBLE FOR THE INTERNAL STABILITY OF THE STRUCTURE ONLY. EXTERNAL STABILITY, INCLUDING FOUNDATION AND SLOPE STABILITY, IS THE RESPONSIBILITY OF THE OWNER.

REV.	DATE	BY	DESCRIPTION	CADD:
0	1/24/2022	RGV	ISSUED FOR HILFIKER REVIEW	RGV
1	1/27/2022	RGV	ISSUED FOR OWNER REVIEW	DESIGNED: RGV
2	2/10/2022	RGV	ISSUED IN RESPONSE TO COMMENT, ADDED TEMPORARY SHORING	CHECKED: SGC

HILFIKER RETAINING WALLS

1902 Hilfiker Lane
Eureka, CA 95503-5711
TOLL FREE 800.762.8962
PH 707.443.5093 FAX 707.443.2891
WEBSITE www.hilfiker.com E-MAIL info@hilfiker.com

SHANNON & WILSON

5260 Chinden Blvd.
Boise, ID 83714
(208) 658-8700
Fax: (208) 658-8703

VICINITY MAP, NOTES	DWG DATE: 10 FEB 2022
WELDED WIRE WALL US-95, WIR BRIDGE	HRW NO.: 211026BW
ITD	SHEET 1 OF 11
LATAH COUNTY, ID	

PROFESSIONAL ENGINEER
2/10/2022
15993
STATE OF IDAHO
G. VAN LEUVEN

ABUTMENT 1 WW WALL - SUPPLIED QUANTITIES

SUPPLIED REINFORCEMENT QUANTITIES					
BASE LENGTH	CAP MAT W7XW3.5 (8"X12")	PRONGLESS MAT W7XW3.5 (8"X12")	STANDARD MAT W7XW4 (8"X21")	STANDARD MAT W4.5XW4 (8"X21")	INTERMEDIATE MAT W7XW4 (8"X21")
5'	9				
8.75'			3		
10.5'			3	6	
11'	2	2			
12.25'			7	6	
14'			11	6	
15'	6	6			
17.5'			15	6	
19.25'			81	27	
20'	2	11			
21'			19	6	3
22.75'			35	7	8
23'	7	7			

WALL FACE SUPPLIED	4,224 SF
BACKING MATS (2'-0" HIGH)	274 EA
FILTER FABRIC (7'-6" WIDE)	2,192 LF
HOG RINGS	6,400 EA
PLIERS	4 EA

BURY IN PLACE RETURN WALLS A & D - SUPPLIED QUANTITIES

SUPPLIED REINFORCEMENT QUANTITIES				
BASE LENGTH	CAP MAT W4.5XW3.5 (8"X12")	PRONGLESS MAT W4.5XW3.5 (8"X12")	STANDARD MAT W7XW4 (8"X21")	STANDARD MAT W4.5XW4 (8"X21")
21'			11	35
22'	22	22		

WALL FACE SUPPLIED	800 SF
BACKING MATS (2'-0" HIGH)	78 EA
FILTER FABRIC (30" WIDE)	624 LF
HOG RINGS	1,200 EA
PLIERS	2 EA

ABUTMENT 2 WW WALL - SUPPLIED QUANTITIES

SUPPLIED REINFORCEMENT QUANTITIES					
BASE LENGTH	CAP MAT W7XW3.5 (8"X12")	PRONGLESS MAT W7XW3.5 (8"X12")	STANDARD MAT W7XW4 (8"X21")	STANDARD MAT W4.5XW4 (8"X21")	INTERMEDIATE MAT W7XW4 (8"X21")
5'	7				
8.75'			3	28	
10.5'			38	39	
11'	9	9			
12'	3	3			
12.25'			3	3	
14'			16	9	
15'	17	17			
17.5'			15	6	
19.25'			9	3	
20'	3	3			
21'			94	44	19
22'		7			
22.75'			12	3	3
23'	3	3			
25'	2	2			
26'					
26.25'			67	11	22
27'	5	5			

WALL FACE SUPPLIED	7,232 SF
BACKING MATS (2'-0" HIGH)	465 EA
FILTER FABRIC (7'-6" WIDE)	3,720 LF
HOG RINGS	10,900 EA
PLIERS	5 EA

TEMPORARY SHORING REQUIRED FOR BRIDGE STAGING - SUPPLIED QUANTITIES

SUPPLIED REINFORCEMENT QUANTITIES				
BASE LENGTH	CAP MAT W4.5XW3.5 (8"X12")	PRONGLESS MAT W4.5XW3.5 (8"X12")	STANDARD MAT W7XW4 (8"X21")	STANDARD MAT W4.5XW4 (8"X21")
22'	2	2		
21'			8	25
18'	2	2		
17.5'			1	20
15'	2	2		
14'				15
11'	1	1		
10.5'				6
9'	3	3		
8.75'				9

WALL FACE SUPPLIED	1,504 SF
BACKING MATS (2'-0" HIGH)	104 EA
FILTER FABRIC (30" WIDE)	832 LF
HOG RINGS	2,300 EA
PLIERS	2 EA

108456-04 WIR PREPARED 2/10/2022.dwg

2/10/2022 10:46 AM

REV.	DATE	BY	DESCRIPTION	CADD:
0	1/24/2022	RGV	ISSUED FOR HILFIKER REVIEW	RGV
1	1/27/2022	RGV	ISSUED FOR OWNER REVIEW	DESIGNED: RGV
2	2/10/2022	RGV	ISSUED IN RESPONSE TO COMMENT, ADDED TEMPORARY SHORING	CHECKED: SGC

CADD: RGV
DESIGNED: RGV
CHECKED: SGC

HILFIKER RETAINING WALLS

1902 HilfiKER Lane
Eureka, CA 95503-5711
TOLL-FREE 800.762.8962
PH 707.443.5093 FAX 707.443.2891
WEB SITE www.hilfiKER.com EMAIL info@hilfiKER.com

SHANNON & WILSON

5260 Chinden Blvd.
Boise, ID 83714
(208) 658-8700
Fax: (208) 658-8703

SUPPLIED QUANTITIES	
WELDED WIRE WALL	ITD
US-95, WIR BRIDGE	LATAH COUNTY, ID

DWG DATE:	10 FEB 2022
HRW NO.:	211026BW
SHEET	2
OF	11

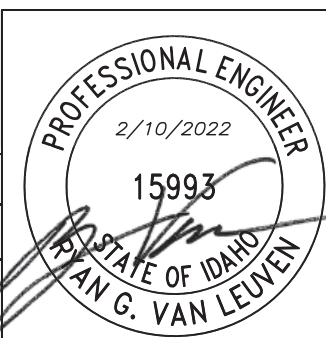

LEGEND

- B1 8"x12", W7xW3.5-HDG (PRONGLESS/CAP MAT)
 - B2 8"x21", W4.5xW4-HDG (STANDARD MAT)
 - B3 8"x21", W7xW4-HDG (STANDARD MAT)
 - B4 8"x21", W7xW4-HDG (INTERMEDIATE MAT)
- LOL LAYOUT LINE
 - H WALL HEIGHT (BOTTOM MAT TO CAP MAT)
 - B MAT LENGTH (FT)
 - WW WELDED WIRE

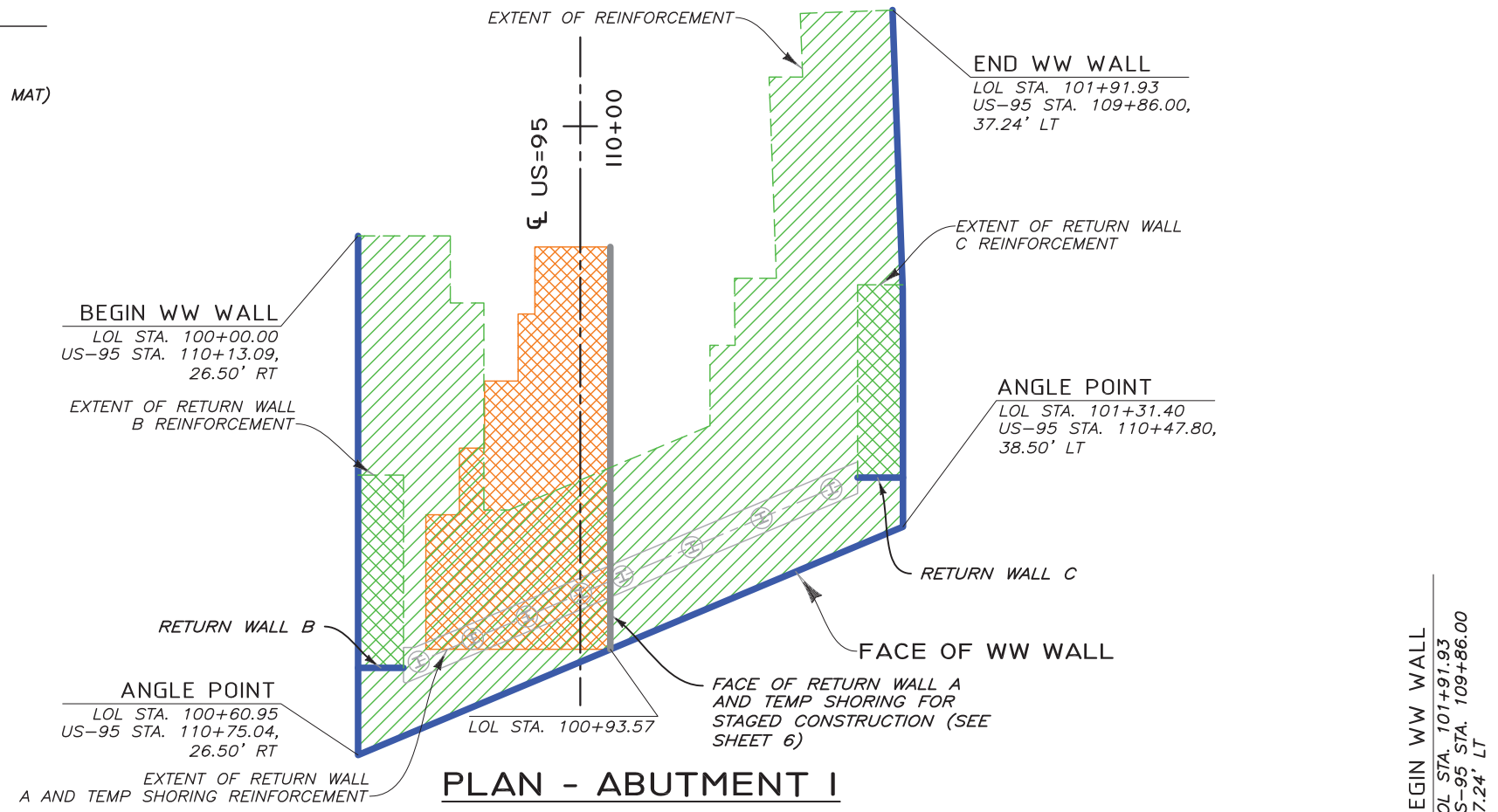
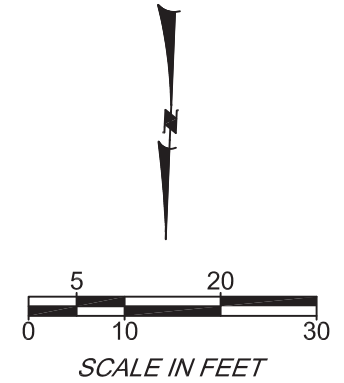

PLAN - ABUTMENT I

GRAPHIC SCALE

H=	6'	12'	16'	20'	24'	28'	32'	26'	32'	28'	24'	20'	16'	12'	6'	=H
B1=	11	15	15	15	20	23	23	CAP (5) PRONGLESS (20)	23	23	20	15	15	15	11	=B1
B2=	8.75	10.5	12.25	14	17.5	21	22.75	19.25	22.75	21	17.5	14	12.25	10.5	8.75	=B2
B3=	8.75	10.5	12.25	14	17.5	21	22.75	19.25	22.75	21	17.5	14	12.25	10.5	-	=B3
B4=	-	-	-	-	-	21	22.75	-	22.75	21	-	-	-	-	-	=B4

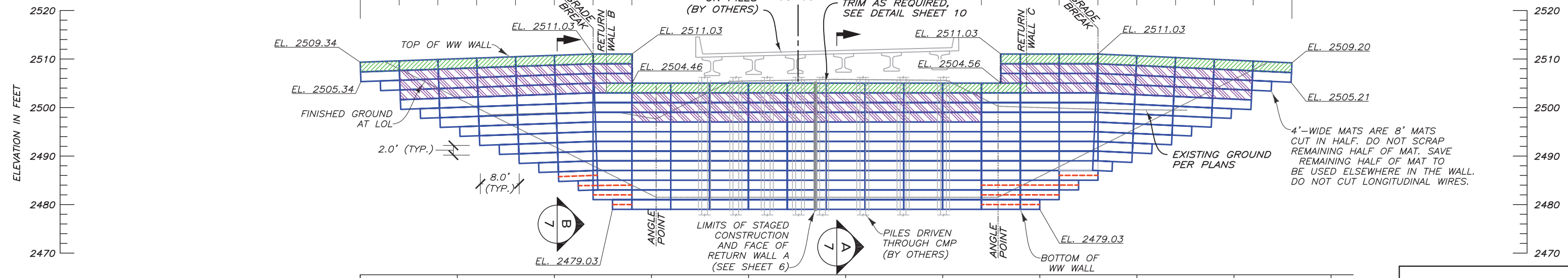

DEVELOPED ELEVATION - ABUTMENT I (FRONT FACE)

GRAPHIC SCALE

2/10/2022 10:46 AM
R:\0456-04\WIR PREPARED 2-10-2022.dwg

REV.	DATE	BY	DESCRIPTION
0	1/24/2022	RGV	ISSUED FOR HILFIKER REVIEW
1	1/27/2022	RGV	ISSUED FOR OWNER REVIEW
2	2/10/2022	RGV	ISSUED IN RESPONSE TO COMMENT, ADDED TEMPORARY SHORING

CADD: RGV
DESIGNED: RGV
CHECKED: SGC

HILFIKER RETAINING WALLS

1902 Hilfiker Lane
Eureka, CA 95503-5711
TOLL FREE 800.762.8962
PH 707.443.5093 FAX 707.443.2891
WEBSITE www.hilfiker.com E-MAIL info@hilfiker.com





SHANNON & WILSON

5260 Chinden Blvd.
Boise, ID 83714
(208) 658-8700
Fax: (208) 658-8703

PLAN & ELEVATION	DWG DATE: 10 FEB 2022
WELDED WIRE WALL	HRW NO.: 211026BW
US-95, WIR BRIDGE	SHEET 3 OF 11
ITD	LATAH COUNTY, ID

PROFESSIONAL ENGINEER
2/10/2022
15993
AN G. VAN LEUVEN

LEGEND

-  B1 8"x12", W7xW3.5-HDG (PRONGLESS/CAP MAT)
 -  B2 8"x21", W4.5xW4-HDG (STANDARD MAT)
 -  B3 8"x21", W7xW4-HDG (STANDARD MAT)
 -  B4 8"x21", W7xW4-HDG (INTERMEDIATE MAT)
- LOL LAYOUT LINE
 - H WALL HEIGHT (BOTTOM MAT TO CAP MAT)
 - B MAT LENGTH (FT)
 - WW WELDED WIRE

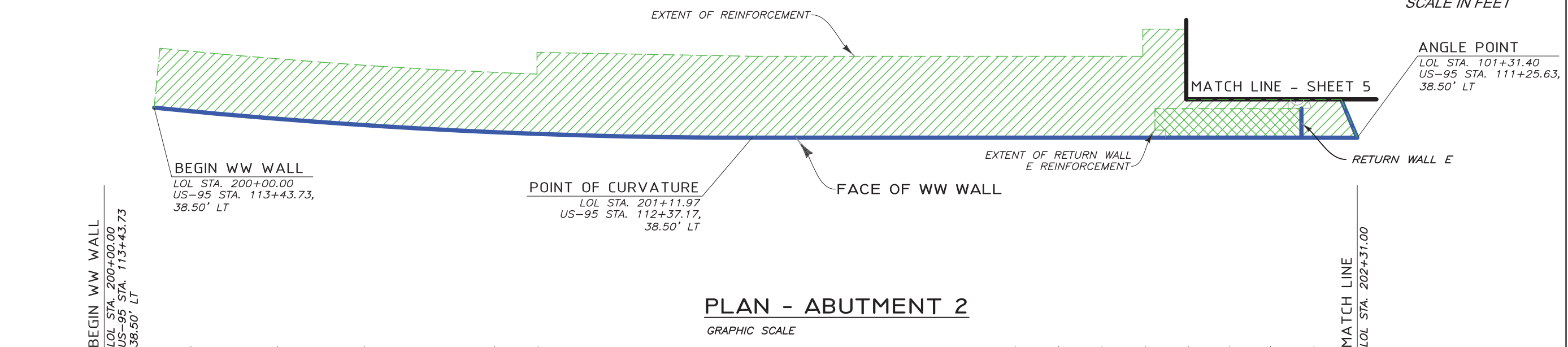
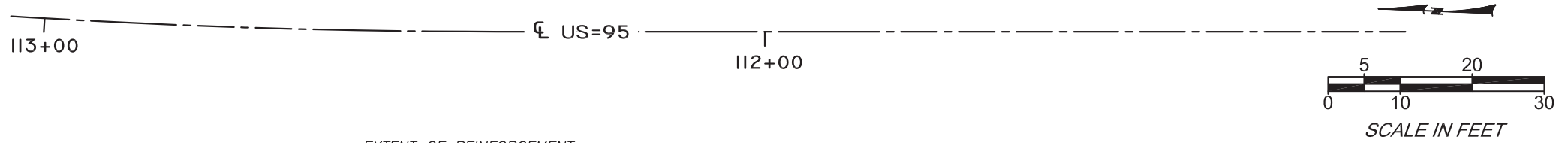

PLAN - ABUTMENT 2

GRAPHIC SCALE

H=	4'	6'	8'	10'	12'	14'	16'	20'	24'	26'	30'	34'	36'	30'	=H
B1=	11	11	11	12	15	15	15	15	20	20	23	25	27	23	=B1
B2=	8.75	8.75	8.75	8.75	10.5	10.5	12.25	14	17.5	19.25	21	26.25	26.25	21	=B2
B3=	-	-	-	8.75	10.5	10.5	12.25	14	17.5	19.25	21	26.25	26.25	21	=B3
B4=	-	-	-	-	-	-	-	-	-	-	21	26.25	26.25	21	=B4

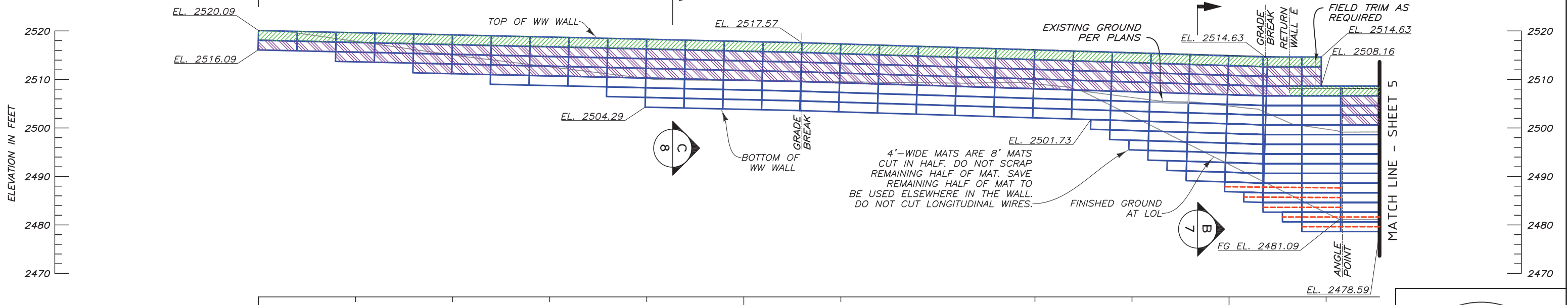

DEVELOPED ELEVATION - ABUTMENT 2 (FRONT FACE)

GRAPHIC SCALE

REV.	DATE	BY	DESCRIPTION	CADD:
0	1/24/2022	RGV	ISSUED FOR HILFIKER REVIEW	RGV
1	1/27/2022	RGV	ISSUED FOR OWNER REVIEW	DESIGNED: RGV
2	2/10/2022	RGV	ISSUED IN RESPONSE TO COMMENT, ADDED TEMPORARY SHORING	CHECKED: SGC

HILFIKER RETAINING WALLS



1902 Hilfiker Lane
Eureka, CA 95503-5711
TOLL-FREE 800.762.8962
PH 707.443.5093 FAX 707.443.2891
WEB SITE www.hilfiker.com EMAIL info@hilfiker.com

SHANNON & WILSON

5260 Chinden Blvd.
Boise, ID 83714
(208) 658-8700
Fax: (208) 658-8703

PLAN & ELEVATION	DWG DATE: 10 FEB 2022
WELDED WIRE WALL	HRW NO.: 211026BW
US-95, WIR BRIDGE	SHEET 4 OF 11
ITD	LATAH COUNTY, ID

PROFESSIONAL ENGINEER
2/10/2022
15993
STATE OF IDAHO
JAN G. VAN LEUVEN

2/10/2022 10:46 AM 108456-04 WIR PREPARED 2, 10-2022.dwg

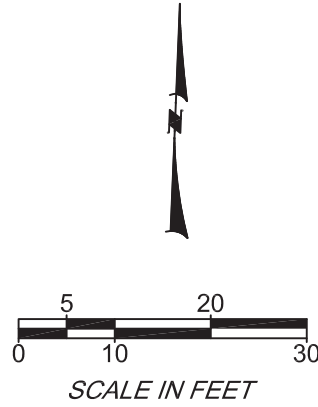

LEGEND

	B1	8"x12", W7xW3.5-HDG (PRONGLESS/CAP MAT)	LOL	LAYOUT LINE
	B2	8"x21", W4.5xW4-HDG (STANDARD MAT)	H	WALL HEIGHT (BOTTOM MAT TO CAP MAT)
	B3	8"x21", W7xW4-HDG (STANDARD MAT)	B	MAT LENGTH (FT)
	B4	8"x21", W7xW4-HDG (INTERMEDIATE MAT)	WW	WELDED WIRE

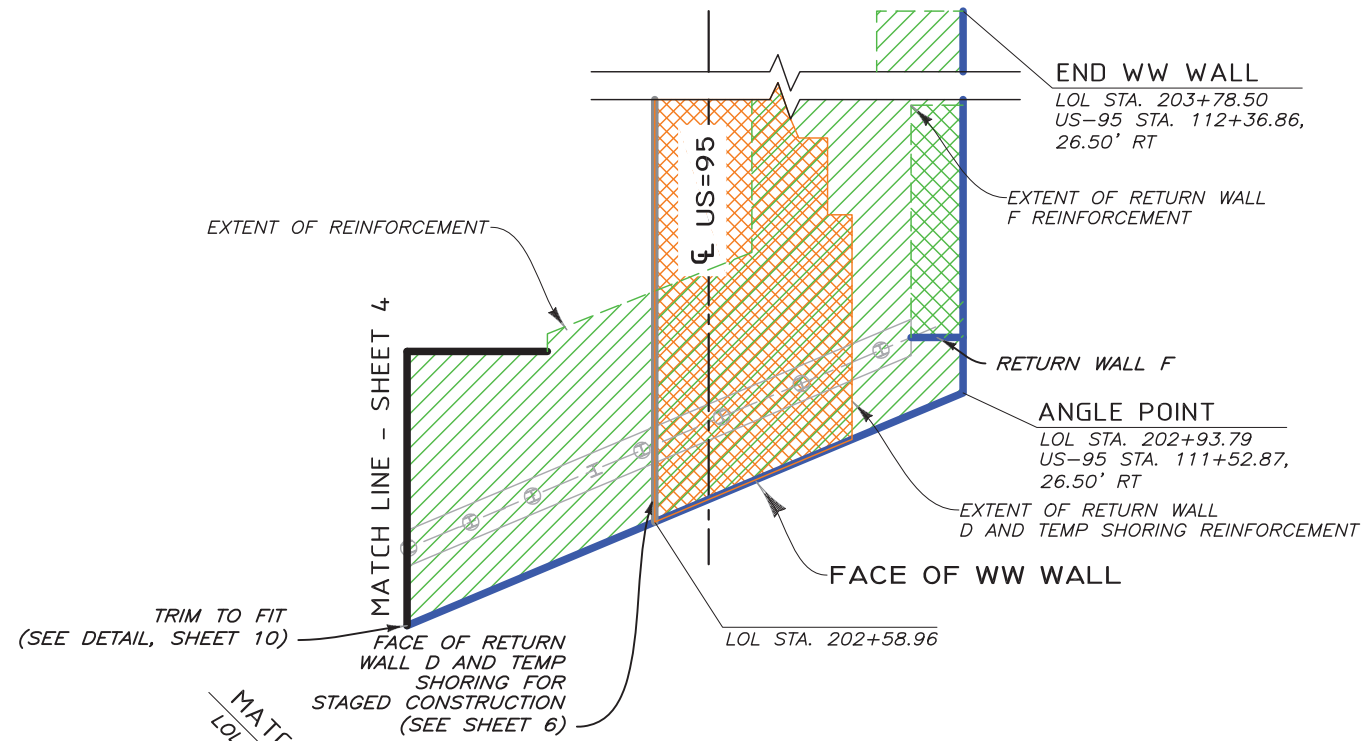

PLAN - ABUTMENT 2

GRAPHIC SCALE

H=	30'	36'	34'	32'	28'	24'	20'	18'	14'	10'	8'	4'	=H
B1=	CAP (5) PRONGLESS (22)	27	25	23	23	20	15	15	15	11	11	11	=B1
B2=	21	26.25	26.25	22.75	21	17.5	14	14	10.5	8.75	8.75	8.75	=B2
B3=	21	26.25	26.25	22.75	21	17.5	14	14	10.5	-	-	-	=B3
B4=	21	26.25	26.25	22.75	21	-	-	-	-	-	-	-	=B4

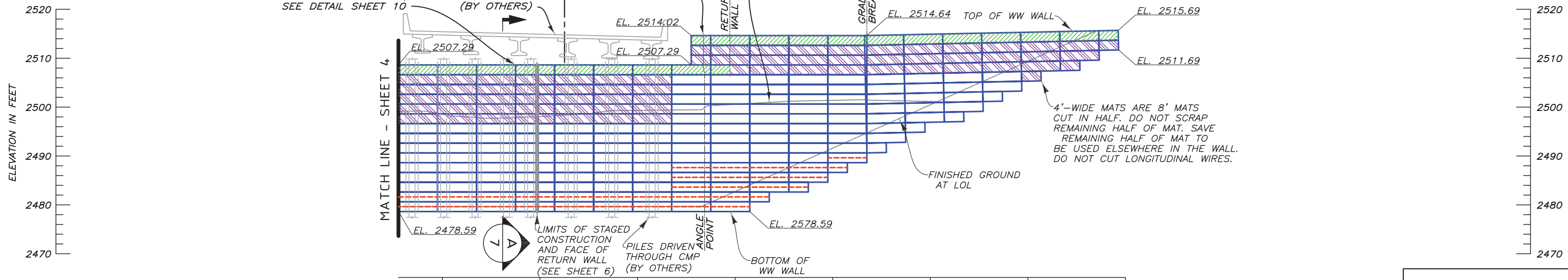

DEVELOPED ELEVATION - ABUTMENT 2 (FRONT FACE)

GRAPHIC SCALE

THE DESIGN CONTAINED ON THESE DRAWINGS IS BASED ON INFORMATION PROVIDED BY THE OWNER. ON THE BASIS OF THIS INFORMATION, THE HILFIKER COMPANY HAS DESIGNED, AND IS RESPONSIBLE FOR THE INTERNAL STABILITY OF THE STRUCTURE ONLY. EXTERNAL STABILITY, INCLUDING FOUNDATION AND SLOPE STABILITY, IS THE RESPONSIBILITY OF THE OWNER.

REV.	DATE	BY	DESCRIPTION	CADD:
0	1/24/2022	RGV	ISSUED FOR HILFIKER REVIEW	RGV
1	1/27/2022	RGV	ISSUED FOR OWNER REVIEW	DESIGNED: RGV
2	2/10/2022	RGV	ISSUED IN RESPONSE TO COMMENT, ADDED TEMPORARY SHORING	CHECKED: SGC

HILFIKER RETAINING WALLS

1902 HilfiKER Lane
Eureka, CA 95503-5711
TOLL-FREE 800.762.8962
PH 707.443.5093 FAX 707.443.2891
WEB SITE www.hilfiKER.com E-MAIL info@hilfiKER.com

SHANNON & WILSON

5260 Chinden Blvd.
Boise, ID 83714
(208) 658-8700
Fax: (208) 658-8703

PLAN & ELEVATION	DWG DATE: 10 FEB 2022
WELDED WIRE WALL	HRW NO.: 211026BW
US-95, WIR BRIDGE	SHEET 5
ITD	LATAH COUNTY, ID

OF 11

PROFESSIONAL ENGINEER
2/10/2022
15993
RYAN G. VAN LEUVEN
STATE OF IDAHO

2/10/2022 10:46 AM J:\08455-04 WIR PREPARED 2_10_2022.dwg

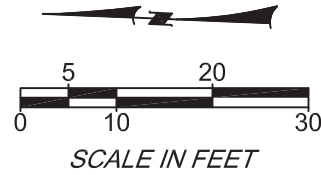

RED OUTLINE INDICATES EXTENTS OF TEMPORARY SHORING ADDED BY CONTRACTOR REQUIRED FOR BRIDGE STAGING

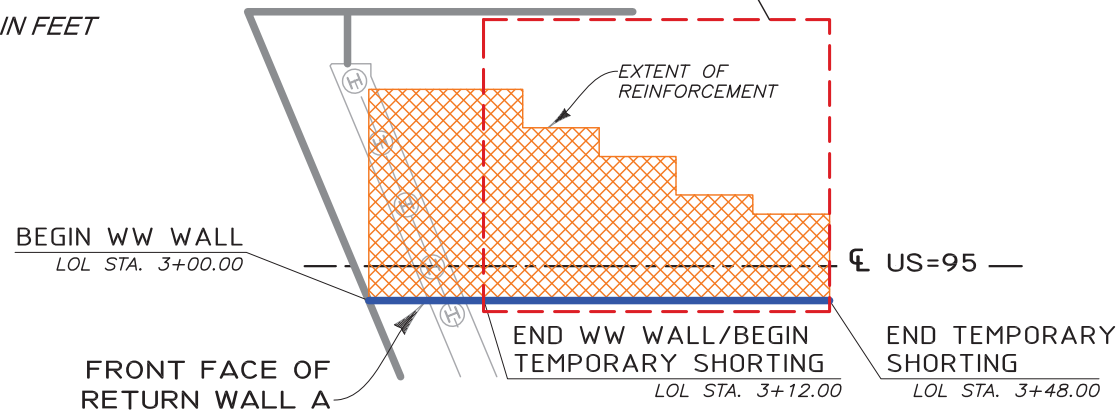

PLAN - RETURN WALL A AT ABUTMENT 1
GRAPHIC SCALE

FACE OF RETURN WALL D

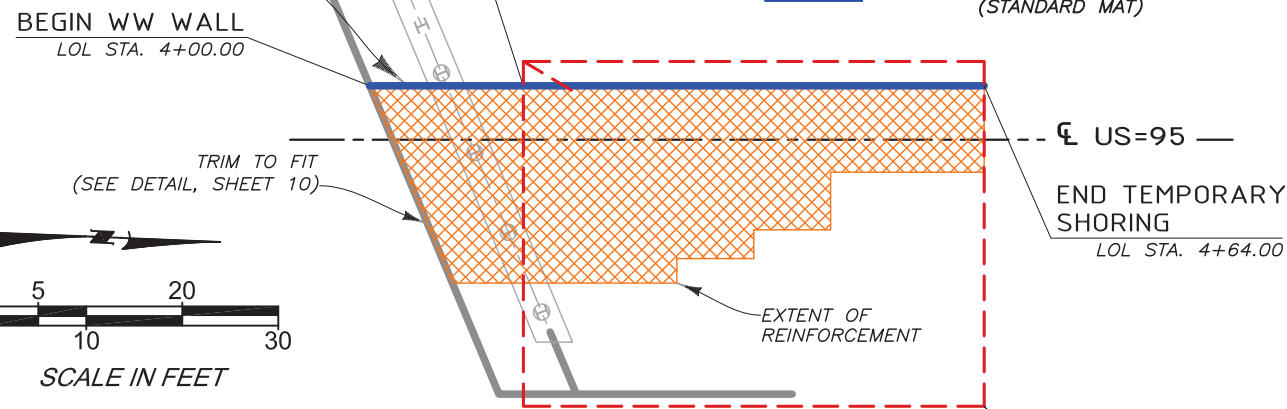
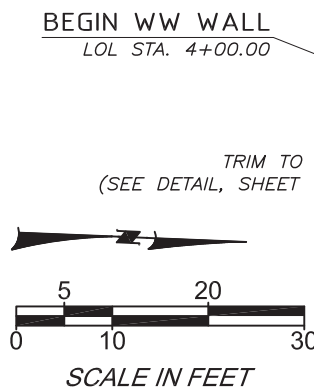

PLAN - RETURN WALL D AT ABUTMENT 2
GRAPHIC SCALE

LEGEND

	B1	8"x12", W4.5xW3.5-B (PRONGLESS/CAP MAT)	LOL	LAYOUT LINE
	B2	8"x21", W4.5xW4-B (STANDARD MAT)	H	WALL HEIGHT (BOTTOM MAT TO CAP MAT)
	B3	8"x21", W7xW4-B (STANDARD MAT)	B	MAT LENGTH
			WW	WELDED WIRE

	BEGIN WW WALL LOL STA. 3+00.00	END WW WALL/BEGIN TEMP SHORING LOL STA. 3+12.00	TEMP SHORING AS REQUIRED FOR BRIDGE STAGING (LOL STA 3+12 3+48)				END TEMP SHORING LOL STA. 3+48.00
H=	26'	26'	24'	18'	14'	8'	
B1=	22	22	18	15	11	9	
B2=	21	21	17.5	14	10.5	8.75	
B3=	21	21	17.5	-	-	-	

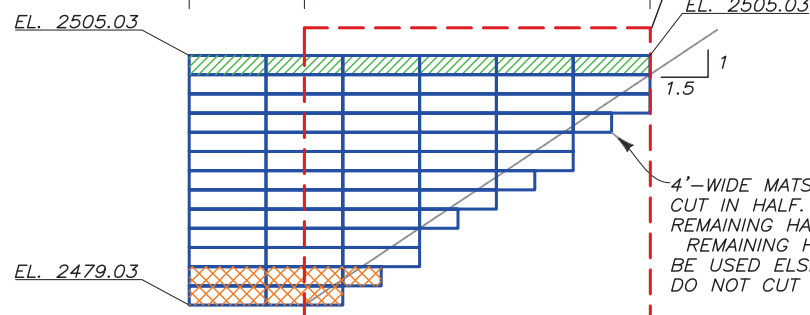

DEVELOPED ELEVATION - RETURN WALL A AT ABUTMENT 1 (FRONT FACE)
GRAPHIC SCALE

	BEGIN WW WALL LOL STA. 4+00.00	END WW WALL/BEGIN TEMP SHORING LOL STA. 4+16.00	TEMP SHORING AS REQUIRED FOR BRIDGE STAGING (LOL STA 4+16 4+64)					END TEMP SHORING LOL STA. 4+64.00
H=	30'	30'	28'	24'	18'	12'	8'	
B1=	22	22	22	18	15	9	9	
B2=	21	21	21	17.5	14	8.75	8.75	
B3=	21	21	21	17.5	-	-	-	

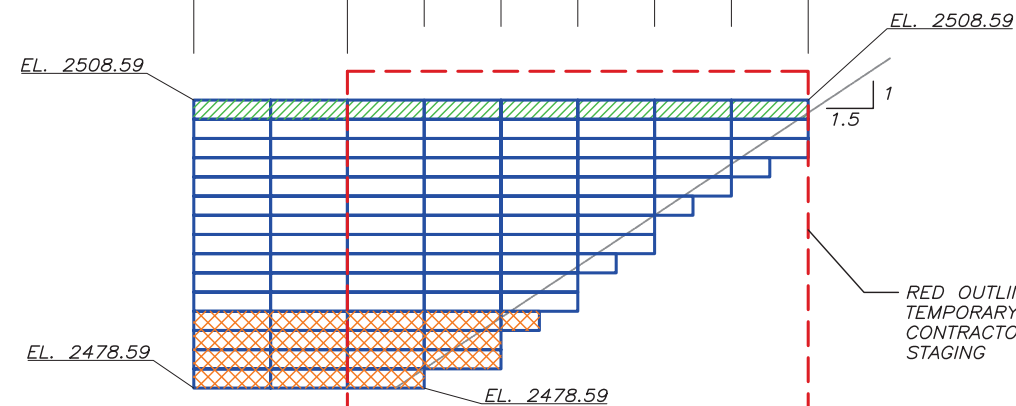

DEVELOPED ELEVATION - RETURN WALL D AT ABUTMENT 2 (BACK FACE)
GRAPHIC SCALE

2/10/2022 10:46 AM 108456-04 WIR PREPARED 2-10-2022.dwg

REV.	DATE	BY	DESCRIPTION
0	1/24/2022	RGV	ISSUED FOR HILFIKER REVIEW
1	1/27/2022	RGV	ISSUED FOR OWNER REVIEW
2	2/10/2022	RGV	ISSUED IN RESPONSE TO COMMENT, ADDED TEMPORARY SHORING

HILFIKER RETAINING WALLS

1902 Hilfiker Lane
Eureka, CA 95503-5711
TOLL FREE 800.762.8962
PH 707.443.5093 FAX 707.443.2891
WEBSITE www.hilfiker.com E-MAIL info@hilfiker.com

SHANNON & WILSON

5260 Chinden Blvd.
Boise, ID 83714
(208) 658-8700
Fax: (208) 658-8703

PLAN & ELEVATION	DWG DATE: 10 FEB 2022
WELDED WIRE WALL	HRW NO.: 211026BW
US-95, WIR BRIDGE	SHEET 6 OF 11
ITD	LATAH COUNTY, ID



108456-04 WIR PREPARED 2/10/2022.dwg

2/10/2022 10:46 AM

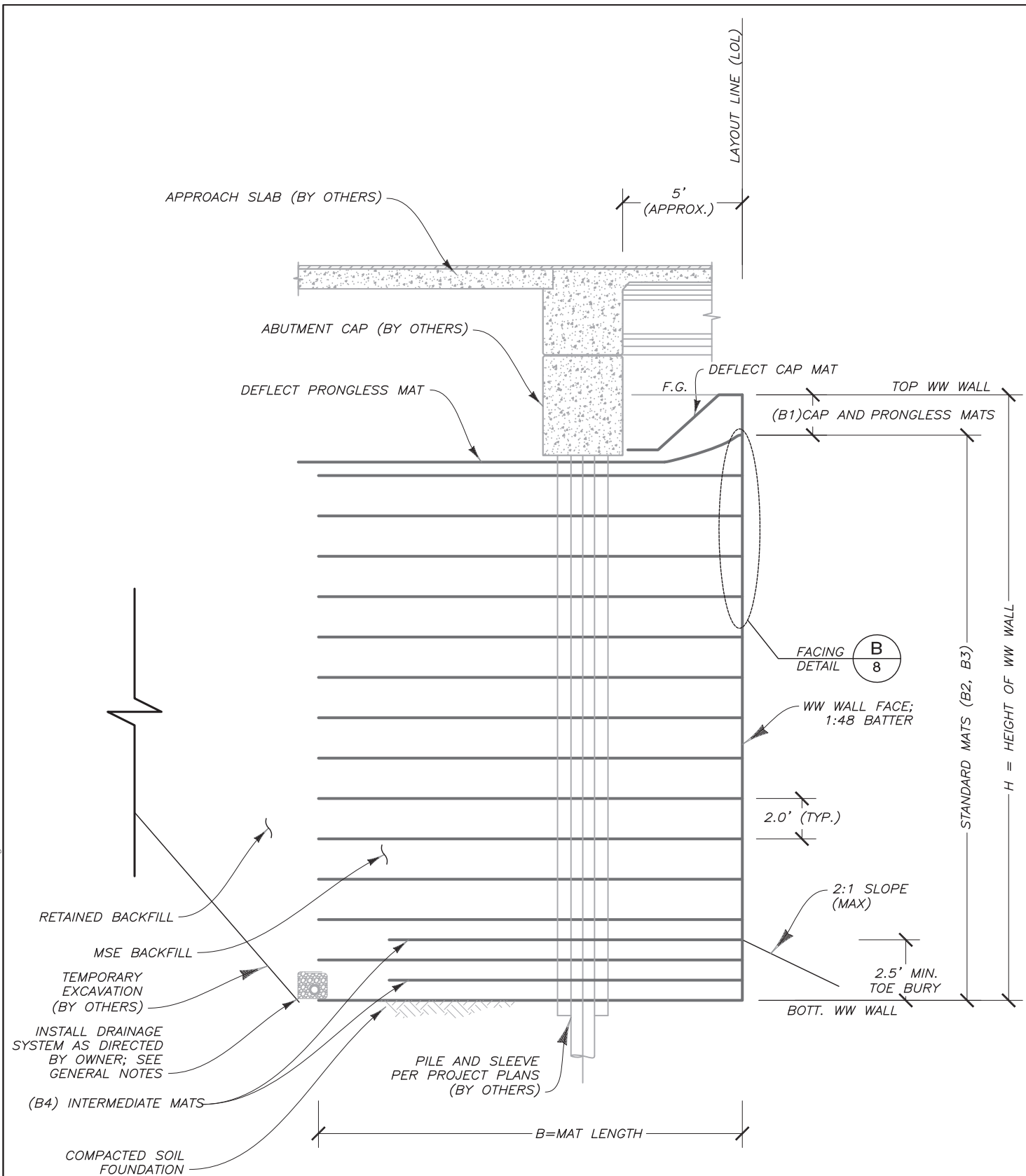

TYPICAL SECTION A
NOT TO SCALE

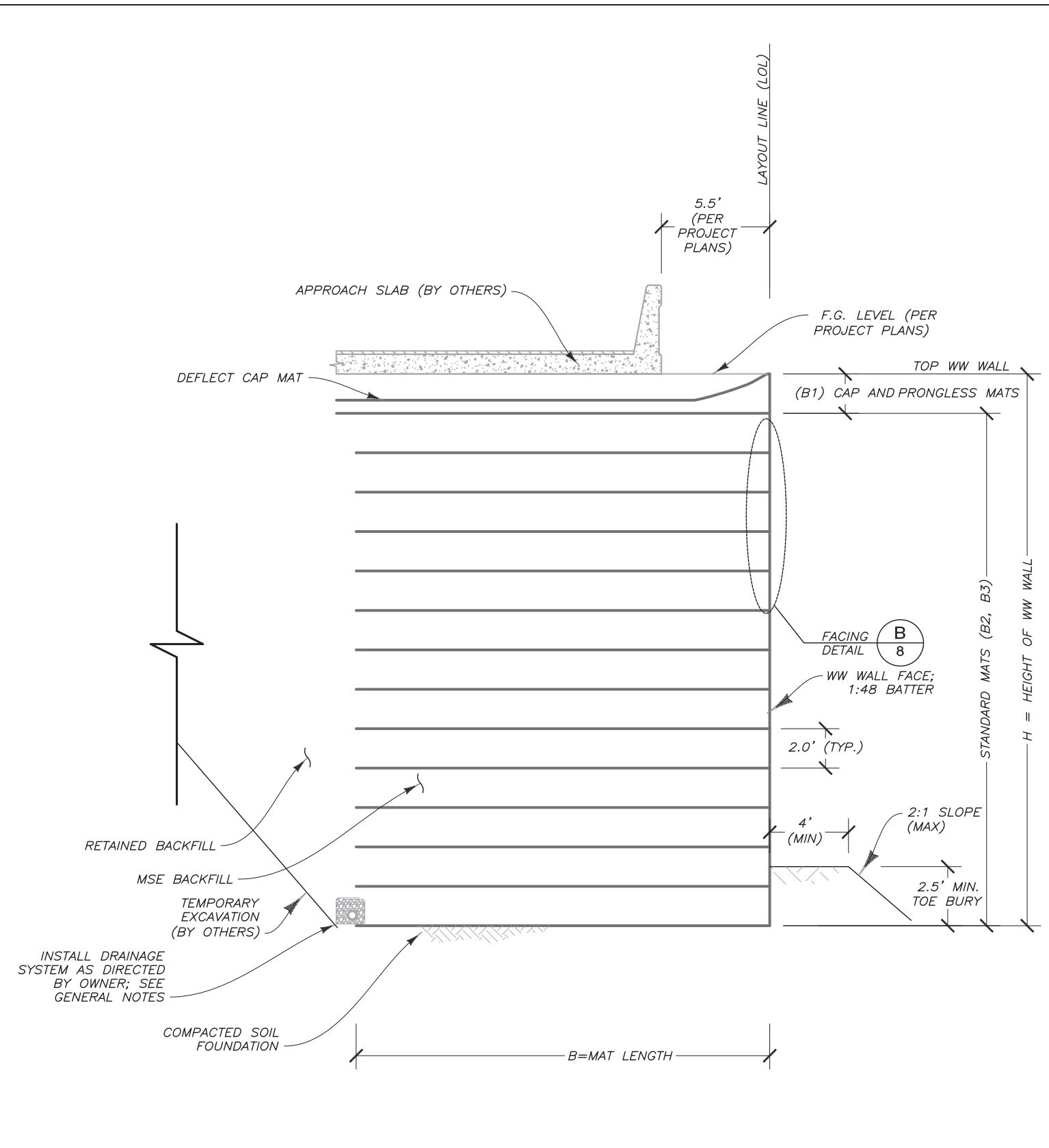

TYPICAL SECTION B
NOT TO SCALE

THE DESIGN CONTAINED ON THESE DRAWINGS IS BASED ON INFORMATION PROVIDED BY THE OWNER. ON THE BASIS OF THIS INFORMATION, THE HILFIKER COMPANY HAS DESIGNED, AND IS RESPONSIBLE FOR THE INTERNAL STABILITY OF THE STRUCTURE ONLY. EXTERNAL STABILITY, INCLUDING FOUNDATION AND SLOPE STABILITY, IS THE RESPONSIBILITY OF THE OWNER.

REV.	DATE	BY	DESCRIPTION	CADD:
0	1/24/2022	RGV	ISSUED FOR HILFIKER REVIEW	RGV
1	1/27/2022	RGV	ISSUED FOR OWNER REVIEW	DESIGNED: RGV
2	2/10/2022	RGV	ISSUED IN RESPONSE TO COMMENT, ADDED TEMPORARY SHORING	CHECKED: SGC

HILFIKER RETAINING WALLS

HW

1902 Hilfiiker Lane
Eureka, CA 95503-5711
TOLL-FREE 800.762.8962
PH 707.443.5093 FAX 707.443.2891
WEB SITE www.hilfiiker.com E-MAIL info@hilfiiker.com

1902

5260 Chinden Blvd.
Boise, ID 83714
(208) 658-8700
Fax: (208) 658-8703

SECTIONS	
ITD	LATAH COUNTY, ID

DWG DATE:	10 FEB 2022
HRW NO.:	211026BW
SHEET	7
OF	11

PROFESSIONAL ENGINEER

2/10/2022

15993

STATE OF IDAHO

RYAN G. VAN LEUVEN

108456-04 WIR PREPARED 2/10/2022.dwg

2/10/2022 10:46 AM

RVL/LL/AVN

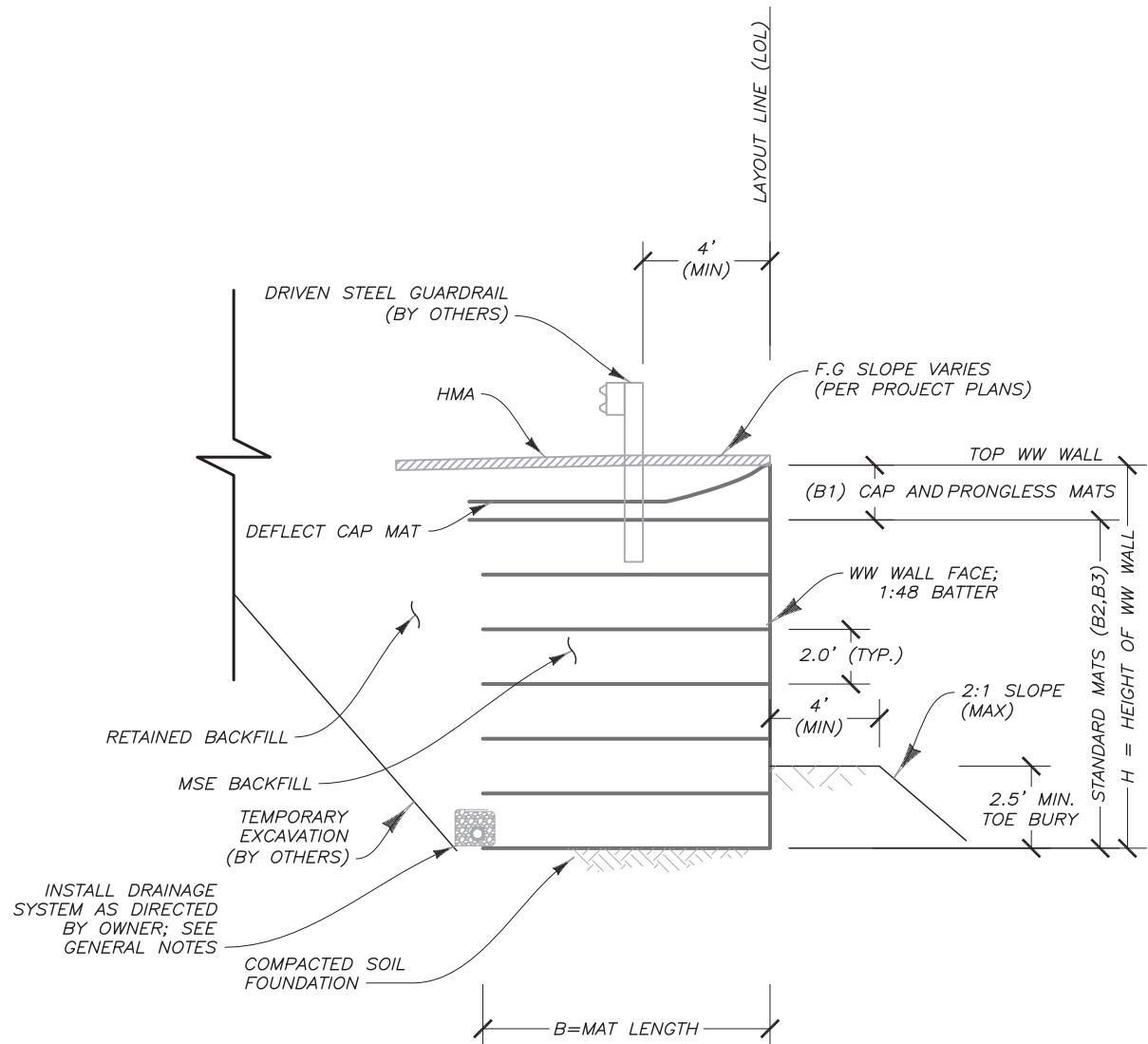

TYPICAL SECTION C
4
NOT TO SCALE

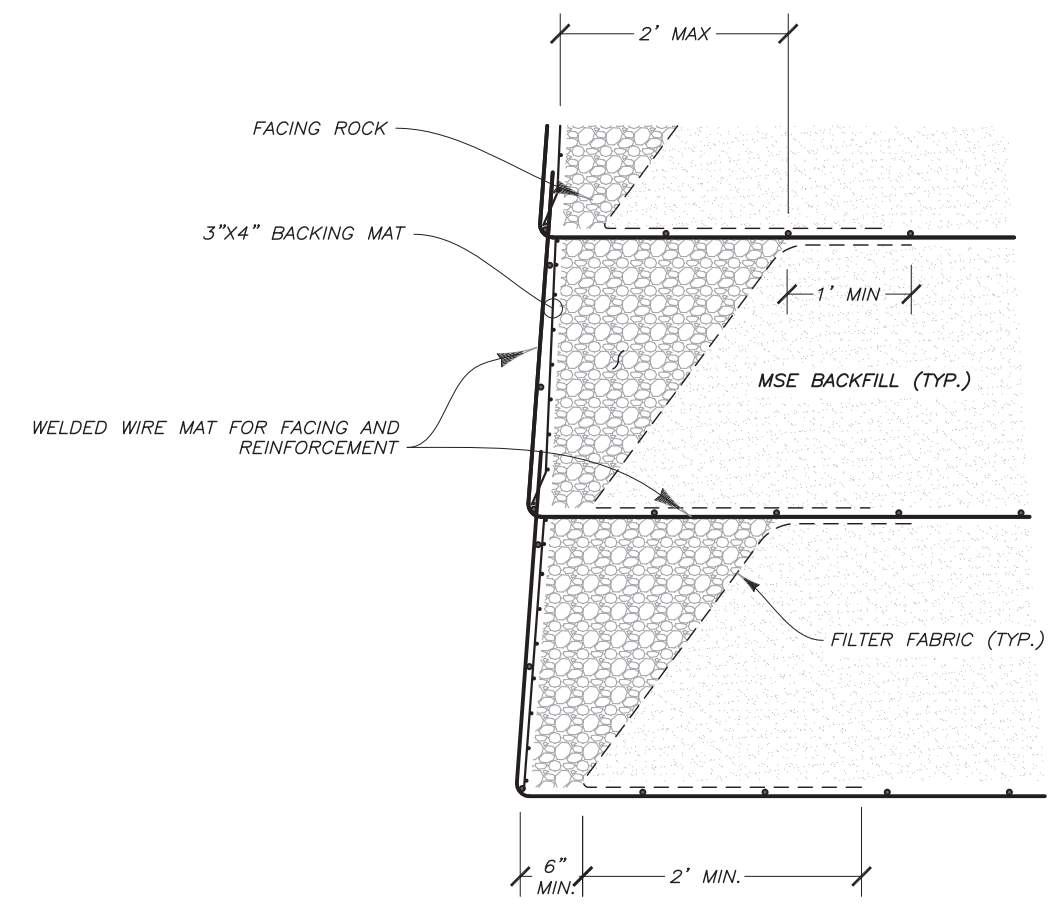

FACING DETAIL B
7
NOT TO SCALE

REV.	DATE	BY	DESCRIPTION	CADD:
0	1/24/2022	RGV	ISSUED FOR HILFIKER REVIEW	RGV
1	1/27/2022	RGV	ISSUED FOR OWNER REVIEW	DESIGNED: RGV
2	2/10/2022	RGV	ISSUED IN RESPONSE TO COMMENT, ADDED TEMPORARY SHORING	CHECKED: SGC

HILFIKER RETAINING WALLS

1902 HilfiKER Lane
Eureka, CA 95503-5711
TOLL-FREE 800.762.8962
PH 707.443.5093 FAX 707.443.2891
WEB SITE www.hilfiKER.com E-MAIL info@hilfiKER.com

SHANNON & WILSON

5260 Chinden Blvd.
Boise, ID 83714
(208) 658-8700
Fax: (208) 658-8703

SECTION & DETAILS	DWG DATE: 10 FEB 2022
WELDED WIRE WALL	HRW NO.:
US-95, WIR BRIDGE	211026BW
ITD	SHEET 8
LATAH COUNTY, ID	OF 11

PROFESSIONAL ENGINEER
2/10/2022
15993
RYAN G. VAN LEUVEN
STATE OF IDAHO

THE DESIGN CONTAINED ON THESE DRAWINGS IS BASED ON INFORMATION PROVIDED BY THE OWNER. ON THE BASIS OF THIS INFORMATION, THE HILFIKER COMPANY HAS DESIGNED, AND IS RESPONSIBLE FOR THE INTERNAL STABILITY OF THE STRUCTURE ONLY. EXTERNAL STABILITY, INCLUDING FOUNDATION AND SLOPE STABILITY, IS THE RESPONSIBILITY OF THE OWNER.

STEP 1

PLACE THE FIRST COURSE OF SOIL REINFORCEMENT MATS ON PREPARED FOUNDATION



STEP 2

PLACE THE BACKING MAT AGAINST THE INSIDE FACE OF THE SOIL REINFORCEMENT MAT. CLIP THE SECOND-TO-TOP TRANSVERSE WIRE ON THE BACKING MAT TO THE TOP TRANSVERSE WIRE ON THE SOIL REINFORCEMENT MAT.

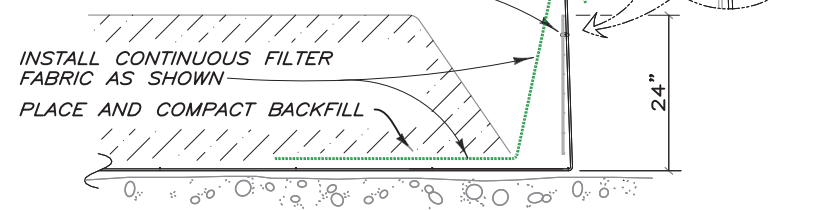

STEP 3

BRING THE FILTER FABRIC OVER THE FRONT AND TOP OF THE BACKFILL AS SHOWN. PLACE THE ROCK IN THE FACE OF THE WALL. LEAVE A VOID AS SHOWN.

PLACE THE SECOND COURSE OF SOIL REINFORCEMENT MATS WITH THE BASE LONGITUDINAL WIRES RESTING ON THE TOP TRANSVERSE WIRE OF THE BACKING MAT BELOW. SLIDE THE SOIL REINFORCEMENT MAT INTO ALIGNMENT.

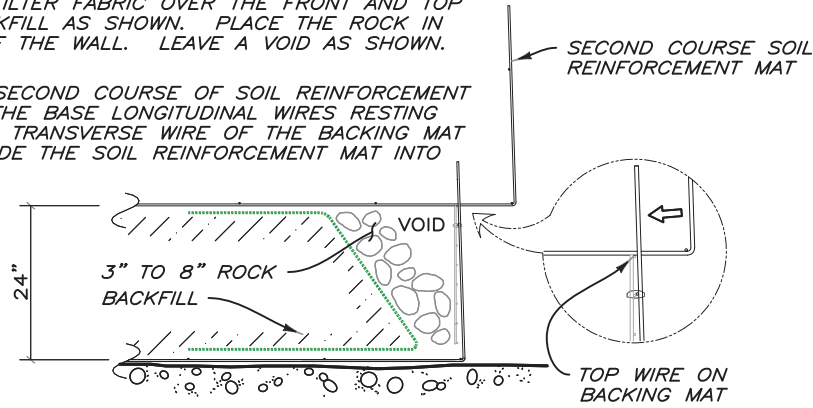

STEP 4

HOOK THE BOTTOM TRANSVERSE WIRE OF THE BACKING MAT OVER THE VERTICAL PRONGS ON THE LOWER MAT. ROTATE THE BACKING MAT TO VERTICAL AND CLIP THE SECOND-TO-TOP TRANSVERSE WIRE ON THE BACKING MAT TO THE TOP WIRE ON THE SOIL REINFORCEMENT MAT.

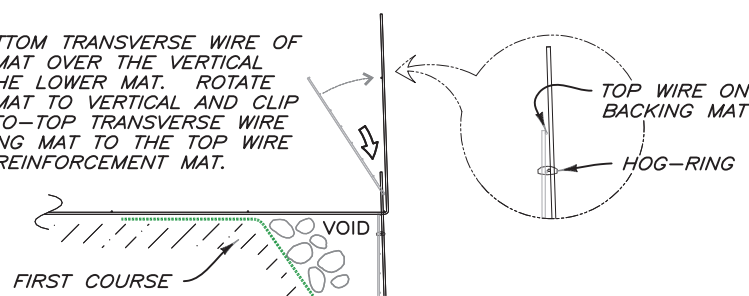

STEP 5

INSTALL THE FILTER FABRIC AS IN STEPS 2 AND 3. PLACE AND COMPACT THE BACKFILL AND ROCK TO THE BASE ELEVATION OF THE NEXT MAT. REPEAT STEPS 2 THROUGH 5 TO THE TOP LIFT.

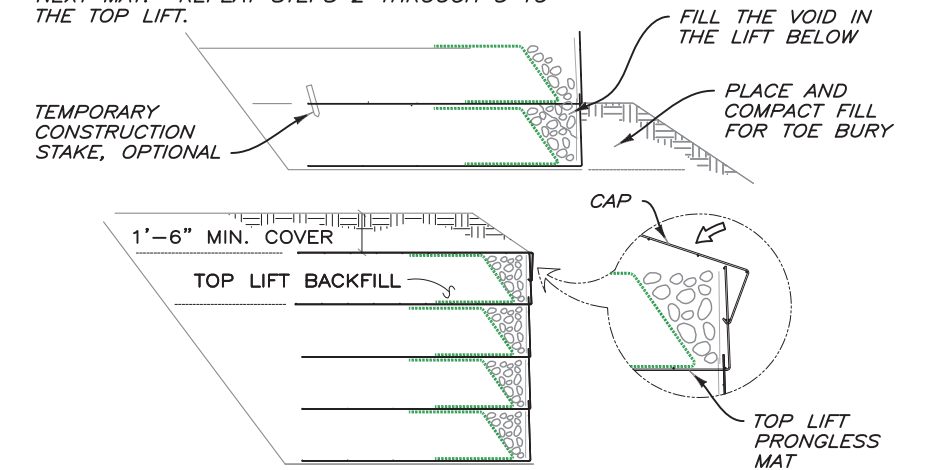

STEP 6: TOP LIFT

PLACE THE TOP LIFT PRONGLESS MAT, BACKING MAT AND FILTER FABRIC. PLACE AND COMPACT BACKFILL AND ROCK IN THE TOP LIFT. HOOK THE CAP OVER THE MIDDLE TRANSVERSE WIRE ON THE PRONGLESS MAT, AND ROTATE INTO PLACE. PLACE AND COMPACT COVER OVER TOP MAT TO 1'-6" MINIMUM DEPTH.

CONSTRUCTION SEQUENCE (ROCK FACE)

NOT TO SCALE

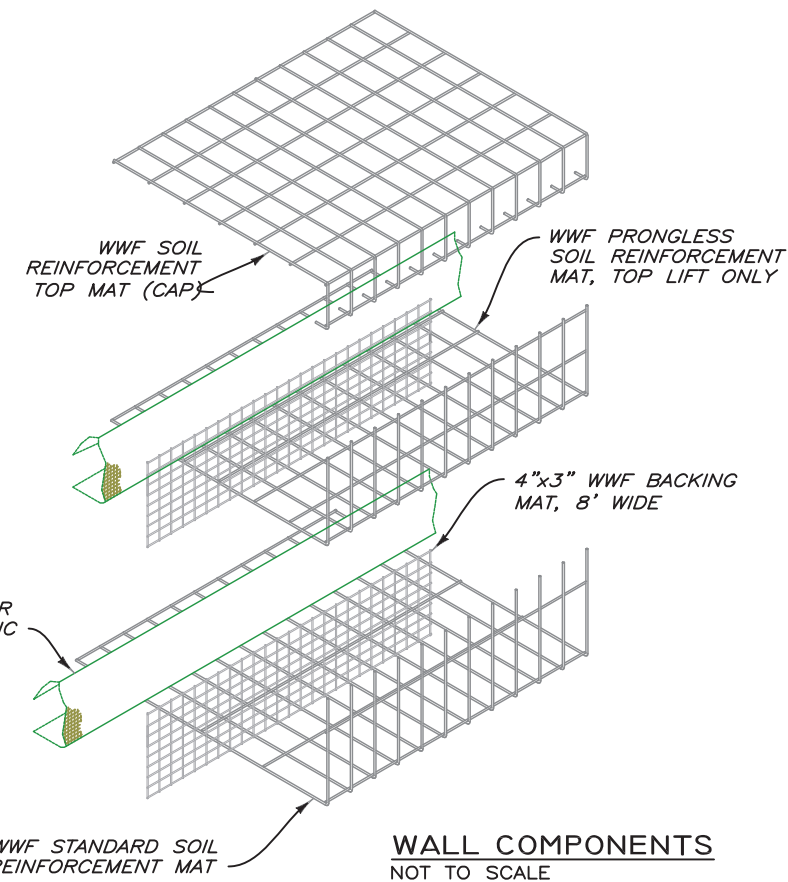

WALL COMPONENTS
NOT TO SCALE

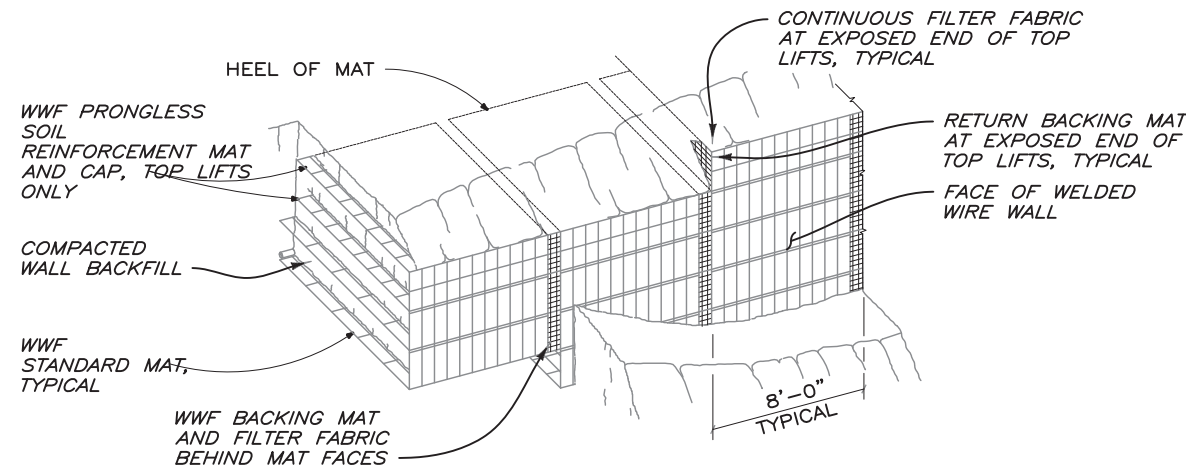

PICTORIAL ELEVATION
NOT TO SCALE

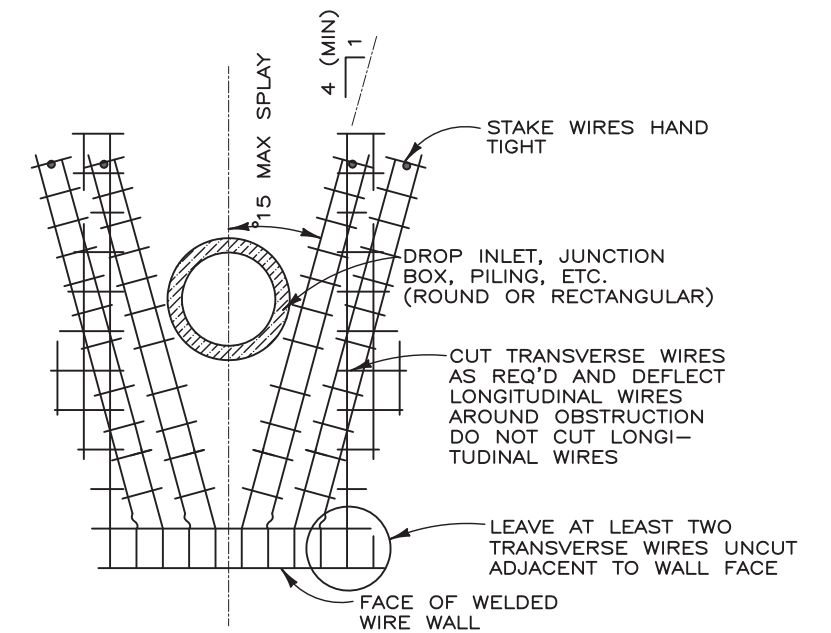

PLAN VIEW
MAT PENETRATION DETAIL
NOT TO SCALE

108455-04 WWR PREPARED 2/10/2022.dwg

2/10/2022 10:46 AM

THE DESIGN CONTAINED ON THESE DRAWINGS IS BASED ON INFORMATION PROVIDED BY THE OWNER. ON THE BASIS OF THIS INFORMATION, THE HILFIKER COMPANY HAS DESIGNED, AND IS RESPONSIBLE FOR THE INTERNAL STABILITY OF THE STRUCTURE ONLY. EXTERNAL STABILITY, INCLUDING FOUNDATION AND SLOPE STABILITY, IS THE RESPONSIBILITY OF THE OWNER.

REV.	DATE	BY	DESCRIPTION	CADD:
0	1/24/2022	RGV	ISSUED FOR HILFIKER REVIEW	RGV
1	1/27/2022	RGV	ISSUED FOR OWNER REVIEW	DESIGNED: RGV
2	2/10/2022	RGV	ISSUED IN RESPONSE TO COMMENT, ADDED TEMPORARY SHORING	CHECKED: SGC

HILFIKER RETAINING WALLS

1902 HilfiKER Lane
Eureka, CA 95503-5711
TOLL-FREE 800.762.8962
PH 707.443.5093 FAX 707.443.2891
WEB SITE www.hilfiKER.com EMAIL info@hilfiKER.com

SHANNON & WILSON

5260 Chinden Blvd.
Boise, ID 83714
(208) 658-8700
Fax: (208) 658-8703

SEQUENCE & DETAILS	DWG DATE: 10 FEB 2022
WELDED WIRE WALL	HRW NO.: 211026BW
US-95, WIR BRIDGE	SHEET 9 OF 11
ITD	LATAH COUNTY, ID

PROFESSIONAL ENGINEER

2/10/2022

15993

STATE OF IDAHO

MAN G. VAN LEUVEN

108456-04 WWR PREPARED 2/10/2022.dwg
2/10/2022 10:46 AM
RVL/CL/AVT

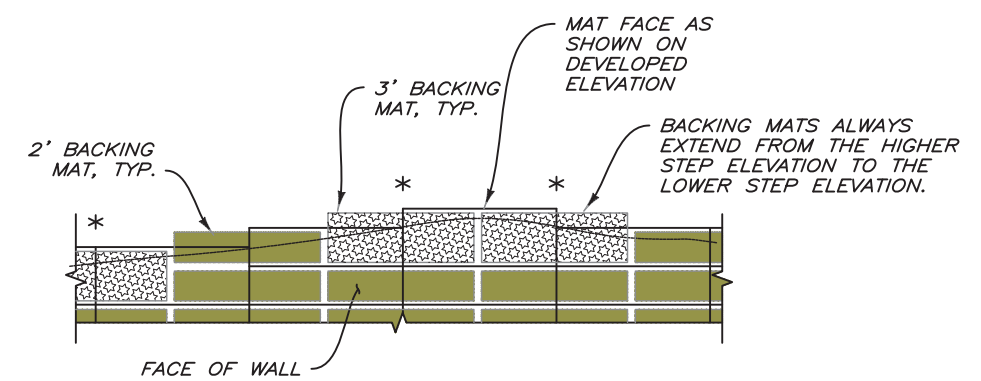
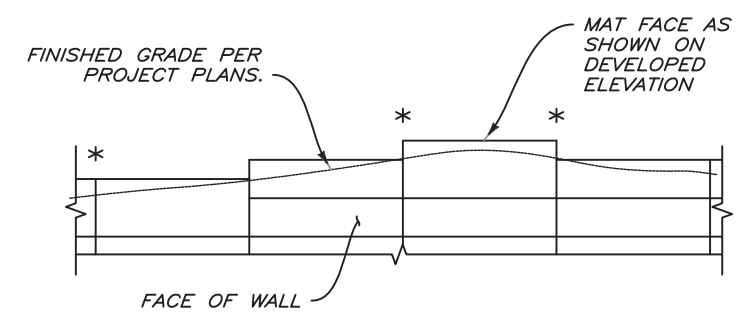
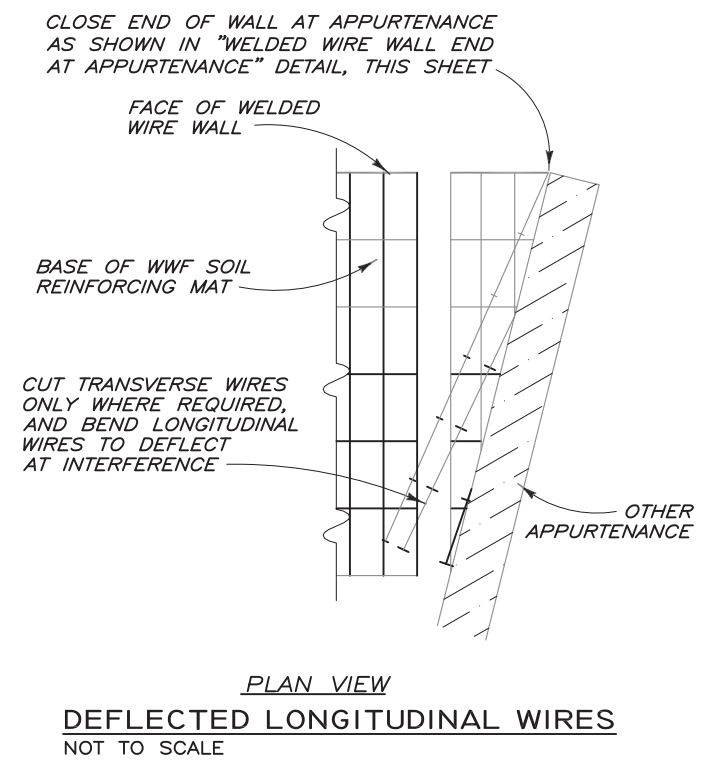
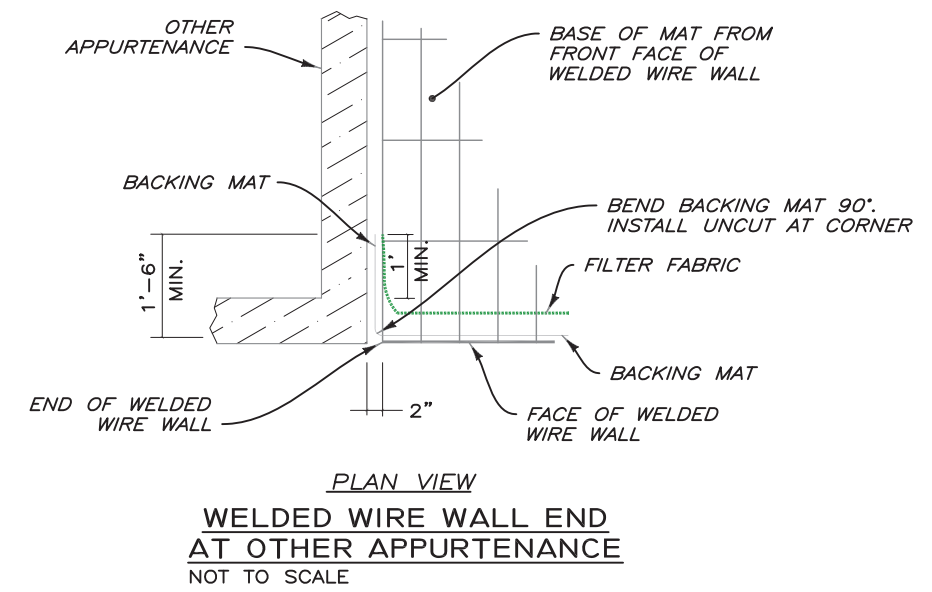
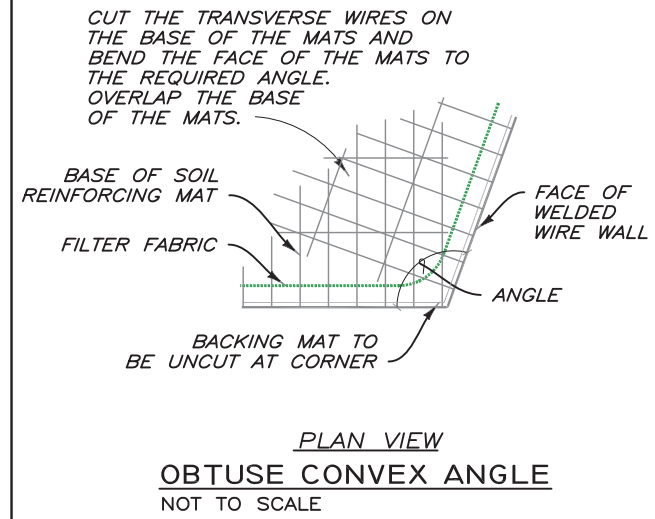

**TRIMMING BACKING MATS ALONG TOP OF WALL
NOT TO SCALE**

REV.	DATE	BY	DESCRIPTION	CADD:
0	1/24/2022	RGV	ISSUED FOR HILFIKER REVIEW	RGV
1	1/27/2022	RGV	ISSUED FOR OWNER REVIEW	DESIGNED: RGV
2	2/10/2022	RGV	ISSUED IN RESPONSE TO COMMENT, ADDED TEMPORARY SHORING	CHECKED: SGC

HILFIKER RETAINING WALLS

1902 Hilfiker Lane
Eureka, CA 95503-5711
TOLL-FREE 800.762.8962
PH 707.443.5093 FAX 707.443.2891
WEB SITE www.hilfiker.com E-MAIL info@hilfiker.com

SHANNON & WILSON

5260 Chinden Blvd.
Boise, ID 83714
(208) 658-8700
Fax: (208) 658-8703

DETAILS	
WELDED WIRE WALL	DWG DATE: 10 FEB 2022
US-95, WIR BRIDGE	HRW NO.: 211026BW
ITD	SHEET 10 OF 11
LATAH COUNTY, ID	

PROFESSIONAL ENGINEER

2/10/2022

15993

IAN G. VAN LEUVEN

THE DESIGN CONTAINED ON THESE DRAWINGS IS BASED ON INFORMATION PROVIDED BY THE OWNER. ON THE BASIS OF THIS INFORMATION, THE HILFIKER COMPANY HAS DESIGNED, AND IS RESPONSIBLE FOR THE INTERNAL STABILITY OF THE STRUCTURE ONLY. EXTERNAL STABILITY, INCLUDING FOUNDATION AND SLOPE STABILITY, IS THE RESPONSIBILITY OF THE OWNER.

STEP 1

PLACE THE FIRST COURSE OF SOIL REINFORCEMENT MATS ON PREPARED FOUNDATION

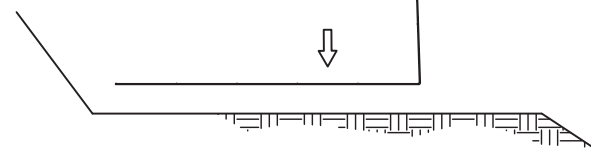

STEP 2

PLACE THE BACKING MAT AGAINST THE INSIDE FACE OF THE SOIL REINFORCEMENT MAT. CLIP THE SECOND-TO-TOP TRANSVERSE WIRE ON THE BACKING MAT TO THE TOP TRANSVERSE WIRE ON THE SOIL REINFORCEMENT MAT

INSTALL CONTINUOUS FACING FABRIC, HOG-RING TO THE TOP WIRE ON THE BACKING MAT

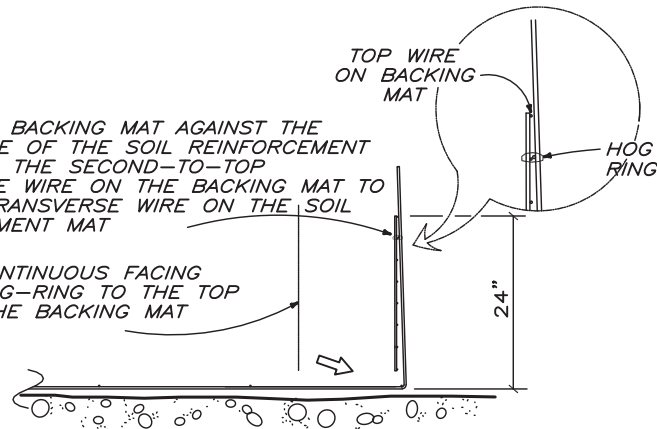

PLACE AND COMPACT THE BACKFILL IN LAYERS AND DENSITIES AS SPECIFIED IN THE PROJECT PLANS. LEAVE A VOID AT THE FACE AS SHOWN.

PLACE THE SECOND COURSE OF SOIL REINFORCEMENT MATS WITH THE BASE LONGITUDINAL WIRES RESTING ON THE TOP TRANSVERSE WIRE OF THE BACKING MAT BELOW. SLIDE THE SOIL REINFORCEMENT MAT INTO ALIGNMENT

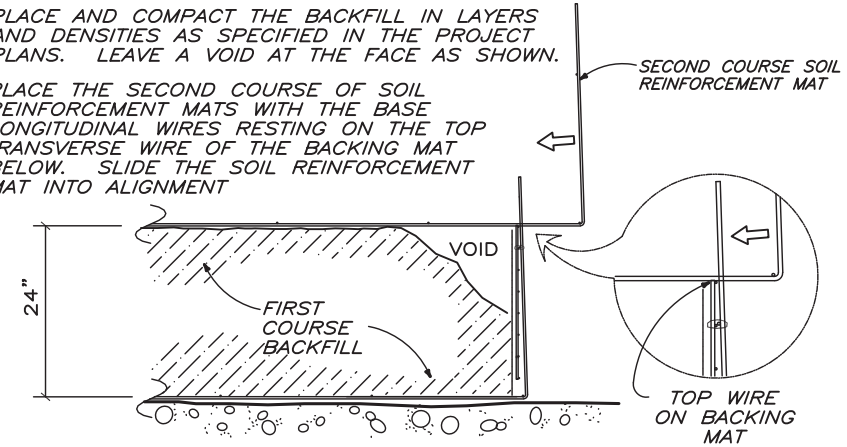

STEP 4

HOOK THE BOTTOM TRANSVERSE WIRE OF THE BACKING MAT OVER THE VERTICAL PRONGS ON THE LOWER MAT. ROTATE THE BACKING MAT TO VERTICAL AND CLIP THE SECOND-TO-TOP TRANSVERSE WIRE ON THE BACKING MAT TO THE TOP WIRE ON THE SOIL REINFORCEMENT MAT.

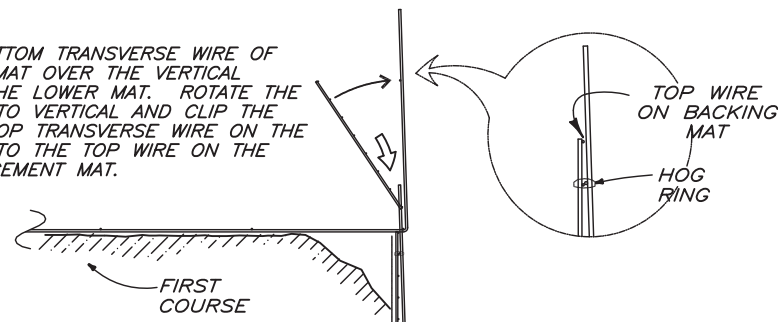

STEP 5

INSTALL THE FILTER FABRIC. PLACE AND COMPACT THE BACKFILL TO THE BASE ELEVATION OF THE NEXT MAT. REPEAT STEPS 3 THRU 5 TO THE TOP LIFT.

TEMPORARY CONSTRUCTION STAKE, OPTIONAL

FILL AND COMPACT VOID AT WALL FACE

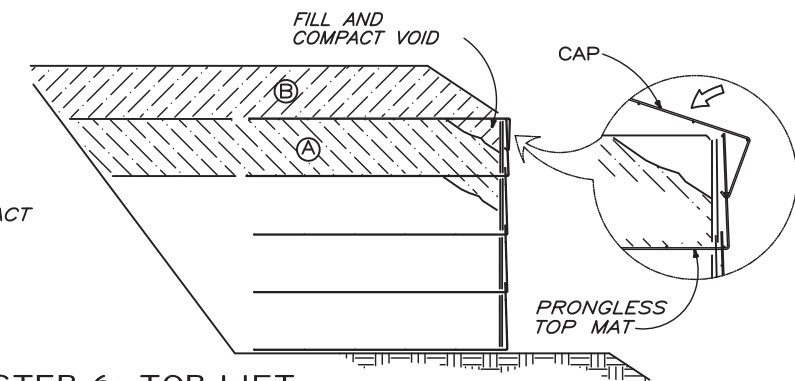
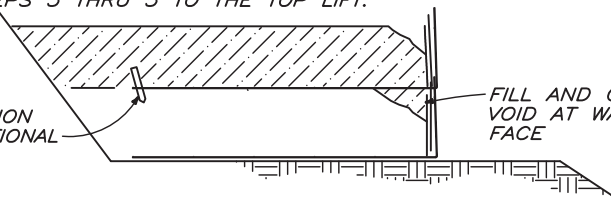

STEP 6: TOP LIFT

PLACE THE TOP LIFT PRONGLESS MAT, BACKING MAT AND MIRAMESH OR FILTER FABRIC.

PLACE AND COMPACT BACKFILL IN AREA "A"

HOOK THE CAP OVER THE MIDDLE TRANSVERSE WIRE ON THE PRONGLESS MAT, AND ROTATE INTO PLACE

BACKFILL "B" TO 1'-6" MINIMUM COVER OVER THE CAP.

CONSTRUCTION SEQUENCE (RETURN WALLS A & D)
NOT TO SCALE

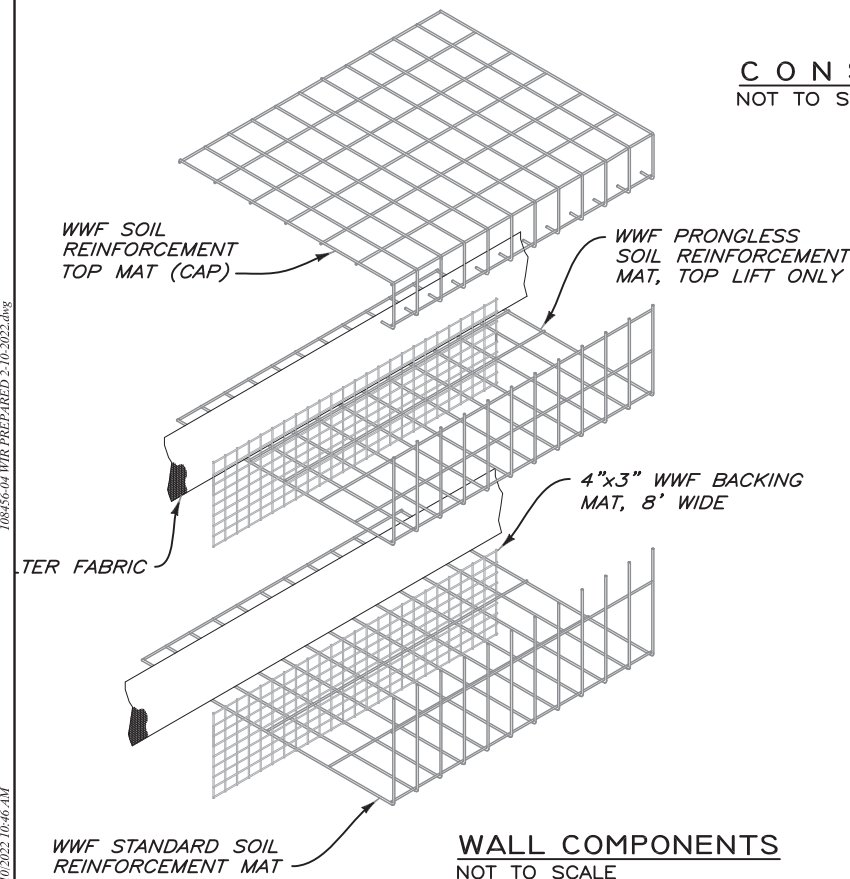

WALL COMPONENTS
NOT TO SCALE

REV.	DATE	BY	DESCRIPTION	CADD:
0	1/24/2022	RGV	ISSUED FOR HILFIKER REVIEW	RGV
1	1/27/2022	RGV	ISSUED FOR OWNER REVIEW	DESIGNED: RGV
2	2/10/2022	RGV	ISSUED IN RESPONSE TO COMMENT, ADDED TEMPORARY SHORING	CHECKED: SGC

HILFIKER RETAINING WALLS

1902 HilfiKER Lane
Eureka, CA 95503-5711
TOLL-FREE 800.762.8962
PH 707.443.5093 FAX 707.443.2891
WEB SITE www.hilfiKER.com E-MAIL info@hilfiKER.com

SHANNON & WILSON

5260 Chinden Blvd.
Boise, ID 83714
(208) 658-8700
Fax: (208) 658-8703

SEQUENCE & DETAILS

WELDED WIRE WALL
US-95, WIR BRIDGE

ITD LATAH COUNTY, ID

DWG DATE:	10 FEB 2022
HRW NO.:	211026BW
SHEET	11
OF	11

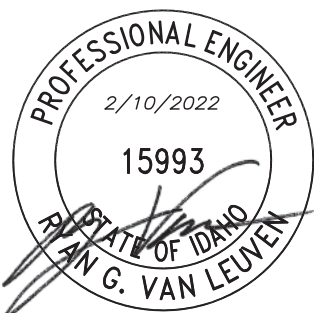

2/10/2022 10:46 AM 108456-04 WIR PREPARED 2, 10, 2022.dwg